

March 10th & 11th 2018

SA Open

Racquetball Championships

*Player Information Booklet
& Entry Form*





Campbelltown Aquatic & Recreation Centre



The ARC is delighted to be hosting the Sth Australian Racquetball Championships for 2018. This is the second time the state championships have been played at this new centre which was completed in 2016 at a cost of \$26m.

The ARC Campbelltown is a brand-new community leisure hub boasting an impressive range of contemporary sport, fitness, relaxation and function and event facilities in fresh and bright surrounds.

The Campbelltown Leisure Centre boasts spacious change rooms, 5 squash courts with moveable walls, café, clubrooms and a crèche. There is also a gym with weights room, aerobics and dance facilities, and a sauna. The Leisure Centre was completed with a 25 metre lap and splash pool, with furnishings and a dedicated plant room.

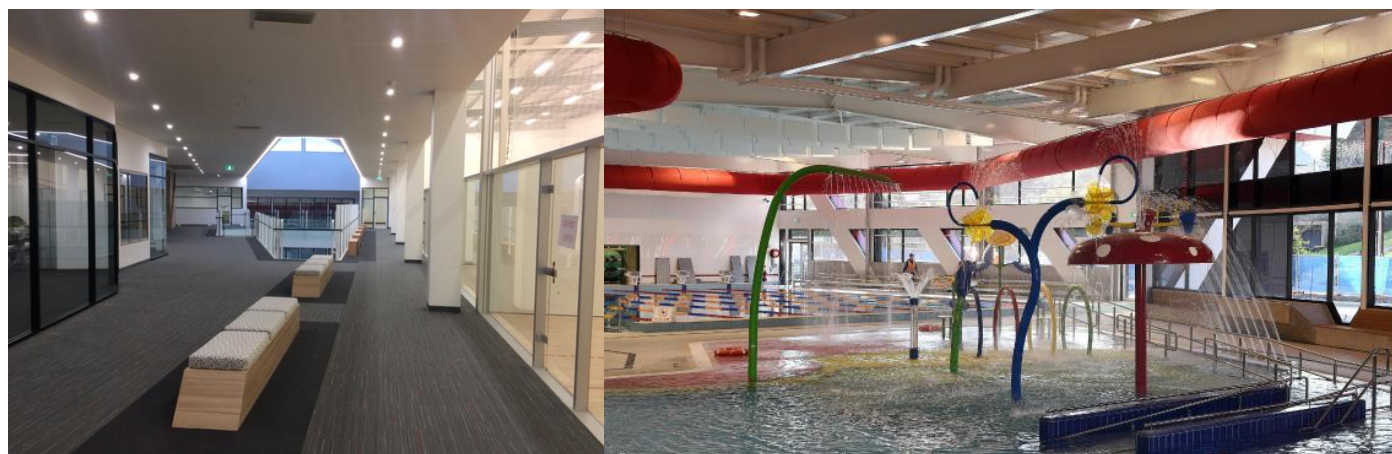

2018 Sth Australian Open

Racquetball Championships

Tournament Conditions

- 1) The 2018 Sth Australian Open & Graded Racquetball Championship is a sanctioned Australian Racquetball Tournament Committee (ARTC) event and forms part of the National Grand Prix Tournament Circuit.
- 2) The tournament will be conducted under the Rules of Australian Racquetball dated 1 January 2017.
- 3) Players are guaranteed a minimum of two matches in each event
- 4) Players may enter one Singles event and/or one Doubles event.
- 5) Singles matches will be played on Saturday with Doubles matches to be played on Sunday. If the Singles matches cannot be completed on Saturday, the finals will be held on Sunday morning.
- 6) The Tournament Director reserves the right for the tournament to utilise normal knock-out, swiss system or round robin.
- 7) In Singles – all matches will be best of 3 games. The first two games will be played to 21 points with the third game being played to 11 points (sudden death to 12).
- 8) In Doubles – all matches will be best of 3 games to 15 points. Doubles teams can be two males, two females or mixed.
- 9) Depending on entries, doubles matches will be played on the official Doubles-sized court (approx. 1.2m wider than the standard size). If numbers do not allow, then only the Open event and A Grade will be played on the Doubles-sized court.
- 10) The Tournament Director reserves the right to combine and/or cancel events where necessary, vary or regrade any entry or change the format of any grade where necessary.
- 11) The Tournament Director reserves the right to:
 - a. Refuse or accept any entry
 - b. Suspend or disqualify any player who is deemed to be not playing in the spirit of the game
 - c. Disqualify any player for drinking alcohol in between matches
- 12) Players must arrive at the courts and report to the control desk within 15 mins of their scheduled match time or face possible disqualification.
- 13) Only the endorsed Stellar racquetball ball can be used for ARTC sanctioned events.
- 14) All players are expected to mark and referee a match immediately following their own.
- 15) Protective eyewear that complies with the Squash Australia Eyewear Policy must be worn by all players 19 years and under.
- 16) All players enter the tournament at their own risk.

Presentations to the Singles Champions will be conducted after the completion of matches on Saturday. Presentations for the Doubles Champions will be held after the completion of all matches on Sunday.

2018 Sth Australian Open Racquetball Championships

Event Information

Singles Events: All Graded Singles Events Are Mixed

Event No.

[1] Men's Open	[5] C Grade	Singles matches will be played on Saturday 10 th March
[2] Women's Open	[6] D Grade	
[3] A Grade	[7] E Grade	
[4] B Grade	[8] F Grade	
	[9] U/13 Juniors	Juniors must be under 13 years of age as at 2 nd March

Entry cost for all Singles Grades is \$30.

Players aged 18 or younger at the date of the tournament are charged \$15

Doubles Events

Event No.

[10] Open	[13] C Grade	All Doubles matches will be played on Sunday 11 th March
[11] A Grade	[14] D Grade	
[12] B Grade	[15] E Grade	

Entry cost for all Doubles Grades is \$15 per player.

Players aged 18 or younger at the date of the tournament are charged \$10

Payment of entry fees can be made by Direct Debit to the account below. Your completed entry form should be sent to Squash SA

Sam Abishara
BSB 733-089
A/C 531876

email squash@squashsa.asn.au

Reference "RAC - Your Name"

Allocation of Prize Money – Singles

Men's & Women's Open (may be subject to change if entries are lower than expected)

1st \$400 2nd 200 3rd \$100 4th \$50

Graded winners

1st \$50

Allocation of Prize Money – Doubles

Open (per team)

1st \$200 2nd \$100

A, B, C, D and E Grade (per team) 1st \$50

2018 Sth Australian Open

Entry Form

to be mailed or emailed to Squash SA

entries close Friday 2nd March 2018

Player Information

Name _____

Phone (h) _____ (w) _____

Phone (mob) _____

Email _____

Club _____ Pennant Grade _____

I wish to enter SINGLES event number _____

I wish to enter DOUBLES event number _____

Please nominate your preferred doubles partner, if you don't have one, we will try to find one for you.

My Doubles Partner is _____ Or Partner Required ☐

TOTAL FEE PAYABLE \$ _____

By signing this Entry Form I agree to abide by the Tournament Conditions and accept the decision of the Tournament Committee as final in all circumstances. I also agree that any photos or video footage of myself taken during the tournament can be used for promotional use.

I understand that the information above will be used to create an account on my behalf on Sporty HQ

Signed: _____

Dated: _____