

BETWEEN THE EARTH AND SKY

Museum of Ramapough Native Indian Arts

Columbia GSAPP
ADV IV, Spring 2021
Instructor: Robert Marino

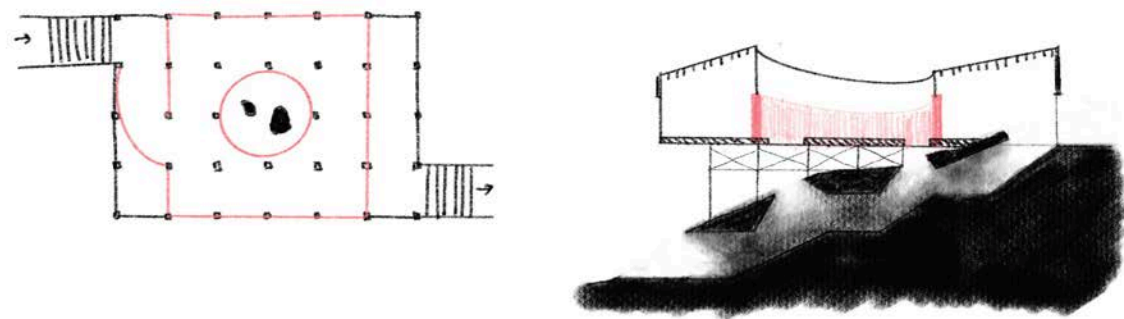

THE MUSEUM OF RAMAPOUGH NATIVE INDIAN ARTS IS A CULTURAL CENTER FOR ARTWORK DISPLAY, A MONUMENT OF COLLECTIVE MEMORIES, AND A PORTAL TO THEIR SACRED TERRITORY, KNOWN AS SPLIT ROCK. SITTING AT THE RAMAPO RIDGE, A CARVED STAIRCASE ALONG WITH THE TOPOGRAPHY SUBTLY INVITES VISITORS TO STEP ON THEIR JOURNEY. IN THE SUNKEN COURTYARD, SCATTERED ROCKS ARE PRESENTED UNDER THE LIGHT AS A PREVIEW OF THE SPIRITUAL EXPERIENCE AHEAD. IN THE CENTER ATRIUM OF PUBLIC GALLERY SPACE, VISITORS WILL RETURN TO THE MOMENT ON A DIFFERENT HIERARCHY TO EMBRACE RAMAPOUGHS VALUES. THE PRIVATE GALLERY RESEMBLES THE SAME ARCHITECTURAL ELEMENTS. HOWEVER, IT INDICATES A FULLY DIFFERENT STORY THAT BECOMES A VESSEL OF THEIR TRIBAL MEMORIES. THE STRUCTURE MADE BY RAMMED EARTH AND STEEL CARRIES THE SENSITIVITY OF AMERICAN'S PRIMITIVE CONSTRUCTION, WHILE IMPLICITLY PRESENTING A PAIR OF GALLERIES FOR NATIVE CULTURES THROUGH INVERSE LANGUAGES.



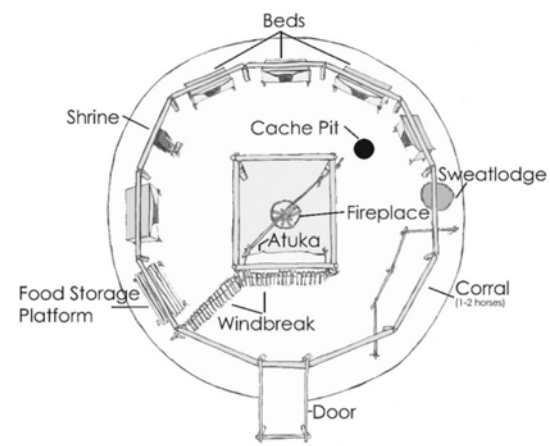

"IN A SENSE, THESE SIX POINTS REPRESENTED THE SIX DIRECTIONS; EAST, SOUTH, WEST, NORTH, UP AND DOWN, WITH THE CENTER FORMING THE SEVENTH DIRECTION, WHICH IS AT THE CENTER OF OUR BEING."

From Mi'kmaq Wigwams and the Architecture of Healing
Evan Pritchard

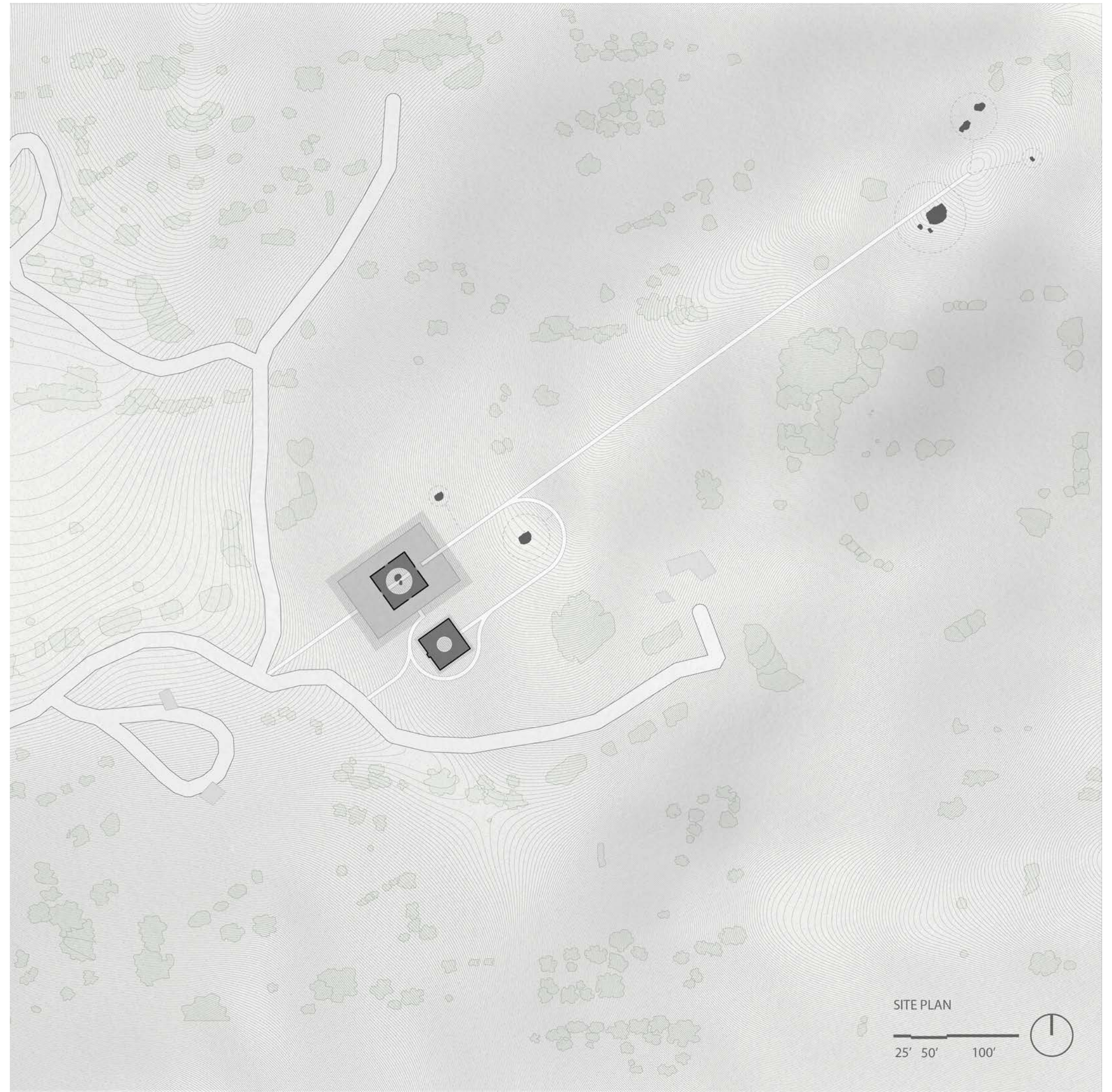

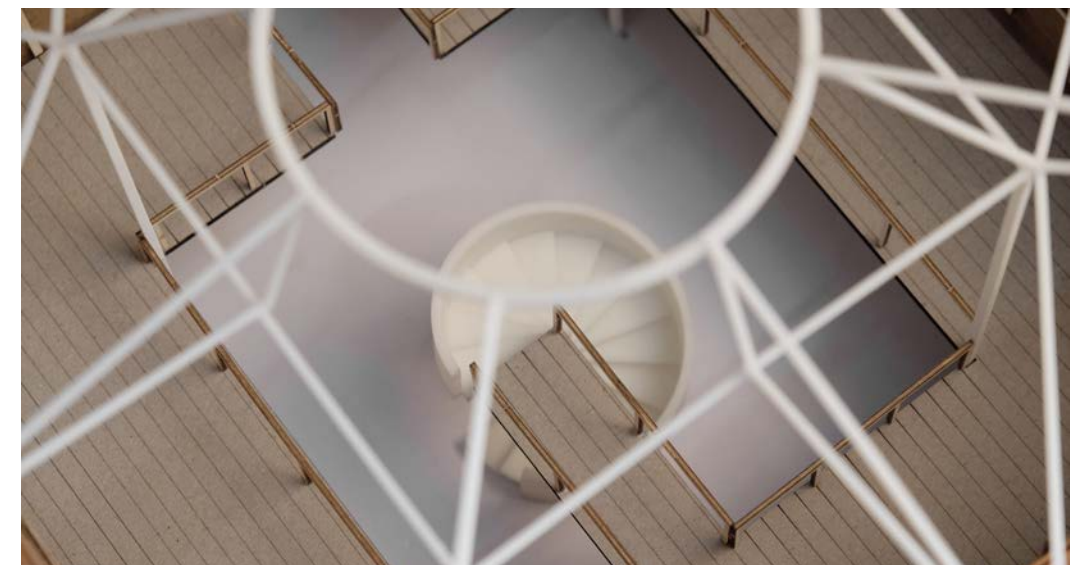
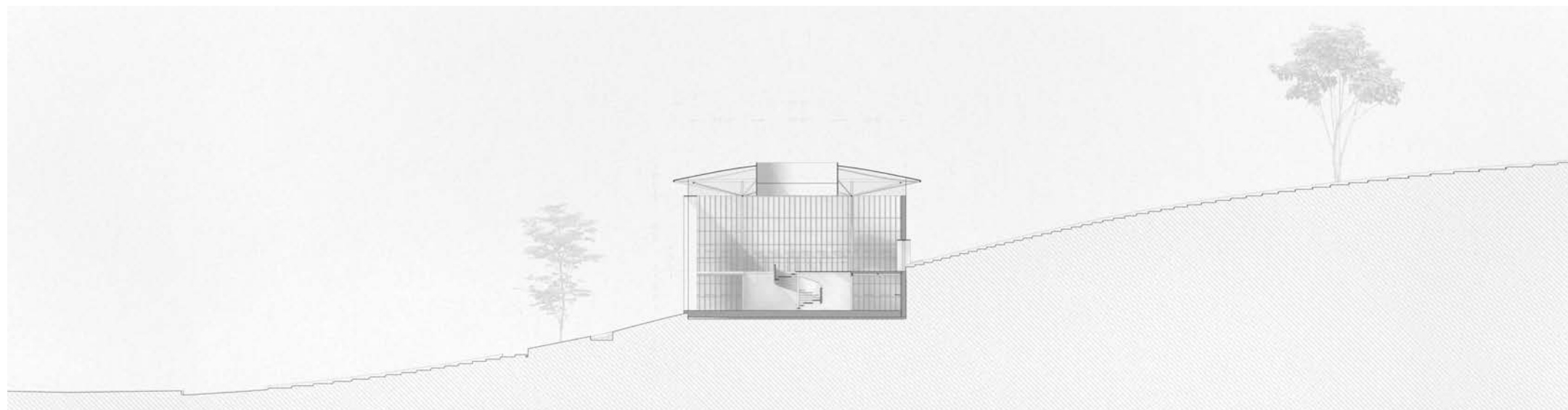
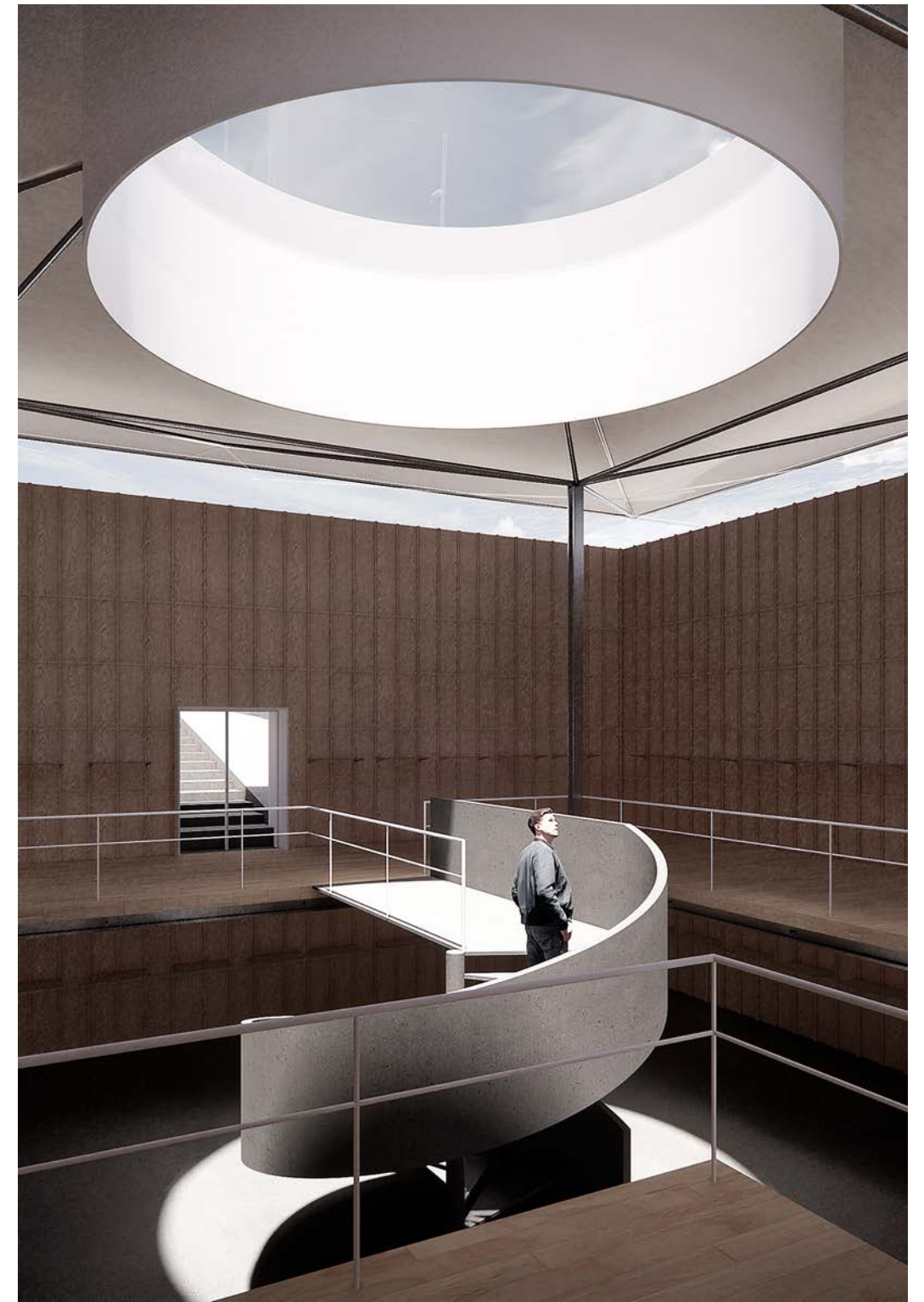
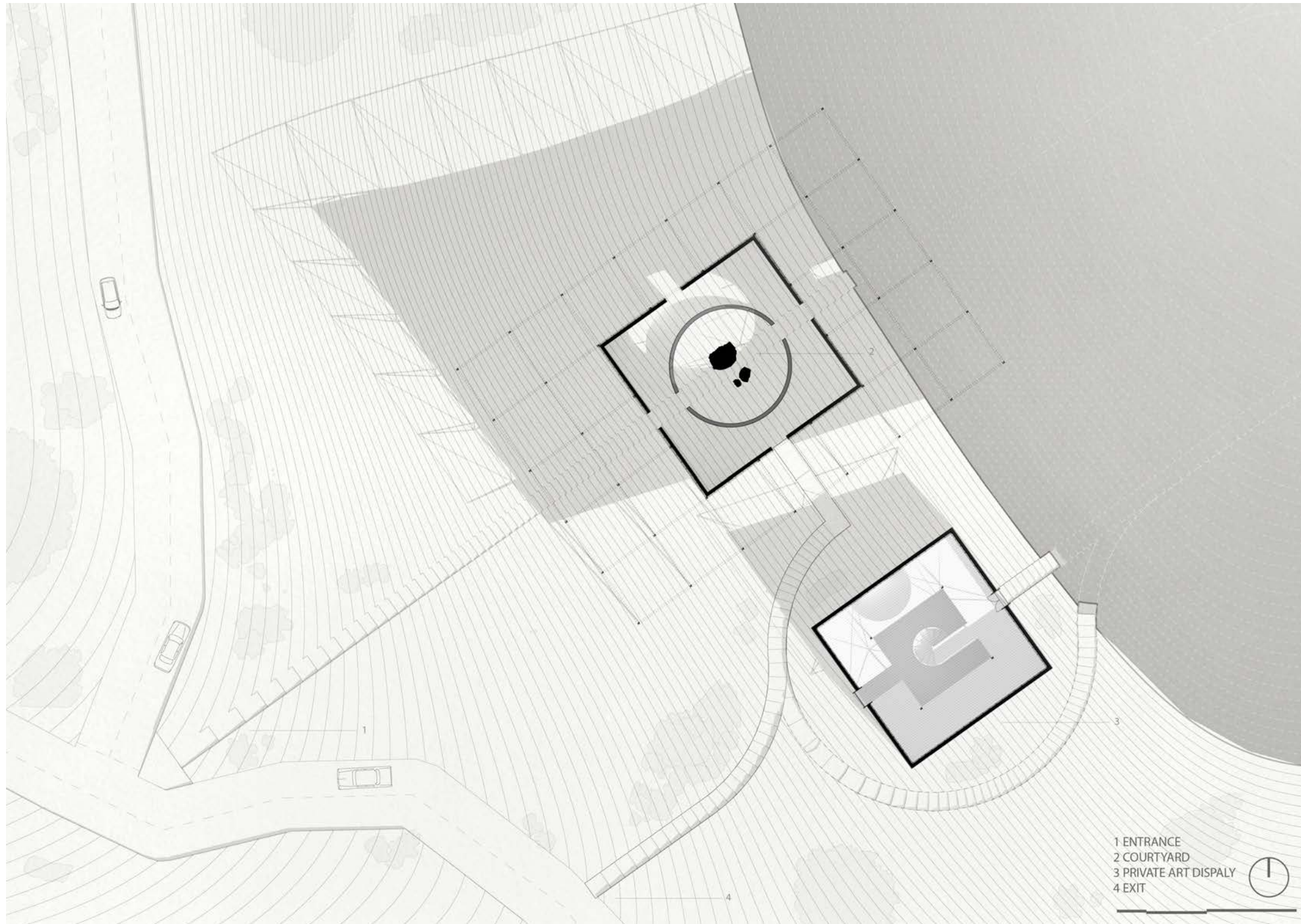

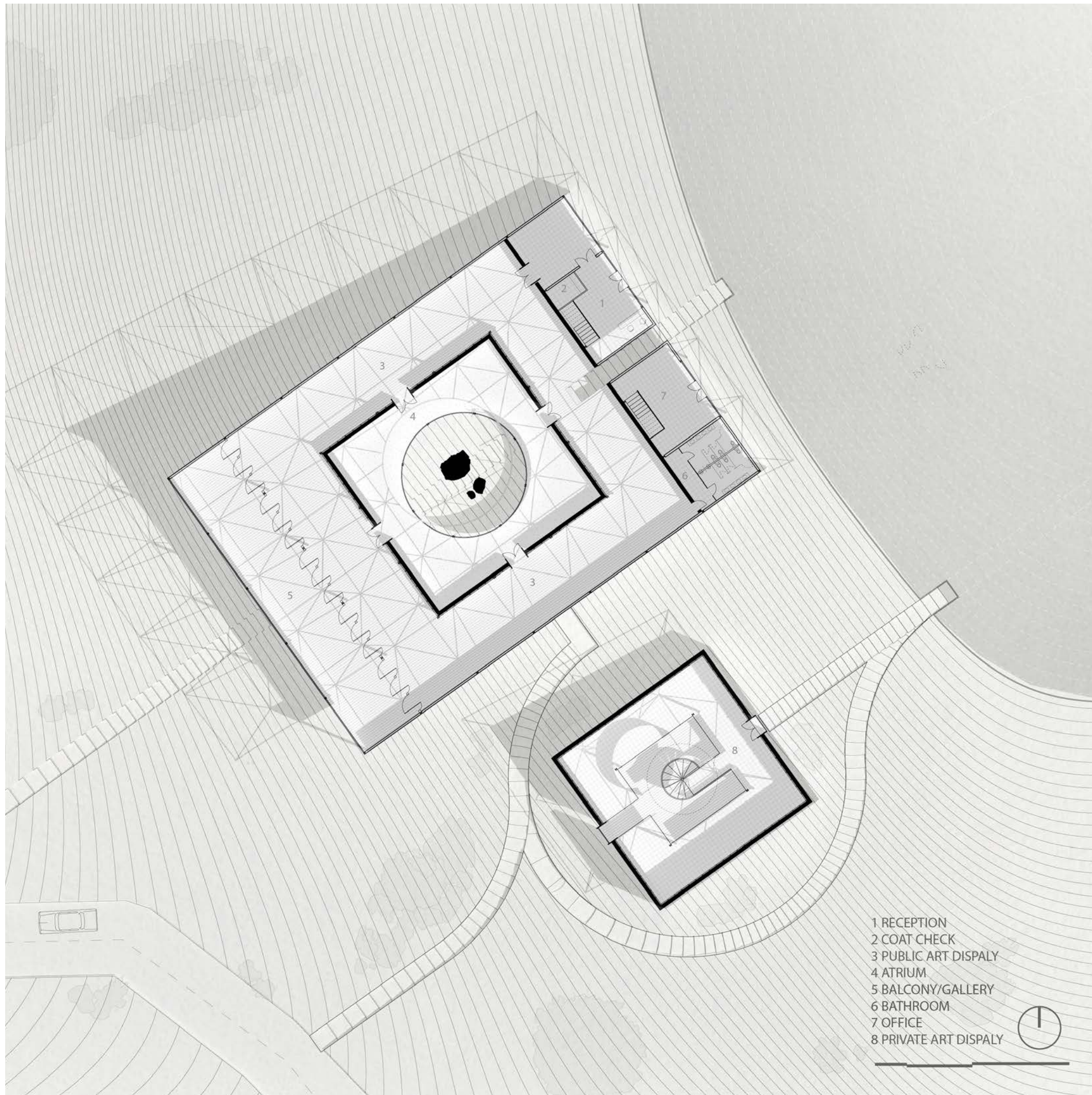

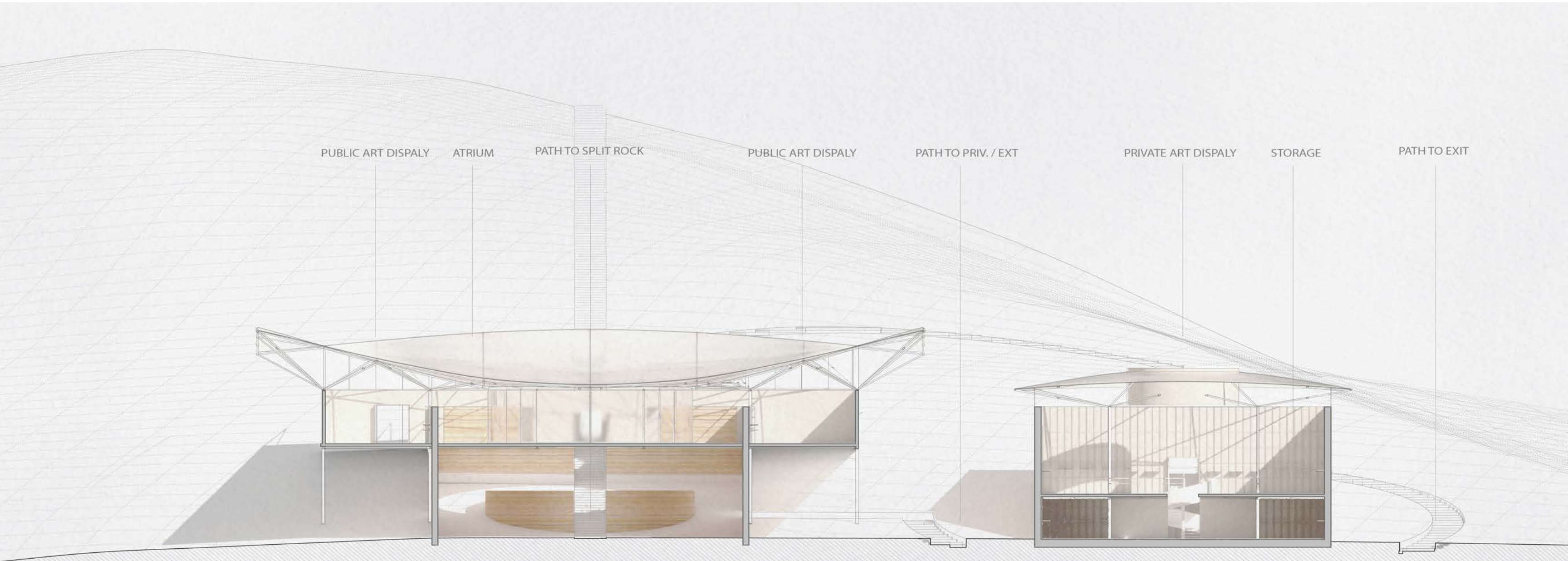
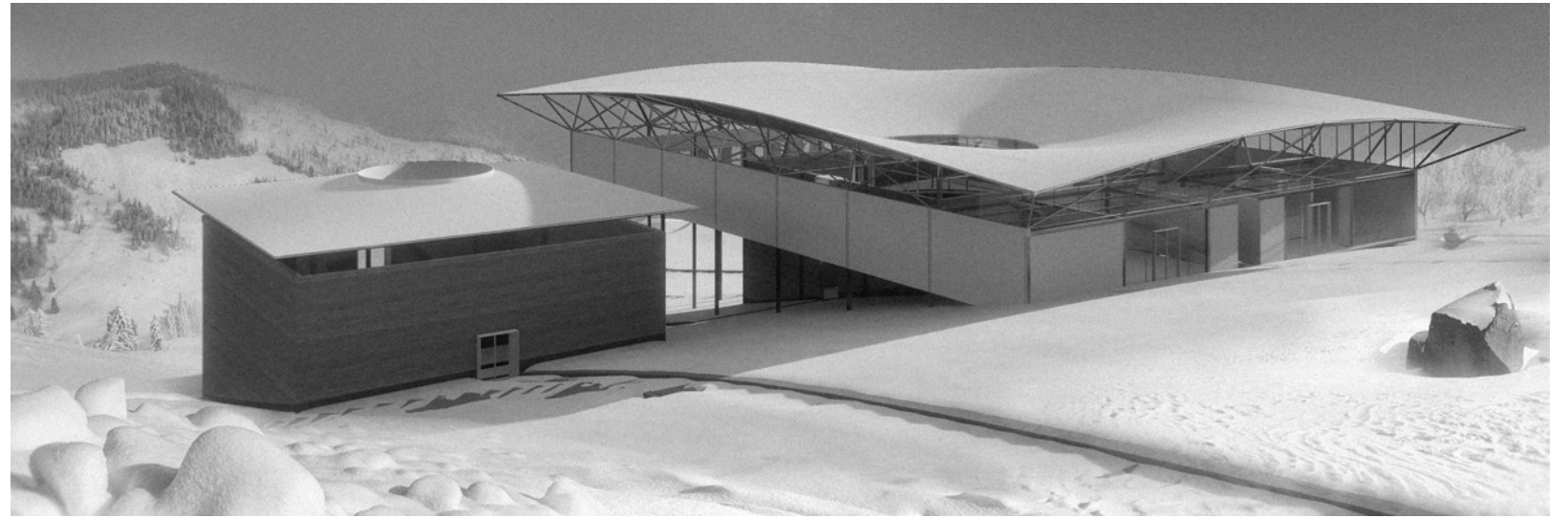

CROSS SECTION THROUGH
RAMMED EARTH SPACES:
PUBLIC VS. PRIVATE ART DISPLAY

9' 18'

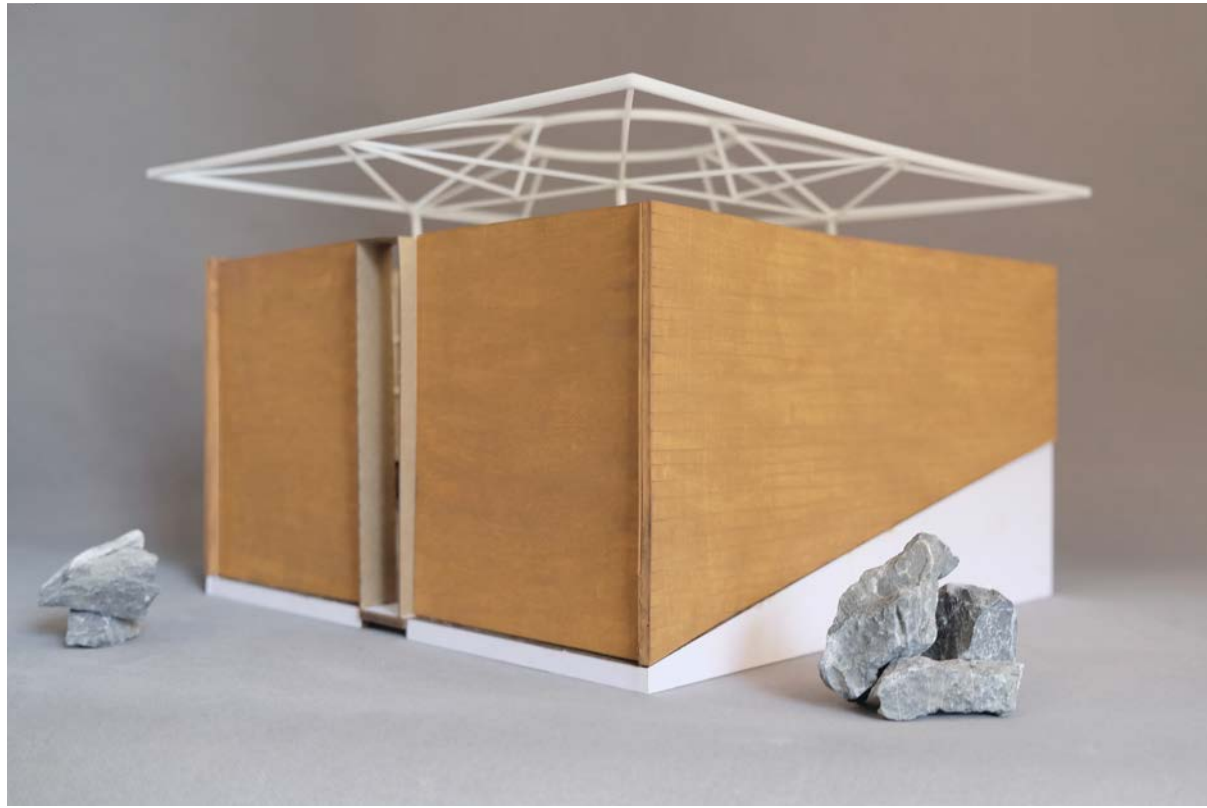

15 GLASS
 14 OPERATIVE WALL
 13 INTERIOR WALLS

12 CIRCULATION
 11 FLOOR PLATES, WOOD FINISHES

4 RAMMED EARTH WALL
 3 RAMMED EARTH FORMWORK
 2 CONCRETE FOUNDATION, RETAINING WALL
 1 CARVED STAIR ALONG TOPOGRAPHY

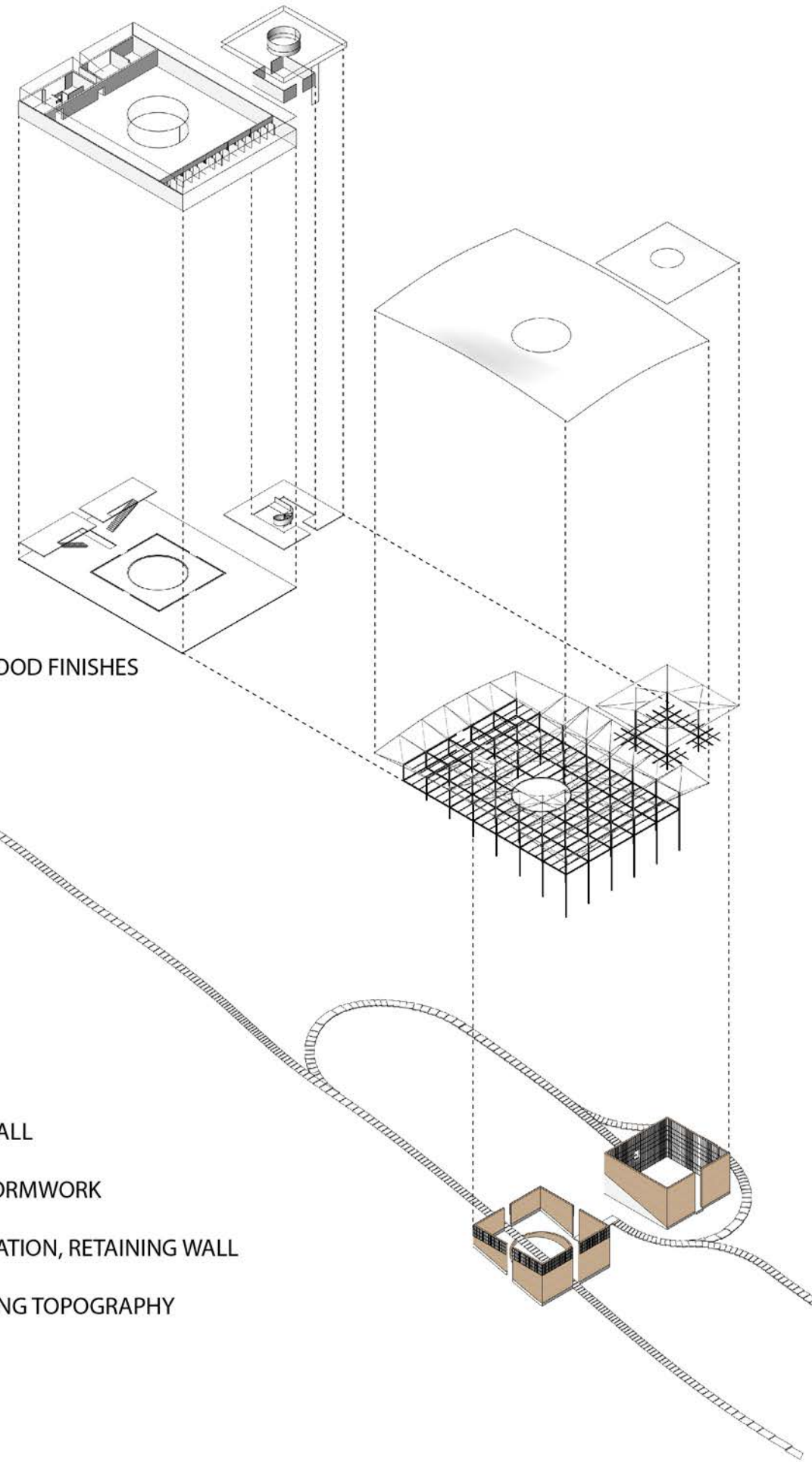

10 COATED FABRIC ROOF
 PVC (Poly Vinyl Chloride)

9 GLASS MULLIONS
 7 ROOF METAL RODS
 6 STEEL SUBSTRUCTURE
 5 STEEL COLLUMNS, GRID OF 18*18FT

