

**LOT
39**

The Woodman Public House, 222 Durnsford Road Wimbledon Park, London SW19 8DF

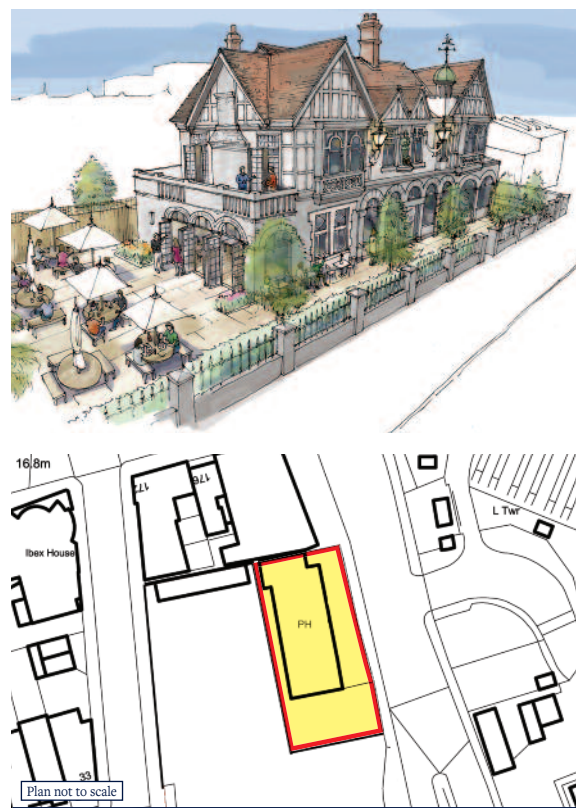

Crown Copyright reserved.
This plan is based upon the Ordnance Survey Map with the sanction
of the Controller of H M Stationery Office.

A large attractive public house of approximately 4,670 sq ft with garden on a prominent site of approximately 0.15 acres near Wimbledon Park, the All England Lawn Tennis Club and Underground.

Tenure

Freehold.

Location

- Situated in a popular and convenient location on the west side of Durnsford Road, just south of its junction with Arthur Road just outside the Wimbledon Park Conservation Area
- Local shopping amenities are close by along Arthur Road and Leopold Road
- The retail and commercial centres of Wimbledon, together with the new AFC Wimbledon Stadium development along Plough Lane, are conveniently nearby
- The leisure areas of Wimbledon Park, Wimbledon Common and The All England Lawn Tennis Club are easily accessible
- Access to the A3 provides good road communications into London and to the M25

Wimbledon Park (District Line)

Wimbledon

Wimbledon (Croydon Tramlink)

Description

- An attractive two storey detached public house building forming part of a prominent rectangular shaped site with good frontage to Durnsford Road
- The first floor provides good size ancillary residential and staff accommodation

- There is an enclosed south facing garden incorporated into the design to provide a landscaped outside family friendly dining experience
- The seller is currently undertaking a sensitive renovation of the public house. Works to clearly separate the public house from the adjacent residential development are completed, please refer to special conditions

Accommodation

- Ground Floor – Main Bar, Lounge and Dining Areas, Male and Female WCs, Beer Cellar/Store
- First Floor – Seven Rooms, Kitchen, Bathroom, Two WCs, Shower Cubicle

Total Gross Internal Area approximately 4,670 sq ft

Total Site Area approximately 0.15 acres

Letting

An agreement to lease (rental agreed £90,000 per annum) has been signed with prospective tenant.

Twelve Week Completion

Viewing

Please contact the auctioneers.