



AUCTIONS

— **GRAHAM PENNY** —

DERBY AUCTION

Friday **14th December** 2018 at **11.30am**
The Pedigree Suite, Pride Park Stadium
Derby DE24 8XL

01332 242 880

www.sdlauctions.co.uk

AUCTION VENUE

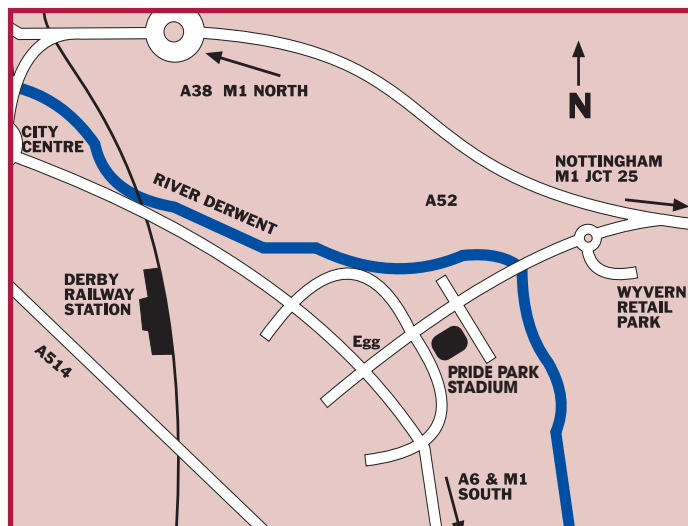

Friday 14th December 2018

(Registration desk opens at 10.30am) Commencing 11.30am

The Pedigree Suite, Pride Park Stadium,
Pride Park, Derby DE24 8XL

Call the team on **01332 242880**
for further information

UPCOMING AUCTIONS

SDL AUCTIONS

— GRAHAM PENNY —

Leicester auction: Tuesday 12th February 2019

Venue: Leicester City F.C, King Power Stadium, Filbert Way, Leicester LE2 7FL

SDL AUCTIONS

— BIGWOOD —

Birmingham auction: Thursday 14th February 2019

Venue: Aston Villa FC, Villa Park Stadium, Birmingham B6 6HE

SDL AUCTIONS

— GRAHAM PENNY —

Nottingham auction: Friday 15th February 2019

Venue: Nottingham Racecourse, Colwick Park, Nottingham NG2 4BE

SDL AUCTIONS

— CHESHIRE &
NORTH WALES —

Cheshire & North Wales auction: Thursday 21st February 2019

Venue: Chester Racecourse, New Crane Street, Chester CH1 2LY

SDL AUCTIONS

— NORTH WEST —

North West auction: Thursday 21st February 2019

Venue: AJ Bell Stadium, 1 Stadium Way, Salford, Manchester M30 7EY

MESSAGE FROM THE AUCTIONEER

Andrew Parker

Managing Director & Auctioneer at
SDL Auctions Graham Penny



Welcome to our December Derby auction catalogue

It's our final auction of 2018 at Pride Park Stadium in Derby and with 43 residential and commercial lots filling the pages of the catalogue, we're expecting another busy day.

Lots going under the hammer include buy-to-let opportunities suitable for landlords, renovation and development projects, properties ideal for family homes and first time buyers and a selection of commercial properties, plots of land and garages.

25 Tower Road in Hartsthorpe (LOT 37) is a three bedroomed detached property occupying a cul-de-sac location with far reaching countryside views, offering the potential to extend subject to obtaining relevant planning permission. It comes with a *guide price of £165,000+ (plus fees).

A star lot in the auction comes at **10 Derby Road in Belper (LOT 9)**. A unique and rare opportunity to acquire an attractive stone built two bedroomed Grade II listed property. With a guide price of £90,000+ (plus fees) the property requires a scheme of improvement works throughout.

Those looking for a family home could be interested in **162 Blenheim Drive in Allestree (LOT 38)**. A three/four bedroomed detached house benefiting from double glazing and gas central heating. Close to local amenities including schools and shop, the property has a guide price of £195,000+ (plus fees).

35 Mayfield Road in Chaddesden (LOT 1) is a two bedroomed detached bungalow requiring upgrading and renovation work throughout. There is potential for a separate building plot subject to the relevant planning consents. It comes with a guide price of £65,000+ (plus fees).

If you're an investor looking to add to a portfolio of properties, **1 Wood Street (LOT 43)** could be for you. A three bedroomed semi-detached property with a garden to the rear and off road parking. With a guide price of £65,000+ (plus fees), the property is in need of scheme of improvements.

Another star lot set to be sold under the hammer comes at the **Belper Adult Community Education Centre in Belper (LOT 41)**. A unique and rare opportunity to acquire a large freehold detached character property, offering potential for redevelopment or conversion, subject to gaining planning permission. It has a guide price of £250,000+ (plus fees).

2 Camden Street in Derby (LOT 32), is an excellent opportunity to purchase a vacant two storey premises formally used as fast food takeaway on the ground floor with spacious three bedroomed residential accommodation above. The property comes with a guide price of £140,000+ (plus fees) and has been recently refurbished throughout.

If you're interested in any of the lots in this catalogue, please visit our website to download the legal packs and view further property details. If you're not able to make it to the auction room on Friday 14th December then you can submit a Proxy, Telephone and Online Bidding Form – found on page 49 of this catalogue – or you can watch the auction live from our website.

We're already inviting entries for our first 2019 Derby auction on Wednesday 13th February so if you'd like to arrange a free no obligation appraisal see our team in the auction room or call us on 01332 242 880.

DATES FOR YOUR DIARY

Derby 2019 auction dates:

Wednesday 13th February
Thursday 11th April
Friday 24th May
Thursday 25th July

Thursday 5th September
Friday 25th October
Friday 13th December

MEET THE DERBY TEAM



Rory Daly

Chief Executive Officer & Auctioneer
rory.daly@sdlauctions.co.uk



Andrew Parker

Managing Director & Auctioneer
andrew.parker@sdlauctions.co.uk



Graham Penny

Auctioneer
graham.penny@sdlauctions.co.uk



Robert Stone

Senior Valuer
robert.stone@sdlauctions.co.uk



Laura Wiles

Valuer
laura.wiles@sdlauctions.co.uk



Nick Trow

Commercial Auction Valuer
nick.trow@sdlauctions.co.uk



Emma Holness

Derby Property Manager
emma.holness@sdlauctions.co.uk



Alison Jeffery

Accounts Manager - Derby
alison.jeffery@sdlauctions.co.uk



Naomi Fearn

Auction Negotiator
naomi.fearn@sdlauctions.co.uk



Sarah Barfield

Administrator
sarah.barfield@sdlauctions.co.uk



Margaret Thompson

Administrator
margaret.thompson@sdlauctions.co.uk



Abigail Selwood

Operations Manager
abigail.selwood@sdlauctions.co.uk



Louise Jefferies

Director of Business Development
louise.jefferies@sdlauctions.co.uk



Jason Lee

National Sales Manager
jason.lee@sdlauctions.co.uk



Dean Slack

Auction Expert
dean.slack@sdlauctions.co.uk

IMPORTANT NOTICES TO BE READ BY ALL BIDDERS

BUYING AT AUCTION

1. This catalogue contains details about properties being sold at auction. Those details are subject to change up to and including the day of the auction. Please check our website regularly at: www.sdlauctions.co.uk and look out for any additional materials available on the day of the auction, in order to stay fully informed with the up to date information.
2. Prospective purchasers are advised that sales are subject to (a) the Common Auction Conditions of Sale printed in the catalogue; (b) Special Conditions of Sale which are available for inspection at the office of the Vendors Solicitors, the office of the Auctioneers, in the auction room and online from our website; (c) any addendums or alterations made available for inspection; (d) any late amendments distributed in the room or made by the auctioneers from the rostrum.
- 2A. Prospective purchasers should always check the addendum sheet on the day of the sale to see if there are any alterations or amendments to the particulars or special conditions on the property that they are interested in bidding for. The catalogue has been prepared on the basis of information provided. In some cases, for whatever reason, verification has not been possible prior to printing. Consequently amendments may be made and the purchaser deemed to have full knowledge of them.
3. Prospective purchasers shall be deemed to have inspected the relevant property and made all usual and necessary searches and enquiries with all relevant authorities and other bodies. It is advisable to arrange for a survey of the property prior to the auction.
4. As soon as the Auctioneer's gavel falls on a bid, the successful bidder is under a binding contract to purchase the relevant property. The purchaser is immediately at risk in relation to the property and should therefore have confirmed bank or building society finance arranged (if required) and will also be deemed to have made prior arrangements for any insurance cover that is required. (See footnote).
- 4A. Each bidder will be deemed to be personally liable on making an accepted bid even though he/she purports to act as an agent for the principal purchaser or purports to sign the Memorandum of Sale in a respective capacity.
5. On the fall of the gavel, the successful bidder must immediately present to the Auctioneers Clerk his name and address and if appropriate, the name and address of the person or company on whose behalf he has been bidding. All successful bidders are required to sign and exchange unconditional contracts, or a reservation contract if applicable, with the Auctioneers prior to leaving the room and pay to the Auctioneers a deposit of 10% (or 5% for an unconditional reservation fee sale) of the purchase price (subject to a minimum of £5,000) with completion on or before 20 business days unless an alternative date has been specified for a given property within the Contract and/or within our Vendor's Special Conditions of Sale. All properties must have deposits paid by Bank/Building Society Draft or Visa debit card. Please contact the relevant auction office for advice about acceptable payments. In default of any of the above, the Auctioneer shall be entitled as Agent for the Vendor, to treat the failure or default as a repudiation and rescind the Contract. Thereafter the Auctioneer shall be entitled to re-submit the property for sale and if a successful bidder does not pay a deposit and/or complete the memorandum, the Vendor reserves the right to claim any loss he suffers as a result.
6. All purchasers whether buying prior, during or post Auction are required to pay a buyers administration fee of £1074 inc VAT (unless stated otherwise), this fee is to be added to the deposit, irrespective what costs may be included within the Contract or Special Conditions. A buyers administration fee does not apply where a reservation fee is payable. The reservation fee will be 4.8% inc VAT or 4.2% inc VAT in London of the purchase price, subject to a minimum of £6,000 inc VAT, unless stated otherwise. The reservation fee does not contribute towards the purchase price.
7. If a successful purchaser wishes to remain in the sale room and bid for later lots before transferring to the contracts area, he/she shall be required to surrender to the Auctioneers clerk one form of identity for retention by the auctioneers until such time as the memorandum of sale is completed.
8. The Vendor has a right to sell before auction or withdraw the lot and neither the Auctioneer nor the Vendor is responsible for any abortive costs, loss or damages of a prospective purchaser. Information as to pre-sale or withdrawal of a lot can be obtained from enquiry of the Auctioneers at any time prior to the auction but valid only up to the time of enquiry.
9. Prospective purchasers are strongly advised to check these particulars as to measurements, areas and all other matters to which the properties are expressed to be subject or have the benefit of and in respect of any contents, fixtures and fittings expressed to be included in the sale by making an inspection of the property and all the necessary enquiries with SDL Auctions, the Vendor, the Vendor's professional advisors and all other appropriate authorities. All measurements and areas referred to in these particulars are approximate only.
10. The dimensions and/or areas shown in this catalogue are intended to be accurate to within + 5% of the figure shown. If greater accuracy is required we advise intending purchasers to carry out check measuring.
11. All location plans published in the particulars of sale are copyright and are to enable prospective purchasers to locate the property only. The plans are photographically reproduced and therefore not to scale and are not intended to depict the interest to be sold but are for identification purposes only. The boundary lines and numbers on the photographs are again only to enable prospective purchasers to locate the property and are not intended to depict the interest to be sold. Purchasers are advised to view the special conditions in respect of the precise interest to be conveyed.
12. Any guide prices issued or any estimates or values mentioned in negotiations or discussion with the Auctioneers or any of their representatives cannot be relied upon by a prospective purchaser as representing professional valuations for any purpose in accordance with the requirements or guidance notes of relevant professional bodies or other authorities. In all respects prospective purchasers are deemed to have relied upon their own knowledge or the advice of their own professional or other advisors.
13. Inspection of investment properties is by courtesy of the tenant. Inspection of properties with vacant possession only by arrangement with the Auctioneers. Interested parties should refer to the viewing schedule in the front of the catalogue or alternatively contact the Auctioneers.
14. Purchasers should be aware that they will not be entitled to the keys or access to the property (except by special arrangement) until completion date of the sale.
15. The Auctioneers announcements at the commencement of the sale are an important part of the proceedings. Thereafter the Auction will proceed without delay and the Auctioneer will not describe the properties in detail nor read out the special conditions or amendments.
16. The services, kitchen and sanitary ware, electrical appliances and fittings, plumbing and heating installations (if any) have NOT been tested by the Selling Agents. Prospective purchasers should therefore undertake their own investigations/survey to clarify the suitability of such services to meet their particular requirements.
17. We are advised by the Vendor, where appropriate, that an EPC (Energy Performance Certificate) has been commissioned and will be available within the legal pack.
18. The plans provided in this catalogue are for identification purposes only and their accuracy is not guaranteed. All Ordnance Survey maps are reproduced with the sanction of the Controller of HM Stationery Office (Crown Copyright Reserved Licence No. LIG0183).
19. If the purchaser wishes to complete earlier than

the proposed completion date (granted prior agreement with the Vendor), then we strongly recommend that the deposit is paid by cleared funds e.g. Banker's Draft, Building Society Draft or Debit Card. The purchaser must notify the Auctioneer as early as possible of their intention to complete early in order that arrangements can be made to transfer the deposit monies held. The Auctioneers also reserve the right to pass on any charges levied from the bank to the purchaser for early transfer of monies.

20. Offers – We will not forward any offer to our Vendors, unless the offer is above the guide price and prospective purchasers have viewed the property (where applicable) and have perused the legal pack.

PROPERTY INSURANCE

Once the hammer falls at a Property Auction the purchaser becomes liable for the insurance of the property he has bought.

DEFINITION OF GUIDE PRICES

The guide price is an indication of the seller's reserve price and is given to assist prospective purchasers. It is usual, but not always the case, that a provisional reserve is agreed between the seller and the auctioneer at the start of marketing. The guide price can be adjusted by the seller at any time up to the day of the auction in light of the interest shown during the marketing period. The guide price can be shown in the form of a minimum and maximum price range within which an acceptable sale price (reserve) would fall, or as a single price figure within 10% of which the minimum acceptable price (reserve) would fall. Please note the reserve price will not exceed the top end of the guide price but the actual sale price can exceed the guide price. On occasions the sale price does exceed the guide price significantly.

AUCTION FEES

The purchase of any property may include associated fees not listed here. Any additional fees will be confirmed in the legal pack which can be downloaded from our website, www.sdlauctions.co.uk or to find out more about any additional fees associated with any property please call SDL Auctions on 01332 242 880. Stamp Duty, Land Tax or Land and Buildings Transaction Tax may also apply in some circumstances. These costs will not be confirmed in the legal pack, it is up to the bidder to make their own enquiries via www.gov.uk/stamp-duty-land-tax or www.revenue.scot/land-buildings-transaction-tax.

DEFINITION OF RESERVE PRICE

The reserve price is the seller's minimum acceptable price at auction and the figure below which the auctioneer cannot sell. The reserve price is not disclosed and remains confidential between the seller and the auctioneer.

CONDITION OF SALE

The Lots will, unless previously withdrawn, be sold subject to the Special and General Conditions of Sale which have been settled by the Vendors' Solicitors. These Conditions can usually be inspected during the usual office hours at the offices of the Vendor's Solicitors mentioned in these particulars during the five days (exclusive of Saturday and Sunday), immediately before and exclusive of the day of the Sale. Most auction packs may be viewed online, visit www.sdlauctions.co.uk The Conditions may also be inspected in the Sale Room at the time of the Sale, but they will NOT then be read. The Purchaser shall be deemed to bid on those terms, whether he shall have inspected the Conditions or not.

PROPERTY MISREPRESENTATION

The Agents for themselves and for the Vendors of these Lots, whose Agents they are, give notice that: These Particulars do not constitute any part of an offer, or a contract. All the statements contained in these particulars as to the Lots are made without responsibility and are not to be relied on as statements or representations of fact and they do not make or give any representations or warranty whatsoever in relation to these Lots. Any intending Purchaser must satisfy himself by inspection or otherwise as to the correctness of each of the statements contained in these Particulars.

FREQUENTLY ASKED QUESTIONS

Q. What order will the lots be offered in?

A. The Lots are offered as listed in the catalogue (Yes we are asked this question frequently!)

Q. Can I view the properties before the Auction?

A. Yes, please contact the office or book onto the set viewing appointments online at www.sdlauctions.co.uk.

Q. What is a reserve price?

A. A reserve price is the price stipulated as the lowest acceptable by the vendor. This figure is confidential between the vendor and auctioneer.

Q. Is the guide price the same as the reserve price?

A. No, not always. The guide is an indication given by the Auctioneer. Where the guide price is a bracket figure, the reserve cannot exceed the top end of the bracket price. If the guide price is a single figure, then the reserve can be up to 10% in excess of this.

Q. How do I register to bid at the auction?

A. You must register on the day of the Auction at the auction venue, you will need 2 forms of original or certified identification (one photo and one proof of address) to register. To save you time on auction day, you can fill in the registration form within this catalogue and bring it with you on the day.

Q. How long does it take to offer each lot?

A. Each lot varies; there is no set amount of time per lot although it is generally approximately 2-3 minutes per lot.

Q. If I am a successful bidder how much deposit do I have to pay?

A. Normally 10% of the purchase price for an unconditional sale, however we do recommend checking the legal pack to confirm this as some lots vary. If the property is sold via the unconditional reservation fee method then a 5% deposit is payable. The deposits are subject to a minimum fee of £5,000.

Q. How is the deposit payable?

A. Either by banker's draft (made payable to "SDL Auctions") or debit card.

Q. How much should I make my bank draft for?

A. 10% of your maximum offer, if you purchase the property for less than your maximum offer, the full amount of monies will be used as your deposit i.e. more than 10% deposit paid and you will pay less on completion. If you purchase the property for slightly more than your intended maximum offer you can top your deposit up with a debit card.

Q. If I am a successful purchaser when do I have to complete the purchase and pay the balance monies?

A. The normal completion period is 20 business days after the sale, although you should inspect the legal pack to confirm this as some lots vary.

Q. How can I view the legal pack and contract before the auction?

A. These are available to view on our website and are uploaded as and when we receive them from the appointed solicitor. They can also be inspected on the day of the auction in the auction room.

Q. If I am unable to attend the auction can I bid by proxy, telephone or internet?

A. Yes, a proxy, telephone or internet bidding form is available within the catalogue or on our website. This form must be completed and returned to the Auctioneers along with a bank draft or building society draft for the deposit and buyers fee at least 48 hours prior to the Auction Sale for telephone and internet bids and 24 hours for proxy bids.

Q. If I am unable to attend the Auction, can someone bid on my behalf?

A. Yes, however they must bring with them 2 forms of original identification for you and for themselves, along with an authorisation letter from yourself. It must be noted that should you default, the bidder will be liable.

Q. Can I make an offer prior to the Auction?

A. Yes, some vendors will consider selling prior to the auction but only on the condition that an unconditional contract is exchanged before the auction with a cleared funds deposit.

Q. How can I make this offer?

A. Offers must be made in writing or by email to derby@sdlauctions.co.uk. Verbal offers will not be accepted. Offers may not be acknowledged, but you will be contacted within 7 days if your offer is accepted.

Q. Can I have the property surveyed before the auction?

A. Yes, your surveyor must contact us for access.

Q. Do some lots not sell?

A. Yes, if a reserve price is not reached the lot will not sell. We continue to market most unsold properties after the auction so you may still purchase these lots, however all post-auction sales are under auction terms.

Q. Are there any further costs to pay in addition to the sale price?

A. A buyers administration fee of £1074 inc VAT (see Important Notices in the catalogue) is payable on exchange to SDL Auctions if the lot is sold unconditionally. If a property is an unconditional reservation fee lot then a reservation fee of 4.8% inc VAT or 4.2% inc VAT in London, (subject to a minimum fee of £6000 inc VAT) is payable (unless stated otherwise). The reservation fee does not contribute towards the purchase price. Any further additional costs, which are payable in addition to the purchase price will be included within the Special Conditions that are attached to the Contract. Therefore all prospective purchasers must inspect the legal packs and we strongly advise that all prospective purchasers request a legal representative to go through the pack for every lot that you may wish to bid on, in order to be made fully aware of any additional costs, if applicable.

Q. Why is a reservation fee payable on some lots?

A. A buyers reservation fee is payable by the buyer where a seller has opted to sell with no fees. However, as a result, a lower reserve price is usually agreed. The reservation fee does not contribute toward the purchase price. A buyers administration fee is not payable on these lots.

Q. If I do not complete the sale are there any penalties?

A. Yes, firstly you will lose your deposit and admin fee, furthermore the Vendor may sue you for the balance owed and any further losses caused.

Q. Will I be able to get a mortgage on the property?

A. Not all properties are suitable for mortgage security and we strongly recommend that you arrange for an independent survey to be carried out if you require mortgage finance.

Q. How do I know whether the details given in the catalogue change or a property is withdrawn or sold prior?

A. An addendum is available on our website (www.sdlauctions.co.uk) at all times and is updated regularly and is also available at the auction. Alternatively, you can register for our email alert service by emailing us on marketing@sdlauctions.co.uk It is essential that you see the addendum prior to bidding.

Q. Can I go on the permanent mailing list to receive future auction catalogues?

A. Yes, contact us by telephone (01332 242 880) or by email (marketing@sdlauctions.co.uk)

PROOF OF IDENTITY & ADDRESS

All bidders and buyers must provide two forms of identification, one photographic and one proof of address in order to register and receive a bidding paddle.

**Original documents MUST be provided.
Photocopies are NOT acceptable.**

PHOTOGRAPHIC ID

- Current signed passport
- Current full UK/ EU driving licence*
- Resident Permit issued by the Home Office to EU Nationals
- Inland Revenue Tax Notification
- State Pension, Benefit Book or notification letter*

EVIDENCE OF ADDRESS

- Current full UK/ EU driving licence*
- Utility bill issued with the last 3 months
- Local Authority tax bill
- Bank, Building Society or Credit Union statement from a UK lender
- State Pension, Benefit Book or notification letter*

***These documents may be used as proof of identification or evidence of address but NOT both.**

WHAT ELSE DO I NEED TO BRING...

- **If I am bidding as an agent for the buyer?**
 - Written authority from the buyer stating they give you authority to bid on their behalf.
 - ID for the bidder and buyer
- **If there is more than one individual purchasing jointly?**
 - ID is required for each buyer.
- **If the provider of funds is different to the bidder or buyer?**
 - ID for the funds provider
 - ID for the bidder and buyer
- **If I am bidding for a Limited company or Limited Liability Partnership (LLP)?**
 - ID for the bidder
 - Certificate of incorporation
 - Proof of registered office address
- Full names of board of directors (unless company is listed on a regulated market)
- ID for shareholders holding more than 25% of share capital
- **If I am bidding for an unincorporated business or partnership?**
 - ID for the bidder
 - Written authority from the company that you have the authority to purchase on behalf of the company at the auction
 - Certificate of incorporation
- **If I am bidding for a Trust (or similar)?**
 - ID for the bidder
 - ID for each beneficial owner
 - ID relating to the settler of the trust
 - ID for each trustee

REGISTRATION OF BIDDERS

BIDDERS NO:

You will be required to register before you can take part in the auction. If you would like to be prepared you can fill in our Auction Registration Form below ready to bring with you on the day.

BIDDER DETAILS

First Name:	<input type="text"/>	Surname:	<input type="text"/>
Company:	<input type="text"/>		
Address:	<input type="text"/>		
Postcode:	<input type="text"/>	Telephone:	<input type="text"/>
Email:	<input type="text"/>		

BUYERS DETAILS

*** ONLY APPLICABLE IF BIDDING ON SOMEONE ELSE'S BEHALF**

First Name:	<input type="text"/>	Surname:	<input type="text"/>
Company:	<input type="text"/>		
Address:	<input type="text"/>		
Postcode:	<input type="text"/>	Telephone:	<input type="text"/>
Email:	<input type="text"/>		

SOLICITORS/CONVEYANCER DETAILS

First Name:	<input type="text"/>	Surname:	<input type="text"/>
Company:	<input type="text"/>		
Address:	<input type="text"/>		
Postcode:	<input type="text"/>	Telephone:	<input type="text"/>
Person Dealing:	<input type="text"/>		

MEANS OF IDENTIFICATION

NB: TWO FORMS OF ORIGINAL I.D. MUST BE BROUGHT TO THE AUCTION IN ORDER TO BID

Passport:

Driving Licence:

Bank Statement:

Utility Bill:

Other:

MEANS OF DEPOSIT PAYMENT

Bankers Draft:

Debit Card:

Building Society
Draft:

I confirm I will pay the required deposit and the Auctioneer's buyers fee once the hammer has fallen. I confirm that I will purchase Lots with full knowledge and acceptance of the Important Notices, Common Auction Conditions, Legal Pack and Addendum. I hereby acknowledge that I take full responsibility of all bids undertaken with the above bidders number.

Privacy Notice: SDL Auctions Registration of Bidders

SDL Auctions is part of the SDL Group (www.sdgroup.co.uk). We collect the above information from you so that we can conduct the bidding process. We may also use your data to send you relevant marketing from within the Group. We will store your data for six years. To opt out or if you have any questions about how we handle your data please contact compliance@sdgroup.co.uk.

SIGNATURE:

DATE:

Graham Penny

Consultant and auctioneer at SDL Auctions Graham Penny



Graham has worked in the Derbyshire property market for 50 years. A well-known name on the East Midlands property scene, Graham is a regular on BBC One's Homes under the Hammer and is regarded as one of the top property auctioneers in the country.

Graham founded Graham Penny Auctions (now SDL Auctions Graham Penny) in 2006 and today, in semi-retirement, is still working with the business as a consultant.



What is your business motto?

Honesty, integrity and professionalism. It's about giving truthful help and advice in a friendly way; not necessarily telling someone what they want to hear, and being prepared to walk away from a job if you know you can't deliver the right result.

What is office life like for you and your team?

As a consultant I am no longer in the office on a day-to-day basis, and in some senses I miss it, because we have a terrific team of capable friendly staff who are a delight to be with! It is a well-oiled machine with considerable expertise, a lovely atmosphere, efficiency and loads of hard work.

What is your approach to work / life balance?

I have always tried to keep a balance between work and play. Whilst you never switch your mind off – and constantly remind yourself of things still to do – there has to be some pre-planned downtime, and space for other (important) things. After all, 'all work and no play makes Jack a dull boy' let alone risk the possibility of burn-out.

What is your approach to making contacts which are useful for the business?

Since I'm now a consultant I don't go out of my way to 'network' any longer but I'm always on the lookout for business opportunities. Occasionally they come without looking for them and it's still rewarding to get phone calls from people who say

something like - 'you sold a property for a friend of mine who was impressed with your services, so I hope you don't mind me contacting you.....' Recommendations are still encouraging!

Who has inspired you most in your business life, and why?

There have been several people who have taught me a lot in terms of business, but the person who stands out most and almost inevitably is the partner in W.S. Bagshaw and Sons to whom I was articled for three years as an 18 year old school leaver. He taught me so much – including 'Graham, don't be a clock watcher!' I still hate being late for appointments!

What is your proudest achievement in business?

There have been many proud moments in my working life, including winning several awards, but the real red letter day was selling Alton Manor in mid-Derbyshire in a marquee on the premises for £2.425m – the most expensive property I ever had the privilege to sell at auction. As an alternative, there was the excitement of setting up my own business – but that's another story!

What drives and motivates you?

There is a distinct caring attitude to my personality, so it would be to do a good job, help people and succeed in what they have asked you to do.

If you hadn't been an auctioneer, what would you do instead?

That's a difficult one! There's a lot of things I might like to be but do not have the aptitude or expertise. I think it might be something to do with estate or land management.

What time of day are you at your best, and why?

I'm definitely a morning person. I have no idea why that should be; some people are at their best late into the evening. I guess we're all different.

Do you use Facebook, Twitter or other social media?

I do not use any type of social media. Maybe it's a generational thing, but generally I reckon I've got enough to do without spending another hour or two of my day with the phone. I'll stick with emails and WhatsApp!

If you could have a coffee with anyone, who would it be, and what would be your choice?

There are many people I have admired, some of whom are no longer with us, but in my younger years I was very keen on cricket. So if you could organise for me to have a coffee with Sir Garfield Sobers (otherwise known as Gary) that would be brilliant!

How do you relax outside of work?

Outside of work I have all sorts of interests, some of which are not very relaxing! I do a lot of work with the church I belong to, I find gardening therapeutic, go on walks with my wife, visits or cycle rides, I enjoy holidays and seeing new places.

ORDER OF SALE & *GUIDE PRICES

All guide prices are subject to additional non-optional fees, including the buyers administration fee. Please see Important Notices in the catalogue for a definition of Auction Fees.

LOT 1.	35 Mayfield Road, Chaddesden, Derby	£75,000+
LOT 2.	47 Trent Street, Alvaston, Derby	£50,000+
LOT 3.	Land adjoining 47 Trent Street, Alvaston, Derby	£50,000+
LOT 4.	29 Stenson Avenue, Sunnyhill, Derby	£77,000+
LOT 5.	8 Wellesley Avenue, Sunnyhill, Derby	£135,000+
LOT 6.	24 Bank Street, Castle Gresley, Swadlincote, Derbyshire	£50,000+
LOT 7.	37 Alma Road, Newhall, Swadlincote, Derbyshire	£65,000+
LOT 8.	1 Hawfinch, Wilnecote, Tamworth, Staffordshire	£120,000+
LOT 9.	10 Derby Road, Belper, Derbyshire	£90,000+
LOT 10.	24 Riversdale, Ambergate, Belper, Derbyshire	£135,000+
LOT 11.	22 Outram Street, Ripley, Derbyshire	£75,000+
LOT 12.	Flat 3 Knightsbridge Court, 3 Nottingham Road, Ripley, Derbyshire	£18,000+
LOT 13.	Garage 6, Eastfield Road, Ripley, Derbyshire	SOLD PRIOR
LOT 14.	98 The Common, South Normanton, Alfreton, Derbyshire	£75,000+
LOT 15.	Row of Four Lock-Up Garages, Town Street, Pinxton, Nottinghamshire	£14,000+
LOT 16.	4 Sharps Close, Kirk Hallam, Ilkeston, Derbyshire	£45,000+
LOT 17.	57 Bath Street, Ilkeston, Derbyshire	£73,000+
LOT 18.	1 Allington Lane, Foston, Grantham, Lincolnshire	£125,000+
LOT 19.	16a Bridgegate, Rotherham, South Yorkshire	£82,000+
LOT 20.	1 Osborne Street, Grimsby, Lincolnshire	£45,000+
LOT 21.	Former Co op Bank, 25-27 South St. Marys Gate, Grimsby, Lincolnshire	£70,000+
LOT 22.	97 Broadway East, Dormanstown, Redcar, North Yorkshire	£65,000+
LOT 23.	69 Main Street, Long Eaton, Nottinghamshire	£160,000+
LOT 24.	Plot 64 Land South of Pen-Y-Dre, off Rigwgarn Estate, Trebanog, Porth	£500+
LOT 25.	Plot 65 Land South of Pen-Y-Dre, off Rigwgarn Estate, Trebanog, Porth	£500+
LOT 26.	3 Springfield, Boston Spa, Wetherby, West Yorkshire	£185,000+
LOT 27.	33 Glebe Road, Skelmersdale, Lancashire	£38,000+
LOT 28.	The Oval, Harrogate, North Yorkshire	£20,000+
LOT 29.	15 Hyacinth Close, Tollesbury, Maldon, Essex	SOLD PRIOR
LOT 30.	16 Hazeldene Close, Ivybridge, Devon	£87,000+
LOT 31.	32 Loudon Street, Derby	£128,000+
LOT 32.	2 Camden Street, Derby	£140,000+
LOT 33.	62-64 Thanet Street, Clay Cross, Chesterfield, Derbyshire	£68,000+
LOT 34.	Former Crown Inn, Nottingham Road, Spondon, Derby	£195,000+
LOT 35.	36 Moor Street, Spondon, Derby	£59,000+
LOT 36.	Land at Rose Avenue, Clay Mills, Burton on Trent, Staffordshire	£210,000+
LOT 37.	25 Tower Road, Hartshorne, Swadlincote, Derbyshire	£165,000+
LOT 38.	162 Blenheim Drive, Allestree, Derby	£195,000+
LOT 39.	9a Cornhill, Allestree, Derby	£230,000+
LOT 40.	Wildersley, Wildersley Road, off Holbrook Road, Belper, Derbyshire	£550,000+
LOT 41.	Belper Adult Community Education Centre, Holbrook Road, Belper, Derbyshire	£250,000+
LOT 42.	5 South Avenue, Littleover Village, Derby	£275,000+
LOT 43.	1 Wood Street, Derby, Derbyshire	£65,000+



SDLAUCTIONS

— GRAHAM PENNY —

DEPOSITS

Important Information

All properties are subject to a 10% deposit* (subject to a £5000 minimum deposit) which is payable on the exchange of contracts.

Deposits can be paid by debit card or bankers draft.

There is also a buyers administration fee or reservation fee to pay on exchange. An explanation of additional fees can be found overleaf.

***Unless stated otherwise in the legal pack.**

NO LONGER ACCEPTING CHEQUES

All deposits must be paid by:-



**Bank/Building
Society Draft**



Debit Card

**As an extra safeguard to our
vendors we NO longer
accept any cheques.**

**To benefit all purchasers there will be
no card charges for payments made
by debit card.**

www.sdlauctions.co.uk

A GUIDE TO ADDITIONAL FEES

Important notice relating to fees, costs and charges payable by the buyer in addition to the purchase price

BUYERS ADMINISTRATION FEE

All buyers will be required to pay a Buyers Administration Fee of £1074 inc VAT (unless otherwise stated in the important notices or where a reservation fee is applicable) payable on each lot purchased whether purchasing prior, during or after the auction.

ADDITIONAL FEES, COSTS AND CHARGES

In addition to the purchase price, buyers may be required to pay additional fees, costs and charges. These may include, but are not limited to, Value Added Tax (VAT), Stamp Duty, ground rents, rent arrears/apportionment of rent, outstanding service charges, sellers search costs/disbursements, reimbursements of sellers solicitors, auctioneer costs or reservation fees. All prospective buyers are advised to inspect the legal documents including the contract and special conditions and seek their own independent legal advice as to the full cost of purchasing a specific property.

All bidders are assumed to have inspected the legal packs available on our website – www.sdlauctions.co.uk – and in the auction room prior to bidding and are fully aware of all terms and conditions including any fees, costs, charges, completion dates and other relevant matters which may be applicable, once they have successfully purchased the property.

FOR FURTHER INFORMATION

If you have any questions about a lot you would like to bid on, please contact the team on 01332 242 880 or email at derby@sdlauctions.co.uk

UNCONDITIONAL & CONDITIONAL AUCTIONS EXPLAINED

U Unconditional

Upon the fall of the hammer the buyer shall...

- Be legally bound to buy the property
- Pay a 10% deposit, subject to a minimum of £5,000 (this will contribute towards the purchase price)
- Pay a buyers administration fee of £1074 including VAT (unless an alternative administration fee has been quoted in the important notices to bidders at the front of the catalogue)
- Please note additional charges may apply and these will be included in the special conditions of sale, which are available in the legal pack
- Exchange contracts on the fall of the hammer and sign the special conditions of sale held with the auctioneer or solicitor
- Complete the purchase within 28 days (unless an alternative date has been specified in the special conditions of sale)

Please note all lots in this catalogue are being sold subject to unconditional terms unless otherwise stated (and showing the UR or CR icon).

UR Unconditional Reservation Fee

Upon the fall of the hammer the buyer shall...

- Be legally bound to buy the property
- Pay a 5% deposit, subject to a minimum of £5,000 (this will contribute towards the purchase price)
- Pay a reservation fee of 4.8% including VAT or 4.2% including VAT in London, subject to a minimum of £6,000 including VAT. The reservation fee does not contribute towards the purchase price.
- Exchange contracts on the fall of the hammer and sign the special conditions of sale held with the auctioneer or solicitor
- Complete the purchase within 28 days (unless an alternative date has been specified in the special conditions of sale)

CR Conditional Reservation Fee

Upon the fall of the hammer the buyer shall...

- Pay a reservation fee of 4.8% including VAT or 4.2% including VAT in London, subject to a minimum of £6,000 including VAT. The reservation fee does not contribute towards the purchase price.
- Sign the reservation contract with the auctioneer
- Exchange contracts within 28 days
- Complete the purchase within an additional 28 days of the exchange (unless an alternative date has been specified in the reservation contract)

*The reservation fee represents a different set of charges to the regular auction lots. A reservation fee is payable by the buyer where a seller has opted to sell with no fees. However, as a result, a lower reserve price is usually agreed. The reservation fee does not contribute toward the purchase price.

Please ensure you understand the difference between conditional and unconditional auctions (and which type of auction you are bidding on), the associated costs and your legal obligation. If you are unsure or have any questions please contact one of our auction specialists or speak to a member of staff on the day before bidding.

Please note ALL fees and deposits are non-refundable

SDL AUCTIONS

www.sdlauctions.co.uk

LOT 1

35 MAYFIELD ROAD, CHADDESSEN, DERBY DE21 6FX

SET ON A DEEP LEVEL PRIVATE PLOT IS A TWO BEDROOMED DETACHED BUNGALOW REQUIRING UPGRADING AND OFFERING THE POTENTIAL FOR A SEPARATE BUILDING PLOT (SUBJECT TO THE USUAL PLANNING CONSENTS).

PROPERTY DESCRIPTION:

The bungalow itself has uPVC double glazing, gas central heating and is surrounded by similar style properties in a popular residential location conveniently positioned for Chaddesden shopping centre and also within short commute of the city centre and the A52. Excellent investment opportunity.

ACCOMMODATION:

Ground Floor: Side porch, inner hall, rear sitting room, breakfast kitchen room, conservatory, two bedrooms, bathroom.

Outside: Garden to the front with an adjacent driveway leading to a single detached garage. To the rear there is a well stocked enclosed private garden.

ENERGY EFFICIENCY RATING: Awaited

TENURE: Freehold

VACANT POSSESSION UPON COMPLETION

VIEWING:

Viewings can be booked online at www.sdlauctions.co.uk

***GUIDE PRICE £75,000+ (plus fees)**



LOT 2

47 TRENT STREET, ALVASTON, DERBY DE24 8RY

A STRUCTURALLY DETACHED TWO/THREE BEDROOMED END TERRACED PROPERTY REQUIRING UPGRADING AND IMPROVEMENT.

PROPERTY DESCRIPTION:

The extensively uPVC double glazed living accommodation is situated within short level walking distance of numerous shopping parades and is in short commute of Pride Park, the A52 and the M1 motorway. Excellent investment opportunity.

ACCOMMODATION:

Ground Floor: Lounge, inner lobby, dining room, kitchen, bathroom.

First Floor: Landing, three bedrooms.

Outside: Enclosed garden to the rear.

ENERGY EFFICIENCY RATING: F

TENURE: Freehold. **VACANT POSSESSION UPON COMPLETION**

VIEWING:

Viewings can be booked online at www.sdlauctions.co.uk

***GUIDE PRICE £50,000+ (plus fees)**



If you can't make the auction room, you can bid on the telephone, by proxy or online.

See the form at the back of this catalogue.

LOT 3

LAND ADJOINING 47 TRENT STREET, ALVASTON, DERBY DE24 8RY

PARCEL OF LAND WITH OUTLINE CONSENT FOR TWO DWELLINGS.

PROPERTY DESCRIPTION:

A residential investment opportunity to acquire a parcel of land with outline planning permission (DER/08/17/01053) for the approval for two dwellings situated on a generous sized level plot situated within walking distance of a number of shopping parades and easy reach of Pride Park.

TENURE: Freehold

VACANT POSSESSION UPON COMPLETION

VIEWING:

Viewings can be booked online at www.sdlauctions.co.uk



***GUIDE PRICE £50,000+ (plus fees)**

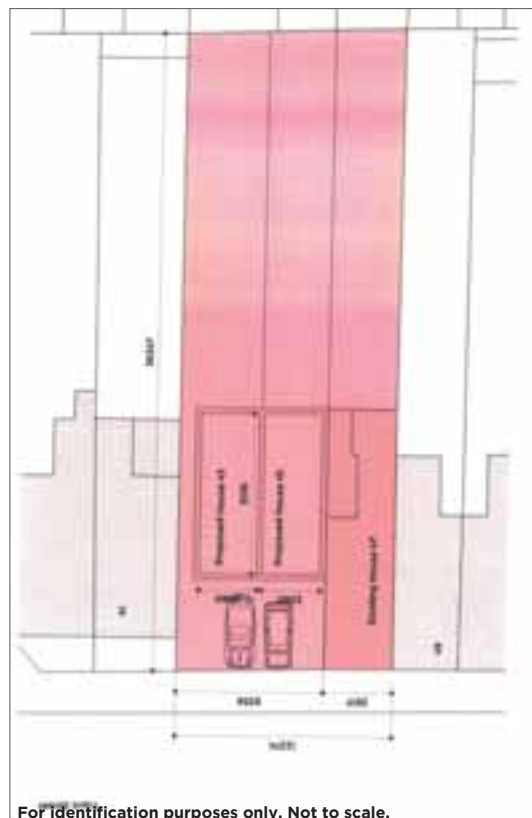

For identification purposes only. Not to scale.

LOT 4

29 STENSON AVENUE, SUNNYHILL, DERBY DE23 1LD

ENJOYING A WELL REGARDED RESIDENTIAL LOCATION IS A TRADITIONALLY BUILT TWO DOUBLE BEDROOMED SEMI-DETACHED HOUSE REQUIRING A DEGREE OF MODERNISATION AND IMPROVEMENT.

PROPERTY DESCRIPTION:

The property benefits from double glazing and is mostly gas centrally heated. It is situated within walking distance of local shops, primary school and a regular bus service. Excellent freehold investment opportunity.

ACCOMMODATION:

Ground Floor: Entrance hall, sitting room, dining room, kitchen.

First Floor: Landing, two bedrooms, shower room.

Outside: Double gates to the front lead to a driveway providing off road parking and a low maintenance garden. To the rear there is a garden which tapers down to a point.

ENERGY EFFICIENCY RATING: D

TENURE: Freehold

VACANT POSSESSION UPON COMPLETION

VIEWING:

Viewings can be booked online at www.sdlauctions.co.uk

***GUIDE PRICE £77,000+ (plus fees)**





AN EXCELLENT OPPORTUNITY TO ACQUIRE A TWO/THREE BEDROOMED DOUBLE FRONTED DETACHED BUNGALOW SITUATED ON A WIDER THAN AVERAGE PLOT OFFERING POTENTIAL TO EITHER BE SPLIT INTO TWO PROPERTIES OR EXTENDED (STPC).

PROPERTY DESCRIPTION:

The property requires a degree of modernisation and improvement and is mostly double glazed and gas centrally heated. It is situated in the context of an established and highly sought residential location. Excellent investment opportunity,

ACCOMMODATION:

Ground Floor: Entrance hall, full depth lounge, dining room/occasional guest bedroom three, kitchen, rear porch/utility, inner hallway, two bedrooms, bathroom.

Outside: Wider than average frontage with low maintenance fore garden, driveway and garage. To the rear there are low maintenance gardens and to the side there is a parcel of land offering development potential (stpc).

ENERGY EFFICIENCY RATING: E

TENURE: Freehold

VACANT POSSESSION UPON COMPLETION

VIEWING:

Viewings can be booked online at www.sdlauctions.co.uk

***GUIDE PRICE £135,000+ (plus fees)**



For identification purposes only. Not to scale.

**Pre-approved
decisions.
In the room.
In minutes.**

Our lowest ever
monthly rate from
0.49%*
a month,
with no exit fees.

When you spot a property you just can't resist,
it pays to know exactly what you can afford
to bid. Get a free pre-approval decision online,
over the phone or even in the auction room.

**Call 0333 4553 492 or visit
togethernessmoney.com/preapproval**

*Other fees and charges apply and are variable based on the loan amount.
0.49% pm is applicable for the duration of the loan. 12 months as standard.
No exit fee applies. Standard construction only. Any property used as security,
including your home, may be repossessed if you do not keep up on repayments
on a mortgage or any other debt secured on it.

together.

LOT 6

24 BANK STREET, CASTLE GRESLEY, SWADLINCOTE, DERBYSHIRE DE11 9LB

A THREE BEDROOMED SEMI-DETACHED HOUSE IN NEED OF REFURBISHMENT OCCUPYING A PLEASANT CUL-DE-SAC LOCATION ON THE FRINGE OF CASTLE GRESLEY.

PROPERTY DESCRIPTION:

The property has the benefit of gas central heating and is mostly uPVC double glazed and there is potential for an extension (stpc). The property enjoys a well regarded location with nearby woodlands, excellent road network connections and regular bus service to Swadlincote town centre and Burton. Excellent investment opportunity.

ACCOMMODATION:

Ground Floor: Entrance hall, kitchen, full width rear sitting room, conservatory.

First Floor: Landing, three bedrooms, bathroom.

Outside: The property is set back from the road with fore garden and an adjacent driveway provides useful car standing space. To the rear there is a good sized enclosed garden with potential for an extension (stpc).

ENERGY EFFICIENCY RATING: Awaited

TENURE: Freehold

VACANT POSSESSION UPON COMPLETION

VIEWING:

Viewings can be booked online at www.sdlauctions.co.uk

***GUIDE PRICE £50,000+ (plus fees)**



LOT 7

37 ALMA ROAD, NEWHALL, SWADLINCOTE, DERBYSHIRE DE11 0SD

A PARTICULARLY WELL LOCATED THREE BEDROOMED MID-TERRACED PROPERTY REPRESENTING AN EXCELLENT BUY-TO-LET INVESTMENT OPPORTUNITY.

PROPERTY DESCRIPTION:

The property is well equipped and benefits from uPVC double glazing and gas central heating. Excellent freehold investment opportunity.

ACCOMMODATION:

Ground Floor: Lounge through diner, kitchen, bathroom.

First Floor: Landing, three bedrooms.

Outside: Patio area to the rear with an external utility room and a nicely presented landscaped garden.

ENERGY EFFICIENCY RATING: F

TENURE: Freehold

VACANT POSSESSION UPON COMPLETION

VIEWING:

Viewings can be booked online at www.sdlauctions.co.uk

***GUIDE PRICE £65,000+ (plus fees)**



LOT 8

1 HAWFINCH, WILNECOTE, TAMWORTH, STAFFORDSHIRE B77 5NU

A THREE BEDROOMED SEMI-DETACHED HOUSE REQUIRING IMPROVEMENT AND UPGRADING SITUATED IN A VERY POPULAR RESIDENTIAL LOCATION.

PROPERTY DESCRIPTION:

The property is mostly uPVC double glazed and gas centrally heated and offers excellent potential.

ACCOMMODATION:

Ground Floor: Entrance hall, generous sized front sitting room, full width rear kitchen diner, full width conservatory/garden room.

First Floor: Landing, three bedrooms, bathroom.

Outside: Fore garden with adjacent driveway leading to single garage. Good sized enclosed rear garden.

ENERGY EFFICIENCY RATING: D

TENURE: Freehold

VACANT POSSESSION UPON COMPLETION

VIEWING:

Viewings can be booked online at www.sdlauctions.co.uk



***GUIDE PRICE £120,000+ (plus fees)**

Turbo Charge Your Property Investing At Your Local Property Network

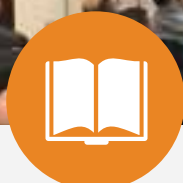

Knowledge

Know more, do more. Simple!

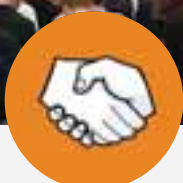

Support

Friendly & Experienced Peers!

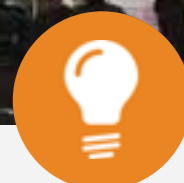

Mindset

Old ways don't open new doors

The property investors network (pin) hold 50 monthly meetings nationwide for new and experienced investors.

Come and join us each month, Registration & Networking between 6 & 7pm. Meetings run from 7 to 9pm.

1st Thursday - Birmingham Central (Novotel Broad St)

1st Thursday - Leicester (The Fieldhead Hotel)

2nd Thursday - Chester (Mercure Chester)

3rd Tuesday - Nottingham (Park Inn by Radisson Nottingham)

3rd Wednesday - Manchester (Best Western Cresta Hotel)

3rd Thursday - Birmingham NEC (Crowne Plaza)

Attend as our complimentary guest* by visiting www.pinmeeting.co.uk

USE PROMO CODE

SDL

*First meeting only, usual price £20.
Book 72 hours in advance to enter into the monthly prize draw.

For more info visit: www.propertyinvestorsnetwork.co.uk



A UNIQUE AND RARE OPPORTUNITY TO ACQUIRE AN ATTRACTIVE STONE BUILT TWO BEDROOMED GRADE II LISTED PERIOD PROPERTY SITUATED WITHIN LITERALLY YARDS OF BELPER TOWN CENTRE.

PROPERTY DESCRIPTION:

The character accommodation requires a scheme of improvement and upgrading. There may well be potential for an extension or the opportunity to run a small business (stpc).

The property is located adjacent to Babington Hospital and positioned along the main A6 arterial road which provides a short to the spa town of Matlock, Chatsworth House and the City of Derby lies approximately 8 miles to the south. Excellent investment opportunity.

ACCOMMODATION:

Ground Floor: Front sitting room, two bedrooms, inner lobby, large pantry, breakfast kitchen, side hall/utility room.

Outside: Driveway to the side and we are informed by the seller that there is a right of way and with vehicular access leading to an enclosed rear garden. The plot is broadly rectangular with stone boundary walls and a range of specimen trees that offer a certain degree of privacy.

ENERGY EFFICIENCY RATING: G

TENURE: Freehold

VACANT POSSESSION UPON COMPLETION

VIEWING:

Viewings can be booked online at www.sdlauctions.co.uk

***GUIDE PRICE £90,000+ (plus fees)**



LOT 10

24 RIVERSDALE, AMBERGATE, BELPER, DERBYSHIRE DE56 2EU

A PARTICULARLY WELL LOCATED DOUBLE FRONTED THREE DOUBLE BEDROOMED SEMI-DETACHED HOUSE REQUIRING A MINOR SCHEME OF IMPROVEMENTS AND OFFERING POTENTIAL TO CONVERT TO TWO DWELLINGS (STPC).

PROPERTY DESCRIPTION:

The versatile and extremely well equipped living accommodation has the benefit of sealed unit uPVC double glazing and gas central heating and is positioned along the A610 near the historic and picturesque village of Crich and situated within some beautiful wooded Derbyshire countryside. Excellent investment opportunity.

ACCOMMODATION:

Ground Floor: Side entrance hall, extended kitchen diner, side lobby, walk-in pantry, guest wc, dining room, front sitting room, shower room/utility.

First Floor: Landing, three bedrooms, spacious family bathroom.

Outside: Low maintenance fore garden with pedestrian access leading to a good sized enclosed low maintenance tiered garden.

ENERGY EFFICIENCY RATING: D

TENURE: Freehold

VACANT POSSESSION UPON COMPLETION

VIEWING:

Viewings can be booked online at www.sdlauctions.co.uk

***GUIDE PRICE £135,000+ (plus fees)**



LOT 11

22 OUTRAM STREET, RIPLEY, DERBYSHIRE DE5 3LF

OCCUPYING A PROMINENT DEEP CORNER PLOT IS A THREE DOUBLE BEDROOMED STRUCTURALLY DETACHED DOUBLE FRONTED PROPERTY REQUIRING IMPROVEMENT AND UPGRADING.

PROPERTY DESCRIPTION:

Constructed of traditional brick beneath a pitched slate roof, the character accommodation has the benefit of uPVC double glazing and enjoys a popular location conveniently positioned for the town centre and within a short commute of the A38, which provides swift access onto the city of Derby, M1 motorway and further regional business centres. Excellent investment opportunity.

ACCOMMODATION:

Ground Floor: Side entrance hall, full width front sitting room, separate dining room, kitchen, pantry.

First Floor: Galleried style landing, three double bedrooms, bathroom.

Outside: Small forecourt and boundary hedge wraps round to the side where there is further lawned garden, off road parking and single detached garage. We feel there is potential for an extension (stpc).

ENERGY EFFICIENCY RATING: G

TENURE: Freehold

VACANT POSSESSION UPON COMPLETION

VIEWING:

Viewings can be booked online at www.sdlauctions.co.uk

***GUIDE PRICE £75,000+ (plus fees)**



LOT 12

FLAT 3 KNIGHTSBRIDGE COURT, 3 NOTTINGHAM ROAD, RIPLEY, DERBYSHIRE DE5 3LA

LOCATED IN THE HEART OF RIPLEY TOWN CENTRE, IS A ONE BEDROOMED THIRD FLOOR FLAT IDEALLY SUITED TO A LANDLORD.

PROPERTY DESCRIPTION:

The flat is in need of refurbishment and is located within Ripley town centre which has an excellent range of amenities and provides swift access onto the M1 motorway and the City of Derby.

ACCOMMODATION:

Ground Floor: Communal entrance hall.

Third Floor: Passaged entrance hall, lounge, breakfast kitchen room, bedroom, bathroom.

ENERGY EFFICIENCY RATING: D

TENURE: Leasehold. **VACANT POSSESSION UPON COMPLETION**

VIEWING:

Viewings can be booked online at www.sdlauctions.co.uk

***GUIDE PRICE £18,000+ (plus fees)**



LOT 13

GARAGE 6, EASTFIELD ROAD, RIPLEY, DERBYSHIRE DE5 3JY

POSITIONED TOWARDS THE END OF THIS POPULAR CUL-DE-SAC LOCATION WITH ITS OWN GATED ACCESS.

DESCRIPTION:

A detached garage measuring 19'11" x 9'6" with up and over door to the front and door to the rear with land located to the front and rear of it. It provides excellent storage space at an attractive guide price.

TENURE: Freehold

VACANT POSSESSION UPON COMPLETION

VIEWING:

Viewings can be booked online at www.sdlauctions.co.uk

***GUIDE PRICE £3,000+ (plus fees)**



SDL AUCTIONS



**DOUBLE AWARD WINNER
AT THE 2018 EA MASTERS**

BEST LARGE SUPPLIER & BEST OVERALL SUPPLIER

LOT 14

98 THE COMMON, SOUTH NORMANTON, ALFRETON, DERBYSHIRE DE55 2EP

A LARGER THAN AVERAGE TWO DOUBLE BEDROOMED DETACHED RESIDENCE OFFERING THE POTENTIAL TO BE CONVERTED INTO A MULTIPLE OCCUPANCY OR FAMILY DWELLING BOTH SUBJECT TO THE USUAL PLANNING CONSENTS.

PROPERTY DESCRIPTION:

Internally the well proportioned living accommodation requires a comprehensive scheme of improvement and upgrading throughout. It is situated within the popular village of South Normanton which boasts local primary school, numerous independent shops, takeaways, public houses/restaurants and is well placed for the A38 and M1 motorway. The cities of Derby and Nottingham are both within a short commute. Excellent freehold investment opportunity.

ACCOMMODATION:

Ground Floor: Hall, lounge, dining room, fitted kitchen.

First Floor: Galleried landing, two double bedrooms, bathroom.

Outside: Small fore garden with gated access to the side leading to a nicely sized rear garden in need of attention.

ENERGY EFFICIENCY RATING: E

TENURE: Freehold

VACANT POSSESSION UPON COMPLETION

VIEWING:

Viewings can be booked online at www.sdlauctions.co.uk

***GUIDE PRICE £75,000+ (plus fees)**



LOT 15

ROW OF FOUR LOCK-UP GARAGES, TOWN STREET, PINXTON, NOTTINGHAMSHIRE NG16 6HH

A ROW OF FOUR SECTIONAL CONCRETE VACANT LOCK-UP GARAGES SITUATED WITHIN THE HEART OF AN ESTABLISHED RESIDENTIAL LOCATION.

PROPERTY DESCRIPTION:

Positioned at the end of a driveway to the rear of 31-39 Town Street, Pinxton, an excellent opportunity to acquire a row of secure single lock up garages of concrete construction with up and over doors, within a popular and established residential area where off street parking is limited. The Garages would also provide an excellent storage facility.

The garages are conveniently located within under half a mile from the main shops and amenities in Pinxton town centre.

The sale may represent an ideal purchase for an owner to compliment an existing property within the immediate area or as an investment for rental purposes.

TENURE: Freehold

VACANT POSSESSION UPON COMPLETION

VIEWING:

Viewings can be booked online at www.sdlauctions.co.uk

***GUIDE PRICE £14,000+ (plus fees)**



LOT 16

4 SHARPS CLOSE, KIRK HALLAM, ILKESTON, DERBYSHIRE DE7 4JB

A TWO DOUBLE BEDROOMED FIRST FLOOR FLAT REQUIRING MINOR IMPROVEMENTS AND SITUATED WITHIN WALKING DISTANCE OF KIRK HALLAM COMMUNITY ACADEMY. EXCELLENT BUY-TO-LET INVESTMENT OPPORTUNITY.

PROPERTY DESCRIPTION:

The property offers well proportioned living accommodation complemented by double glazing and is situated in the context of an established location always popular with first time buyers and landlords.

ACCOMMODATION:

First Floor: Entrance lobby with large walk-in cupboard, kitchen, sitting room, inner lobby, bedroom one, bedroom two/dining room, refitted bathroom.

Outside: There are outbuildings and steps leading to the front door.

ENERGY EFFICIENCY RATING: Awaited

TENURE: Leasehold

VACANT POSSESSION UPON COMPLETION

VIEWING:

Viewings can be booked online at www.sdlauctions.co.uk



***GUIDE PRICE £45,000+ (plus fees)**

LOT 17

57 BATH STREET, ILKESTON, DERBYSHIRE DE7 8AH

AN OPPORTUNITY TO ACQUIRE A GROUND FLOOR SHOP PREMISES LET ON A 5 YEAR LEASE FROM NOVEMBER 2016 PRODUCING AN ANNUAL INCOME OF £10,000 P.A.

PROPERTY DESCRIPTION:

The property is of brick construction with secure roller shutters to the front and is well located within the pedestrianised retail area in the heart of Ilkeston town centre.

The sale is for the ground floor only. The first and second floor accommodation belongs to the neighbouring property and is **NOT** included in the sale.

The business is a successfully family run hair and beauty salon and is located in the popular market town of Ilkeston approximately 8 miles from Nottingham and 10 miles from Derby. The unit is located on the prime pedestrianised retail pitch adjacent to Wilkos.

ACCOMMODATION:

Ground Floor: Retail area, beauty room, kitchen, wc.

Outside: Rear yard with fire escape access.

ENERGY EFFICIENCY RATING: D

TENURE: Freehold

SUBJECT TO TENANCY

VIEWING:

Viewings can be booked online at www.sdlauctions.co.uk

***GUIDE PRICE £73,000+ (plus fees)**





A VERY ATTRACTIVE THREE BEDROOMED SEMI-DETACHED COTTAGE WITH AN ADJOINING ONE BEDROOMED ANNEXE.

PROPERTY DESCRIPTION:

The main house and annexe are well appointed with electric heating, double glazing and stands on a sizeable plot. It is located in close proximity to the A1 and would lend itself as a B&B creating a potential income (stpc).

The market town of Grantham is a superbly located town set in the centre of a number of larger towns and cities including Nottingham, Lincoln, Boston, Spalding, Peterborough, Stamford and Leicester. The mainline train station in the town centre takes you to London Kings Cross in just over an hour.

ACCOMMODATION:

Ground Floor: Dining room, kitchen, rear hall, living room.

First Floor: Landing one, master bedroom, landing two, en-suite, dressing room, two further bedrooms, bathroom.

Annexe: Living/bedroom, shower room, separate wc, dining kitchen.

Outside: The property is approached by a gravel driveway giving off road parking for multiple cars and having hard standing ideal for a caravan/motor home or trailer. There are gardens to three sides which are mainly laid to lawn with hedge borders and inset patio area.

ENERGY EFFICIENCY RATING: G & F

TENURE: Freehold. **VACANT POSSESSION UPON COMPLETION**

VIEWING:

Viewings can be booked online at www.sdlauctions.co.uk

***GUIDE PRICE £125,000+ (plus fees)**



LOT 19

16A BRIDGEGATE, ROTHERHAM, SOUTH YORKSHIRE S60 1PQ

AN EXCELLENT OPPORTUNITY TO ACQUIRE A VACANT THREE STOREY PROPERTY WITH RETAIL ON THE GROUND FLOOR AND TWO FLOORS OF OFFICE SPACE ABOVE LOCATED WITHIN THE HEART OF ROTHERHAM TOWN CENTRE.

PROPERTY DESCRIPTION:

The ground floor retail unit includes staff WC's and storage space. The first and second floor offices are accessed via a separate doorway leading to an internal stairwell positioned to the right of the shop entrance.

The property would suit an owner occupier or investor with a commercial property portfolio or conversion to residential (stpc).

ACCOMMODATION:

Ground Floor: Not inspected by the auctioneers but believed to comprise 646 sq ft gross internal floor area and includes staff WC's and storage space.

First Floor: Main office, two further offices.

Second Floor: Kitchen.

Outside: Small rear yard to the rear accessed by the fire escape from the first and second floors.

ENERGY EFFICIENCY RATING: G

TENURE: Freehold

VACANT POSSESSION UPON COMPLETION

VIEWING:

Viewings can be booked online at www.sdlauctions.co.uk

***GUIDE PRICE £82,000+ (plus fees)**



LOT 20

1 OSBORNE STREET, GRIMSBY, LINCOLNSHIRE DN31 1EY

VACANT FREEHOLD TWO STOREY PREMISES IN HIGH STREET LOCATION.

DESCRIPTION:

The auctioneers have not inspected the accommodation but believe it to extend to 1,200 square feet and comprise a ground floor retail unit (570 sq ft) and vacant upper floors (630 sq ft) with own separate entrance door from the high street. Additional rear pedestrian access/fire escape to rear.

ENERGY EFFICIENCY RATING: Awaited

TENURE: Freehold. **VACANT POSSESSION UPON COMPLETION**

VIEWING:

Viewings can be booked online at www.sdlauctions.co.uk



***GUIDE PRICE £45,000+ (plus fees)**



LOT 21

FORMER CO OP BANK, 25-27 SOUTH ST. MARYS GATE, GRIMSBY, LINCOLNSHIRE DN31 1JE

LARGE VACANT FREEHOLD TWO STOREY FORMER BANK PREMISES IN HIGH STREET LOCATION. EXCELLENT OPPORTUNITY.

DESCRIPTION:

The auctioneers have not inspected the accommodation and understand it to extend to approx 5,234 square feet and comprises ground floor former banking hall with offices and safe. Vacant upper floors comprising offices, kitchen, wc's. Loading bay with vehicular access to side and rear pedestrian access/fire escape to rear.

ENERGY EFFICIENCY RATING: C

TENURE: Freehold. **VACANT POSSESSION UPON COMPLETION**

VIEWING:

Viewings can be booked online at www.sdlauctions.co.uk



***GUIDE PRICE £70,000+ (plus fees)**

LOT 22

97 BROADWAY EAST, DORMANSTOWN, REDCAR, NORTH YORKSHIRE TS10 5DT

A THREE BEDROOMED SEMI-DETACHED HOUSE REQUIRING COSMETIC UPGRADING.

PROPERTY DESCRIPTION:

The property benefits from double glazing and electric storage heating and requires cosmetic improvement. It is located in an ideal location within Redcar, just a short walk from amenities, Redcar Central Station and the sea front.

ACCOMMODATION:

The auctioneers have not inspected the property but believe it to comprise -

Ground Floor: Entrance hall, lounge, kitchen.

First Floor: Landing, three bedrooms, bathroom.

Outside: Off road parking to front. Garden to rear

ENERGY EFFICIENCY RATING: Awaited

TENURE: Freehold

VACANT POSSESSION UPON COMPLETION

VIEWING:

Viewings can be booked online at www.sdlauctions.co.uk



***GUIDE PRICE £65,000+ (plus fees)**

LOT 23

69 MAIN STREET, LONG EATON, NOTTINGHAMSHIRE NG10 1GW

AN EXCELLENT OPPORTUNITY TO ACQUIRE A VACANT RECENTLY REFURBISHED RESIDENTIAL AND RETAIL MIXED USE PROPERTY ARRANGED OVER THREE FLOORS WITHIN LONG EATON TOWN CENTRE.

PROPERTY DESCRIPTION:

The retail unit was previously a takeaway, which has recently been refurbished and made ready for re-occupation subject to some light finishing works. All three apartments have been refurbished throughout to a good standard with bathrooms and kitchens largely installed, again subject to some light finishing works. There are double glazed windows installed throughout the property.

ACCOMMODATION:

Ground Floor: Retail - 37.48m² (403sq ft). Apartment - Kitchen/living/diner, bathroom, bedroom.

First Floor: Apartment - Kitchen/living/diner, bathroom, bedroom.

Second Floor: Apartment - Kitchen/living/diner, bathroom, bedroom.

ENERGY EFFICIENCY RATING: Awaited

TENURE: Freehold. **VACANT POSSESSION UPON COMPLETION**

VIEWING:

Viewings can be booked online at www.sdlauctions.co.uk

***GUIDE PRICE £160,000+ (plus fees)**



LOT 24

PLOT 64 LAND SOUTH OF PEN-Y-DRE, OFF RIGWGARN ESTATE, TREBANOG, PORTH CF39 9DJ

A PARCEL OF LAND FORMING PART OF A MUCH LARGER SITE.

PROPERTY DESCRIPTION:

A parcel of land forming part of a much larger site. The land may be suitable for a variety of different uses, subject to obtaining the relevant planning consents. We have been informed that there are no overage restrictions on the land. We believe the plot will have access by foot over the rights of way, please see legal pack. Buyers should make their own further enquiries regarding obtaining any necessary planning consents and access.

The auctioneers have not inspected the land.

TENURE: Freehold. **VACANT POSSESSION ON COMPLETION**

VIEWING:

Direct on site.

***GUIDE PRICE £500+ (plus fees)**



LOT 25

PLOT 65 LAND SOUTH OF PEN-Y-DRE, OFF RIGWGARN ESTATE, TREBANOG, PORTH CF39 9DJ

A PARCEL OF LAND FORMING PART OF A MUCH LARGER SITE

PROPERTY DESCRIPTION:

A parcel of land forming part of a much larger site. The land may be suitable for a variety of different uses, subject to obtaining the relevant planning consents. We have been informed that there are no overage restrictions on the land. We believe the plot will have access by foot over the rights of way, please see legal pack. Buyers should make their own further enquiries regarding obtaining any necessary planning consents and access.

The auctioneers have not inspected the land.

TENURE: Freehold. **VACANT POSSESSION UPON COMPLETION**

VIEWING:

Direct on site.

***GUIDE PRICE £500+ (plus fees)**



FOR YOUR FREE
MARKET APPRAISAL
GET IN TOUCH!

CENTURY 21SM

Derby

SALES OR LETTINGS

WE HAVE YOU COVERED!*

Speak to our experts at Century 21 Derby

01332 242923

E derby@century21uk.com **W** www.century21uk.com

2-6 The Strand | Derby | DE1 1BA

*Special offers available to auction clients – quote 'auction18'

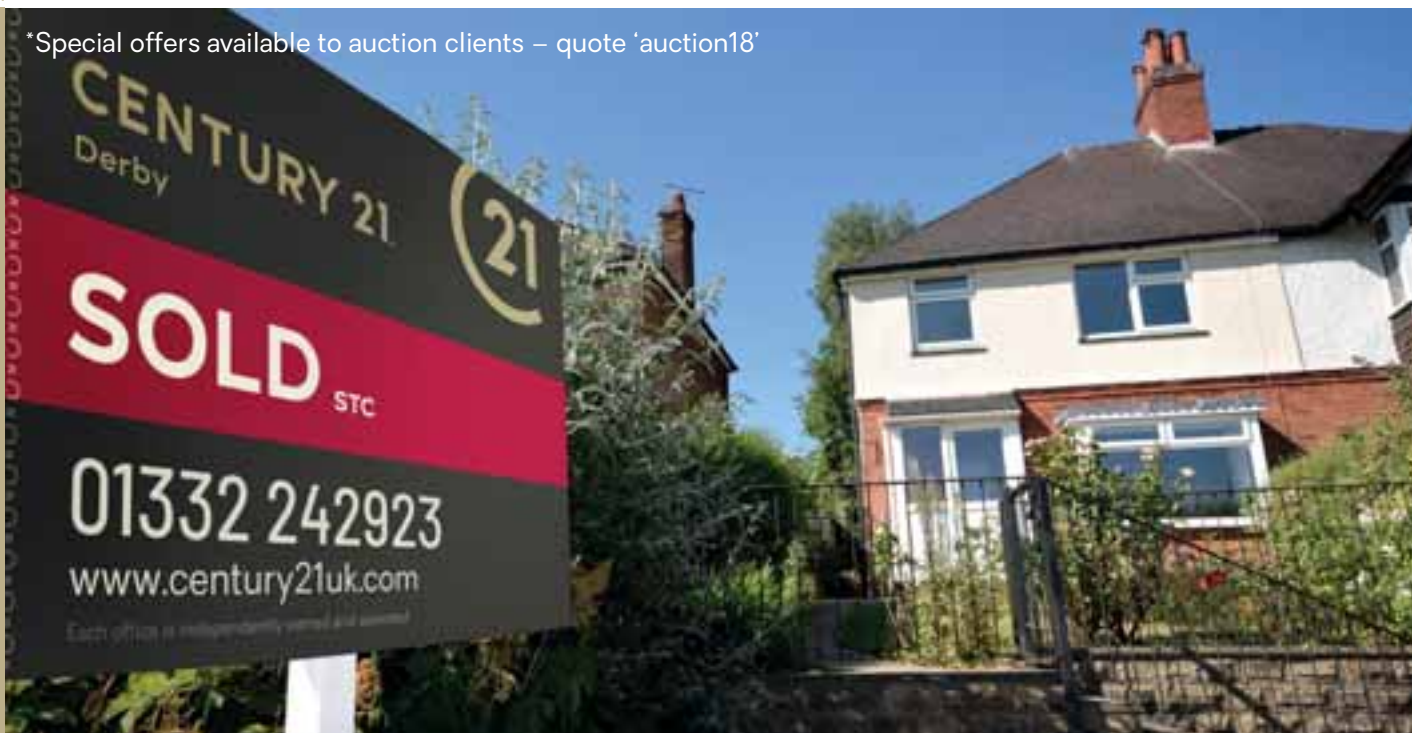

LOT 26

3 SPRINGFIELD, BOSTON SPA, WETHERBY, WEST YORKSHIRE LS23 6EB

A THREE BEDROOMED DETACHED COTTAGE LOCATED IN THE QUIET VILLAGE OF BOSTON SPA.

PROPERTY DESCRIPTION:

The property benefits from gas central heating and double glazing and is in need of need of a scheme of improvement.

ACCOMMODATION:

The auctioneers have not inspected the property but believe it to comprise:

Ground Floor: Lounge, kitchen diner, shower room.

First Floor: Three bedrooms.

Outside: Courtyard garden to the front with driveway providing off-street parking. Paved yard to the rear.

ENERGY EFFICIENCY RATING: E

TENURE: See Legal Pack

VACANT POSSESSION UPON COMPLETION

VIEWING:

Viewings can be booked online at www.sdlauctions.co.uk









***GUIDE PRICE £185,000+ (plus fees)**

MORTGAGE & FINANCE ARENA
Independent Mortgage & Finance Advice

finances to grow by

Tailored personal & business
mortgage solutions, protection & advice

-  Auction Finance
-  Residential Mortgages
-  Commercial Mortgages
-  Buy to let mortgages
-  Development Finance
-  Land Finance
-  Finance for properties that are not habitable

Speak to an expert today on 01332 300 300

or visit us at mortgageandfinancearena.co.uk   

Mortgage and Finance Arena Ltd is authorised and regulated by the Financial Conduct Authority and is entered on the FCA register under 706676. A mortgage is a loan secured against your home. You may be repossessed if you do not keep up repayments on your mortgage or any other debt secured on it. Think carefully before securing other debts against your home.

Mortgage and Finance Arena Limited is authorised and regulated by the Financial Conduct Authority. Registered in England and Wales. Company Registration Number 09490530. 16a, Enterprise Business Park, Prime Park Way, Derby DE1 3QB

LOT 27

33 GLEBE ROAD, SKELMERSDALE, LANCASHIRE WN8 9JP

A TWO BEDROOMED END OF TERRACE PROPERTY IN NEED OF MODERNISATION AND IMPROVEMENT.

PROPERTY DESCRIPTION:

The property benefits from gas central heating and double glazing and is located in a popular residential location.

ACCOMMODATION:

The auctioneers have not inspected the property but believe it to comprise -

Ground Floor: Lounge, kitchen.

First Floor: Two bedrooms, bathroom.

Outside: Front and rear gardens.

ENERGY EFFICIENCY RATING: Awaited

TENURE: Leasehold. **VACANT POSSESSION UPON COMPLETION**

VIEWING:

Viewings can be booked online at www.sdlauctions.co.uk

***GUIDE PRICE £38,000+ (plus fees)**



For identification purposes only. Not to scale.

LOT 28

THE OVAL, HARROGATE, NORTH YORKSHIRE HG2 9BA

A VALUABLE SITE OF AMENITY LAND KNOWN AS THE OVAL GARDENS, PART OF THE WEST END PARK (ESTATE).

DESCRIPTION:

The West End Park (Estate) is a Harrogate conservation area and the 4.5 acres of gardens were established as amenity gardens for residents in the 1890s, although the gardens are in fact privately owned. They are a haven for wildlife within the town.

LOCATION:

The Oval Gardens are located in the West End Park, a Harrogate conservation area which lies between Otley Road and Leeds Road, Harrogate. The gardens consist of 4 discreet areas surrounding The Oval.

TENURE: Freehold. **VACANT POSSESSION UPON COMPLETION**

VIEWING:

Direct on site.

***GUIDE PRICE £10,000+ (plus fees)**



LOT 29

15 HYACINTH CLOSE, TOLLESBURY, MALDON, ESSEX CM9 8XQ

A THREE BEDROOMED SEMI-DETACHED HOUSE.

PROPERTY DESCRIPTION:

The property is located within a cul-de-sac and benefits from a driveway to the side leading to a rear garage together with front and rear gardens.

ACCOMMODATION:

The auctioneers have not inspected the property but believe the accommodation to comprise:-

Ground Floor: Lounge, dining kitchen.

First Floor: Three bedrooms, bathroom.

Outside: Gardens to front and rear. Driveway providing off road parking.

ENERGY EFFICIENCY RATING: E

TENURE: Freehold. **VACANT POSSESSION UPON COMPLETION**

VIEWING:

Viewings can be booked online at www.sdlauctions.co.uk

***GUIDE PRICE £175,000+ (plus fees)**



LOT 30

16 HAZELDENE CLOSE, IVYBRIDGE, DEVON PL21 9EL

A FIRST FLOOR COACH HOUSE ENJOYING OPEN COUNTRY VIEWS AND OFFERING GOOD SIZED ACCOMMODATION.

PROPERTY DESCRIPTION:

The property benefits from PVC double glazing and electric night storage heaters and has a small garden, under house store and good sized garage.

ACCOMMODATION:

The auctioneers have not inspected the property but believe it to comprise –

First Floor: L-shaped hallway, lounge, kitchen, bathroom, bedroom.

Outside: Small garden, under house store and good sized garage.

ENERGY EFFICIENCY RATING: E

TENURE: See Legal Pack. **VACANT POSSESSION UPON COMPLETION**

VIEWING:

Viewings can be booked online at www.sdlauctions.co.uk

***GUIDE PRICE £87,000+ (plus fees)**



LOT 31

32 LOUDEN STREET, DERBY DE23 8ES

A FREEHOLD INVESTMENT OPPORTUNITY TO ACQUIRE A VERY SUBSTANTIAL MIXED COMMERCIAL/RESIDENTIAL TWO STORIED EXTENDED PROPERTY WITH ACCOMMODATION ARRANGED OVER THREE FLOORS.

PROPERTY DESCRIPTION:

The property was formerly used as a social club and has a large three bedroomed flat above and may well lend itself to a variety of different uses (stpc). It is located opposite the arboretum and enjoys a quiet yet convenient and established residential location.

ACCOMMODATION:

Ground Floor: Entrance hall, seating/bar area, rear room one, rear room two, games room.

First Floor: Landing, kitchen, utility room, living area, bathroom, two bedrooms, loft bedroom.

ENERGY EFFICIENCY RATING: D

TENURE: Freehold

VACANT POSSESSION UPON COMPLETION

VIEWING:

Viewings can be booked online at www.sdlauctions.co.uk

***GUIDE PRICE £128,000+ (plus fees)**



Join our email alert list

Thousands of people are already receiving updates by email.

Sign up today by visiting www.sdlauctions.co.uk/receive-our-updates

LOT 32

2 CAMDEN STREET, DERBY DE22 3NR

AN EXCELLENT OPPORTUNITY TO ACQUIRE A VACANT, TWO STOREY PREMISES FORMALLY USED AS A FAST FOOD TAKEAWAY ON THE GROUND FLOOR WITH SPACIOUS THREE BED RESIDENTIAL ACCOMMODATION ABOVE.

PROPERTY DESCRIPTION:

The building has recently been refurbished throughout including gas central heating and double glazed windows and would suit anyone wanting to run a commercial business with living accommodation. Alternatively, it is ready for immediate occupation for lettings purposes for investors with retail and/or residential portfolios.

ACCOMMODATION:

Ground Floor: Main retail area, retail kitchen/prep area, residential kitchen.

First Floor: Three bedrooms, family bathroom.

Outside: Small rear yard with outdoor wc and store.

ENERGY EFFICIENCY RATING: F & E

TENURE: Freehold

VACANT POSSESSION UPON COMPLETION

VIEWING:

Viewings can be booked online at www.sdlauctions.co.uk

***GUIDE PRICE £140,000+ (plus fees)**



For identification purposes only. Not to scale.

LOT 33

62-64 THANET STREET, CLAY CROSS, CHESTERFIELD, DERBYSHIRE S45 9JU

AN EXCELLENT OPPORTUNITY TO ACQUIRE A DEVELOPMENT SITE WITH FULL PLANNING CONSENT FOR 2 X TWO BEDROOMED BUNGALOWS.

PROPERTY DESCRIPTION:

The site is situated under a mile from all the main shops and amenities in Clay Cross Town Centre and was used previously used as a function room to the rear of Bestwood working men's club. The main club building itself has recently been converted into four apartments all of which are fully let.

The planning application and drawings can be viewed at North East Derbyshire planning department, Planning ref: 18/00863/FL.

TENURE: Freehold

VACANT POSSESSION UPON COMPLETION

VIEWING:

Direct on site.

***GUIDE PRICE £68,000+ (plus fees)**



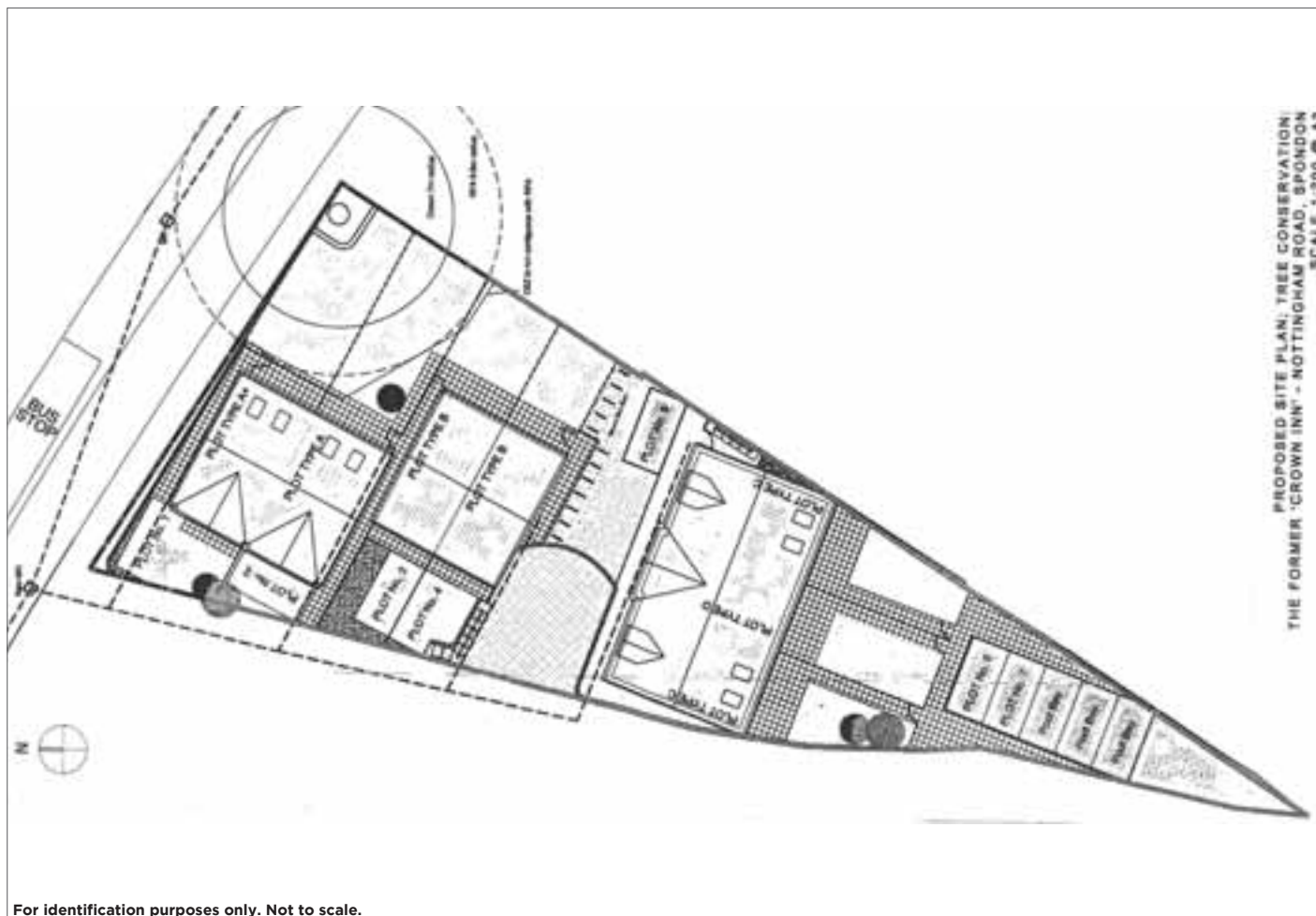

For identification purposes only. Not to scale.

A TRIANGULAR PARCEL OF LAND EXTENDING TO APPROX 0.22 ACRES (0.089 HECTARES) HAVING LAPSED PLANNING CONSENT FOR SEVEN RESIDENTIAL DWELLINGS.

PROPERTY DESCRIPTION:

The site formerly housed the Crown Inn public house (now demolished) and has lapsed planning consent for redevelopment for residential use.

To the front of the site there is a mature tree which is subject to a Tree Preservation Order (TPO) and facing the site are residential properties which are also close to the western boundary. To the south and south-west is an unadopted road which runs parallel with the site and serves industrial units to the south.

The planning permission is for redevelopment in the form of seven dwellings comprising 2 x 2 bed roomed, two storey residential properties and 5 x 3 bed roomed, three storied properties.

PLANNING DETAILS:

Consent was originally granted for the scheme under reference DER/10/13/01170/PRI by Derby City Council (subject to conditions) on 12th September 2014.

TENURE: Freehold

VACANT POSSESSION UPON COMPLETION

VIEWING:

Direct on site.

***GUIDE PRICE £195,000+ (plus fees)**



For identification purposes only. Not to scale.



For identification purposes only. Not to scale.



Apex
Bridging.

Bid with Confidence Borrow with Ease

www.apexbridging.co.uk/auctions



The Apex Bridging team

Bridging the funding gap for property investors.

Come and speak to us in the auction room
to **see how we can help you.**

T: 01509 431066

www.apexbridging.co.uk/auctions

astl the association of
short term lenders

FIBA Financial Intermediary
& Broker Association

LOT 35

36 MOOR STREET, SPONDON, DERBY DE21 7EA

A PARTIALLY RENOVATED TWO STOREY FORMER RETAIL PREMISES OFFERING POTENTIAL FOR RESIDENTIAL USAGE (STPC).

PROPERTY DESCRIPTION:

The property is situated within short level walking distance of Spondon village shopping centre and is also well placed for the A52 which provides swift access onto the City centre, the M1 motorway and the City of Nottingham. Excellent commercial investment opportunity.

ACCOMMODATION:

Ground Floor: Entrance lobby, former retail area, kitchen area, separate room with plumbing for wc.

First Floor: Storage/office, lounge/bedroom and room with plumbing for en-suite

ENERGY EFFICIENCY RATING: G

TENURE: Freehold. **VACANT POSSESSION UPON COMPLETION**

VIEWING:

Viewings can be booked online at www.sdlauctions.co.uk

***GUIDE PRICE £59,000+ (plus fees)**



LOT 36

LAND AT ROSE AVENUE, CLAY MILLS, BURTON ON TRENT, STAFFORDSHIRE DE13 0DQ

A RESIDENTIAL DEVELOPMENT SITE WITH THE BENEFIT OF OUTLINE PLANNING PERMISSION FOR THREE DETACHED DWELLINGS.

PROPERTY DESCRIPTION:

The site extends to approximately 0.75 acres and lies on the edge of the popular village of Stretton, on the East side of Rose Avenue and overlooks the countryside and a small mill stream. The site is conveniently located close to the A38 on the outskirts of Burton Upon Trent.

The planning application is outline only and can be viewed on East Staffs Borough Council website - P/2016/01219. Detailed design is subject to reserved matters and therefore provides the opportunity for an incoming purchaser to design and build to their own imagination.

TENURE: Freehold. **VACANT POSSESSION UPON COMPLETION**

VIEWING:

Direct on site.

***GUIDE PRICE £210,000+ (plus fees)**



For identification purposes only. Not to scale.



DOUBLE AWARD WINNER AT THE 2018 EA MASTERS

BEST LARGE SUPPLIER & BEST OVERALL SUPPLIER

LOT 37

25 TOWER ROAD, HARTSHORNE, SWADLINCOTE, DERBYSHIRE DE11 7EU

A PERIOD THREE BEDROOMED DETACHED PROPERTY OCCUPYING A CUL-DE-SAC LOCATION WITH FAR REACHING COUNTRYSIDE VIEWS AND POTENTIAL TO EXTEND (STPC).

PROPERTY DESCRIPTION:

The property has the benefit of mostly replacement sealed unit uPVC double glazing and gas central heating and it offers potential for an extension (stpc). The small, pleasant village of Hartshorne is situated just north of the town of Swadincote and there are several attractions nearby including Calke Abbey and the National Forest. The city of Derby is also within a short commute. Excellent investment opportunity.

ACCOMMODATION:

Ground Floor: Side entrance hall, dining room, rear sitting room, breakfast kitchen room, timber framed front porch.

First Floor: Landing, three bedrooms, family bathroom.

Outside: Wide frontage with level plot which is mainly lawned with gated access, ample car standing space, single detached garage and backing onto some beautiful open countryside.

ENERGY EFFICIENCY RATING: G

TENURE: Freehold

VACANT POSSESSION UPON COMPLETION

VIEWING:

Viewings can be booked online at www.sdlauctions.co.uk

***GUIDE PRICE £165,000+ (plus fees)**



LOT 38

162 BLENHEIM DRIVE, ALLESTREE, DERBY DE22 2GN

AN INDIVIDUAL THREE/FOUR BEDROOMED DETACHED HOUSE REQUIRING A SCHEME OF IMPROVEMENT AND UPGRADING, SITUATED WITHIN LITERALLY YARDS OF WOODLANDS SECONDARY SCHOOL.

PROPERTY DESCRIPTION:

Internally the property offers versatile living accommodation with neutral décor complemented by double glazing and gas central heating. The suburb of Allestree is a very sought after district of Derby boasting popular local primary and secondary schools, numerous shopping parades, recreational facilities, Allestree Park, the A38 which provides swift access onto further regional business centres.

ACCOMMODATION:

Ground Floor: Entrance hall, guest cloakroom, family bathroom, light and spacious full depth lounge, study/occasional guest bedroom, dining room, kitchen.

First Floor: Landing, three bedrooms.

Outside: Garden to front with adjacent driveway providing useful car standing space and leading to single integral garage. Enclosed garden to the rear enjoying a southerly aspect and with a certain degree of privacy.

ENERGY EFFICIENCY RATING: D

TENURE: Freehold. **VACANT POSSESSION UPON COMPLETION**

VIEWING:

Viewings can be booked online at www.sdlauctions.co.uk

***GUIDE PRICE £195,000+ (plus fees)**





A THREE STOREY, FOUR DOUBLE BEDROOMED DETACHED HOUSE LOCATED IN THE POPULAR OLD VILLAGE LOCATION OF ALLESTREE.

PROPERTY DESCRIPTION:

The property is located within the old village location of Allestree which offers a wide and varied range of local amenities including shops, well regarded schools including Portway Junior and Infant Schools as well as Woodlands Secondary School. Access can also be gained to local public transport routes leading to Park Farm shopping centre and Derby city centre and the popular Allestree Park is also close by.

ACCOMMODATION:

Ground Floor: Entrance hallway, cloakroom (unfitted), open plan living area, kitchen (unfitted), utility room (unfitted).

First Floor: Landing, bedroom one, en suite one (unfitted), bedroom three, bedroom four, bathroom (unfitted).

Second Floor: Landing, bedroom two, en suite two (unfitted).

Outside: Ample off road parking to front and access to a double garage. To the rear is a private garden with mature trees and fence boundaries. **Note:** A neighbouring property has a legal right of way to allow parking for two vehicles to the right hand side of the driveway. Please see the legal pack for clarification.

ENERGY EFFICIENCY RATING: D

TENURE: Freehold.

VACANT POSSESSION UPON COMPLETION

VIEWING:

Viewings can be booked online at www.sdlauctions.co.uk

***GUIDE PRICE £230,000+ (plus fees)**





PURE
PROTECT

Part of the **SDL** GROUP

Life, Critical Illness, and Building and Contents Insurance Broker

Work with us to find the
cover that is right for you
and your family.



AN EXTENSIVE RANGE OF PRODUCTS

Including: life insurance,
critical illness cover,
private health insurance,
income protection and
building & contents
insurance.



MARKET-LEADING INSURANCE RATES

Our highly-qualified
advisers compare a large
number of insurers in
moments to ensure that
we find the best policy
for you.



STRAIGHT-FORWARD IMPARTIAL ADVICE

We provide impartial,
jargon-free advice to help
you to make the right
product choice.

0345 319 7070

info@pureprotect.co.uk

www.pureprotect.co.uk



WILDERSLEY IS A VERY ATTRACTIVE STONE BUILT GRADE II LISTED PROPERTY WHICH REQUIRES FULL RENOVATION AND HAS A WIDE RANGE OF OUTBUILDINGS OFFERING COMMERCIAL/RESIDENTIAL DEVELOPMENT OPPORTUNITY (STPC) WITH WALLED GARDENS AND Paddock EXTENDING TO APPROX. 2 ACRES SET IN AN IDYLIC RURAL LOCATION WITH MAGNIFICENT COUNTRYSIDE VIEWS.

PROPERTY DESCRIPTION:

We are informed by the seller the farmhouse is steeped in history and is known to be one of Belper's oldest properties and the Queen Mary of Scots is thought to have passed by the property on the old Coach Road. There has been a dwelling in its present style on the plot of land since Elizabethan times, although a dwelling can be traced back a few hundred years earlier, the land was once part of the Duffield Frith and owned by the De Ferrers of Duffield Castle.

Wildersley was a clearing in the wood, used as a place to rest and partake of refreshments during the deer hunt,

The beautiful former stone built former farmhouse has extensive character accommodation arranged over three floors and requires a full scheme of improvement and upgrading throughout.

The property is approached via a single track through some beautiful open countryside with gated access leading to the property where there is an extensive range of mainly stone built outbuildings comprising a former pig shed, a stone built garage with adjoining sun room and store room. There is a further stone built single storey former barn/stabling, a separate former shire house stables which is one and a half storey, and to the rear of that there is a dilapidated



***GUIDE PRICE £550,000+ (plus fees)**



stone barn with lapsed planning permission (AVA/2005/0056 for further ancillary and holiday accommodation). Located to the rear of the old dilapidated building is an old block built hay barn which measures approximately 70' x 15'. Please note there is a further three bedroomed dwelling that the owners have lived in for a number of years however we are informed there is no residential planning been approved and prospective buyers would be advised to make their own enquiries.

Properties of this character and potential rarely come to the market and in our opinion would allow itself for a number of different uses including to run as a small business i.e. kennels, cattery, potential bed & breakfast, conversion into further residential units, these all subject to the approval of planning permission and building regulations. We would strongly recommend a viewing to fully appreciate the wide range of outbuildings on offer, the stunning former farmhouse and the beautiful rural setting.

ENERGY EFFICIENCY RATING: N/A

TENURE: Freehold

VACANT POSSESSION UPON COMPLETION

VIEWING:

Viewings can be booked online at www.sdlauctions.co.uk





A UNIQUE AND RARE OPPORTUNITY TO ACQUIRE A LARGE FREEHOLD DETACHED CHARACTER PROPERTY ARRANGED OVER THREE FLOORS ON A MOSTLY WALLED SITE EXTENDING TO 0.5 ACRE (0.2 HA) OFFERING POTENTIAL REDEVELOPMENT OR CONVERSION BOTH SUBJECT TO USUAL PLANNING CONSENTS.

PROPERTY DESCRIPTION:

The light and spacious character accommodation extends to 5,798.9 sq ft (538.74 sq.m) internal area and may well lend itself to conversion into apartments/duplex/mews dwellings or redevelopment of the site into four detached dwellings subject to demolition.

The existing site already has a tarmac'd parking area which is accessed off Quarry Road and is also within walking distance of Belper town centre which has an excellent range of independent shops, supermarkets, public houses, restaurants and is positioned along the main A6 arterial road which provides swift access onto the City of Derby and the historic spa town of Matlock and Chatsworth House. Belper is also situated within one of few World Heritage Sites and has the iconic East Mill and the beautiful river gardens positioned along the River Derwent.

Properties of this potential rarely come to the market and offers a superb residential or commercial development opportunity (stpc).

ENERGY EFFICIENCY RATING: E

TENURE: Freehold. **VACANT POSSESSION UPON COMPLETION**

VIEWING:

Viewings can be booked online at www.sdlauctions.co.uk

***GUIDE PRICE £250,000+ (plus fees)**





AN ELEGANT EDWARDIAN FOUR DOUBLE BEDROOMED DETACHED RESIDENCE WITH THREE RECEPTION ROOMS ON A DOUBLE PLOT IN THE HEART OF LITTLEOVER VILLAGE.

PROPERTY DESCRIPTION:

Great potential for extensions (stpc) to make a very large house or an additional dwelling. Delightful original features such as tiled floors, fireplaces, covings and panelled doors as well as gas central heating and uPVC double glazing. Detached brick garage. Excellent potential and location.

ACCOMMODATION:

Ground Floor: Large reception hall, front sitting room, rear drawing room, breakfast room, kitchen, walk in pantry.

First Floor: Spacious landing, four double bedrooms, bathroom.

Outside: Situated on large double plot with gardens to three sides and large detached brick built garage.

ENERGY EFFICIENCY RATING: E

TENURE: Freehold

VACANT POSSESSION UPON COMPLETION

VIEWING:

Viewings can be booked online at www.sdlauctions.co.uk

***GUIDE PRICE £275,000+ (plus fees)**

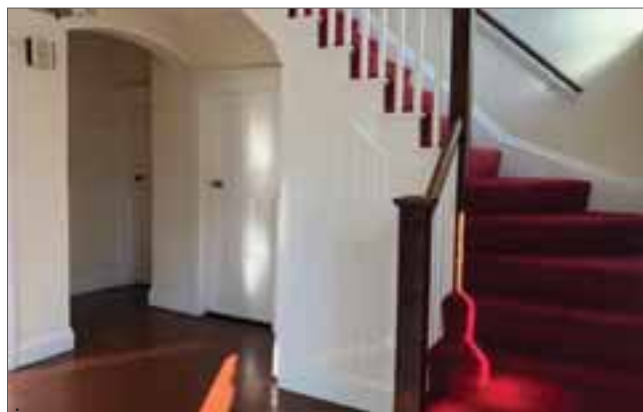

THE FOLLOWING LOTS ARE BEING SOLD UNCONDITIONALLY WITH A RESERVATION FEE OR CONDITIONALLY WITH A RESERVATION FEE.

UNCONDITIONAL & CONDITIONAL AUCTIONS EXPLAINED

UR Unconditional Reservation Fee

Upon the fall of the hammer the buyer shall...

- Be legally bound to buy the property
- Pay a 5% deposit, subject to a minimum of £5,000 (this will contribute towards the purchase price)
- Pay a reservation fee of 4.8% including VAT or 4.2% including VAT in London, subject to a minimum of £6,000 including VAT. The reservation fee does not contribute towards the purchase price.
- Exchange contracts on the fall of the hammer and sign the special conditions of sale held with the auctioneer or solicitor
- Complete the purchase within 28 days (unless an alternative date has been specified in the special conditions of sale)

CR Conditional Reservation Fee

Upon the fall of the hammer the buyer shall...

- Pay a reservation fee of 4.8% including VAT or 4.2% including VAT in London, subject to a minimum of £6,000 including VAT. The reservation fee does not contribute towards the purchase price.
- Sign the reservation contract with the auctioneer
- Exchange contracts within 28 days
- Complete the purchase within an additional 28 days of the exchange (unless an alternative date has been specified in the reservation contract)

*The reservation fee represents a different set of charges to the regular auction lots. A reservation fee is payable by the buyer where a seller has opted to sell with no fees. However, as a result, a lower reserve price is usually agreed. The reservation fee does not contribute toward the purchase price.

Please ensure you understand the difference between conditional and unconditional auctions (and which type of auction you are bidding on), the associated costs and your legal obligation. If you are unsure or have any questions please contact one of our auction specialists or speak to a member of staff on the day before bidding.

Please note ALL fees and deposits are non-refundable

SDL AUCTIONS

www.sdlauctions.co.uk

LOT 43**1 WOOD STREET, DERBY DE1 3QX****UR**

A THREE BEDROOMED SEMI-DETACHED HOUSE SITUATED CLOSE TO THE CITY CENTRE.

PROPERTY DESCRIPTION:

The property is in need of a scheme of improvements and offers an ideal investment opportunity.

ACCOMMODATION:

Ground Floor: Entrance hall, sitting room, dining kitchen.

First Floor: Landing, three bedrooms, bathroom.

Outside: Off road parking with garage door access and a rear courtyard area.

ENERGY EFFICIENCY RATING: D

TENURE: Freehold. **VACANT POSSESSION UPON COMPLETION**

VIEWING:

Viewings can be booked online at www.sdlauctions.co.uk

***GUIDE PRICE £65,000+ (plus fees)**



DerbyEstates



FREE MANAGEMENT

We take the hassle and stress out of day to day management of your property.



0% COMMISSION

We don't charge anything for management.



GUARANTEED RENT

We guarantee you will receive your rent each month in full and on time.



For all enquiries please contact:

Tel: 01332 296555 Email: info@derbyestates.com Website: www.derbylettings.com

Unit A Rosehill Business Centre, Normanton Road, Derby, DE23 6RH

Now is a good time to sell a property and a great time to sell by auction!

Call our valuations team on **01332 242 880** for a
FREE property appraisal

PARTNER AGENTS

PROUD TO WORK IN PARTNERSHIP WITH



Interested in joining us as an Auction Partner?

Get in touch to find out more or to arrange to meet with one of the team.



0345 222 0197



partners@sdlauctions.co.uk

PARTNER AGENTS

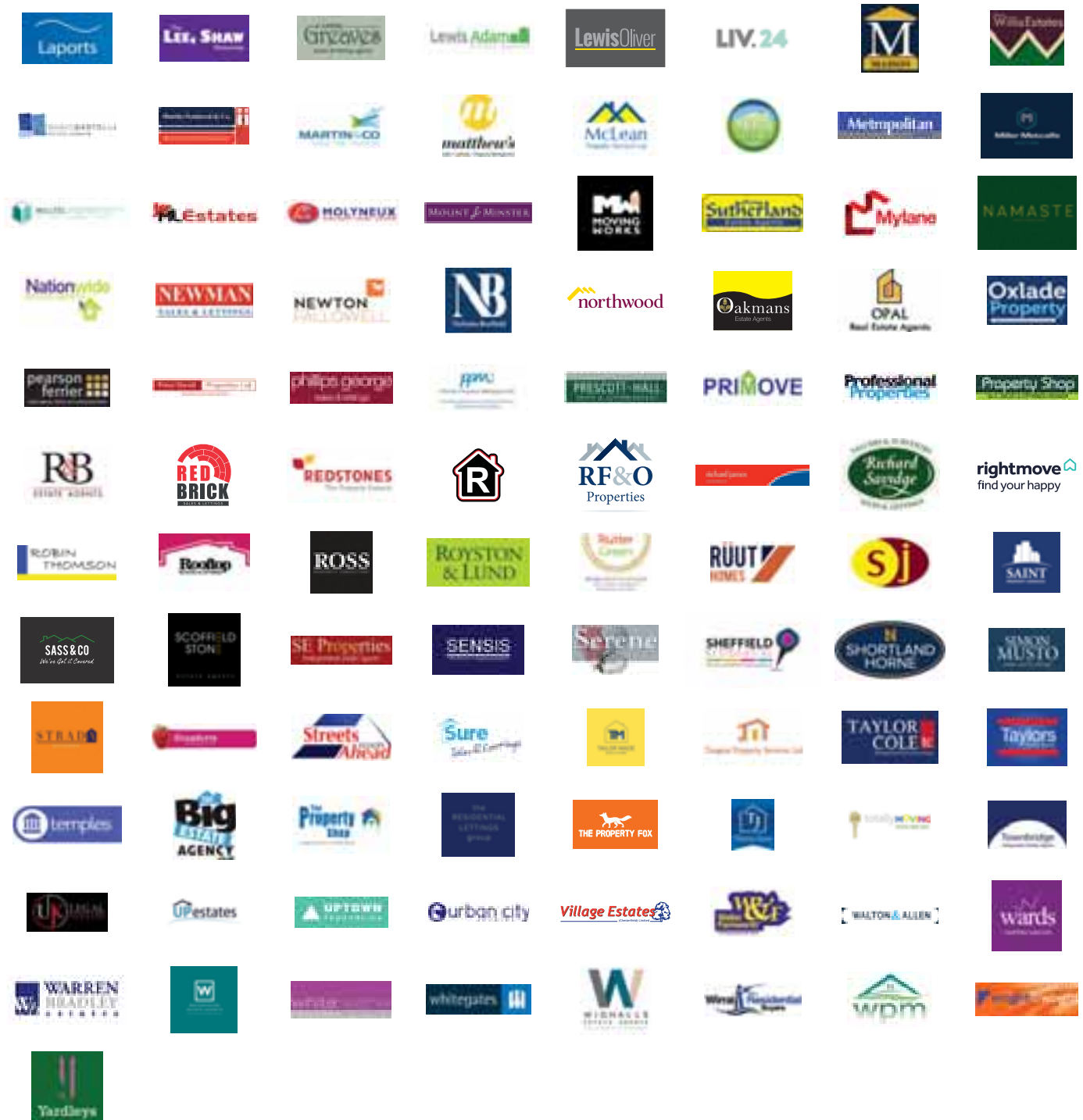

SDL AUCTION PARTNERS



REVOLUTIONISING THE CUSTOMER'S EXPERIENCE OF PROPERTY SERVICES

The SDL Group is the UK's fastest-growing property services group, working with partners across the globe to help over a quarter of a million people with their property needs each year.



£170 million
of auction
property sales
in 2017



30,000
Properties under
management



4,000
active
tenancies
in PRS



550
mortgage
advisers



**Arranged over
£6 billion of
lending in 2017**



170,000
valuations
completed
in 2017

SDL AUCTIONS

SDL AUCTION PARTNERS

SDL PROPERTY PARTNERS

SDL PROPERTY MANAGEMENT

SDL SURVEYING

SDL MORTGAGE SERVICES

PURE PROTECT

CENTURY 21
United Kingdom

PAYMENT DETAILS

I attach Bank Draft/Building Society Draft for: £ In words:

Card Number:

Valid from: Expires End: Issue: CSC:

Name (as it appears on card):

NOTE: Any drafts supplied will be shredded unless otherwise requested in the event of an unsuccessful proxy, telephone or internet bid.

TERMS & CONDITIONS FOR PROXY, TELEPHONE & INTERNET BIDDING

Anyone not able to attend the Auction to make their own bids may utilise the facilities available for telephone, internet or written (proxy) bids on the following Terms and Conditions.

- The Bidder must complete a separate authority form for each Lot involved, and provide a separate Banker's Draft or Building Society Draft or Debit Card details (cleared funds) relevant to the method of sale (unconditional, unconditional with reservation fee or conditional with reservation fee) as outlined in the Payment Requirements Section of this form.
- The form must be hand delivered, posted or emailed to the relevant auction office to arrive prior to the auction day. It is the Bidder's responsibility to check that the form is received by SDL Auctions and this can be done by telephoning the office.
- Due to money laundering obligations we require two forms of identity for the bidder and buyer (if different), one photo identification i.e passport or driving licence and one proof of address i.e bank statement or utility bill, no more than 3 months old. By signing this agreement you understand that we will undertake a search with Experian for the purposes of verifying your identity. To do so Experian may check the details you supply against any particulars on any database (public or otherwise) to which they have access. This system allows us to verify you from basic details using electronic data, however it is not a credit check of any kind so will have no effect on you or your credit history. They may also use your details in the future to assist other companies for verification purposes. A record of the search will be retained.
- The Bidder shall be deemed to have read the 'Notice to all Bidders', the particulars of the relevant Lot in the Catalogue and the General and the full legal pack including the Special Conditions of Sale. The Bidder shall be deemed to have taken all necessary professional and legal advice and to have made enquiries and have knowledge of any announcements to be made from the rostrum and any of the addendum relating to the relevant Lot. The addendum can, and should, be checked by visiting our website www.sdlauctions.co.uk or at the Auction prior to bidding.
- In the case of telephone bids, at about the time the Lot comes up for auction, attempts will be made to contact the Bidder by telephone and, if successful, the Bidder may then compete in the bidding through the Auctioneer's staff.
The Bidder accepts that such contact is at the Bidder's risk and in the event that the telephone or internet link is not established, or breaks down, or there is any confusion or disruption, then the Bidder will not be able to participate in the Auction. The Auctioneer will not be held responsible for instructions or authorisations given to them which are unclear or incomplete and these bids will not be accepted.
If it is impossible to obtain telephone contact or the link breaks down, the auctioneer is authorised to continue to bid on behalf of the telephone bidder up to the maximum bid stated on this form. If internet connection is lost the auctioneer is authorised to continue to bid on behalf of the internet bidder up to the maximum bid stated on this form.
- In the case of internet bidding, all bidders who have registered can commence bidding when the intended Lot is being offered, however SDL Auctions do not take any liability or responsibility should there be any interruption or suspension of internet services.
- In the case of written bids, SDL Auctions staff will compete in the bidding up to the maximum of the authorisation. If no maximum is inserted, SDL Auctions will not bid. SDL Auctions do not guarantee to regulate the bidding so that the maximum authorised bid actually falls to the written bidder.
- SDL Auctions reserve the right not to bid on behalf of the telephone/written/ internet Bidders in the event of any error, doubt, omission, uncertainty as to their bid, or for any reason whatsoever, and give no warranty, or guarantee, that a bid would be made on behalf of the Bidder and accept no liability.
- In the event that the telephone/written or internet bid is successful the Auctioneer will sign the Memorandum of Contract or reservation Contract on behalf of the Bidder (a Contract having been formed on the fall of the hammer).
- In the event of a Contract the deposit monies will be applied so far as necessary to meet the requirement for a 10% or 5% deposit (whichever is applicable) subject to a minimum of £5,000 per Lot, plus the buyers administration fee or reservation fee (whichever is applicable), however if monies are received over the relevant deposit amount, this will result in the purchaser paying a lesser sum on completion.
- Once delivered to the Auctioneers the authority to bid is binding on the Bidder up to 8.00pm on the day on which the particular Lot is auctioned. This is to allow for the possibility of a Vendor agreeing to sell post auction where the bidding has not reached the reserve.
- The authority can only be withdrawn by notification in writing delivered to the auction office by 4pm the day before the Auction or into the hands of the Auctioneer in the Auction Room half an hour before the start of that day's auction. It is the Bidder's responsibility to obtain a receipt on a copy of the withdrawal notification signed by one of the Auctioneers and without such a receipt the authority stands and any successful Contract is binding on the Bidder.
- If the Bidder, or an agent, actually bids at the Auction without having previously withdrawn the authority, the Auctioneer is at liberty to accept such bid in addition to any bid from SDL Auctions staff as empowered under the telephone/written/internet authority. SDL Auctions would have no liability whatsoever if the price achieved is the result only of this competition in bidding without intervention from other bidders.
- The receipt of a telephone, written or internet bid shall not in any way hinder the right of the Vendor to withdraw any Lot or to sell prior to auction to a third party and neither the Vendor nor SDL Auctions shall be under any liability to the telephone or written Bidder in the event that the Lot is not offered at the Auction.
- The auctioneer may disclose to the Vendor the existence of these instructions but not the amount of the maximum bid.

Signature of prospective purchaser

Date of Signature

I hereby confirm that I have read the General, Additional and Special Conditions of Sale. I accept that it is my responsibility to check for any amendments which may be read by the Auctioneers on the Auction Day.

I authorise the Auctioneers to sign the contract on my behalf and, recognise that I will then be the fully bound purchaser of the property referred to above and must complete this transaction within the time specified in the Conditions of Sale.

Once you have completed this form please send it to SDL Auctions together with your draft or debit card details and also your identification documents in accordance with the money laundering legislation detailed in this catalogue.

Privacy notice: SDL Auctions is part of the SDL Group (www.sdlgroup.co.uk). We collect the above information from you so that we can conduct the bidding process. We may also use your data to send you relevant marketing from within the Group. We will store your data for six years. To opt out or if you have any questions about how we handle your data please contact compliance@sdlgroup.co.uk.

SDL Auctions may send you details of future auctions. Please tick here if you do not wish to receive further communication from us. ☐

(Please note, your details will not be shared with any third party, but may be shared within the SDL Group).

Common Auction Conditions (Edition 4 June 2018)

Reproduced with the consent of the RICS

GLOSSARY

This glossary applies to the AUCTION CONDUCT CONDITIONS and the SALE CONDITIONS. It is a compulsory section of the Common AUCTION Conditions that must be included without variation (but the SPECIAL CONDITIONS may include defined words that differ from the glossary so long as they apply only to the SPECIAL CONDITIONS).

The laws of England and Wales apply to the CONDITIONS and YOU, WE, the SELLER and the BUYER all submit to the jurisdiction of the Courts of England and Wales.

Wherever it makes sense:

- singular words can be read as plurals, and plurals as singular words;
- a "person" includes a corporate body;
- words of one gender include the other genders;
- references to legislation are to that legislation as it may have been modified or re-enacted by the date of the AUCTION or the CONTRACT DATE (as applicable); and
- where the following words appear in small capitals they have the specified meanings.

ACTUAL COMPLETION DATE

The date when COMPLETION takes place or is treated as taking place for the purposes of apportionment and calculating interest.

ADDENDUM

An amendment or addition to the CONDITIONS or to the PARTICULARS or to both whether contained in a supplement to the CATALOGUE, a written notice from the AUCTIONEERS or an oral announcement at the AUCTION.

AGREED COMPLETION DATE

Subject to CONDITION G9.3:

- the date specified in the SPECIAL CONDITIONS; or
- if no date is specified, 20 BUSINESS DAYS after the CONTRACT DATE; but if that date is not a BUSINESS DAY the first subsequent BUSINESS DAY.

APPROVED FINANCIAL INSTITUTION

Any bank or building society that is regulated by a competent UK regulatory authority or is otherwise acceptable to the AUCTIONEERS.

ARREARS

ARREARS of rent and other sums due under the TENANCIES and still outstanding on the ACTUAL COMPLETION DATE.

ARREARS SCHEDULE

The ARREARS schedule (if any) forming part of the SPECIAL CONDITIONS.

AUCTION

The AUCTION advertised in the CATALOGUE.

AUCTION CONDUCT CONDITIONS

The conditions so headed, including any extra AUCTION CONDUCT CONDITIONS.

AUCTIONEERS

The AUCTIONEERS at the AUCTION.

BUSINESS DAY

Any day except (a) Saturday or Sunday or (b) a bank or public holiday in England and Wales.

BUYER

The person who agrees to buy the LOT or, if applicable, that person's personal representatives: if two or more are jointly the BUYER their obligations can be enforced against them jointly or against each of them separately.

CATALOGUE

The catalogue for the AUCTION as it exists at the date of the AUCTION (or, if the catalogue is then different, the date of the CONTRACT) including any ADDENDUM and whether printed or made available electronically.

COMPLETION

When the SELLER and the BUYER otherwise agree, the occasion when they have both complied with the obligations under the CONTRACT that they are obliged to comply with prior to COMPLETION, and the amount payable on COMPLETION has been unconditionally received in the SELLER'S conveyancer's client account (or as otherwise required by the terms of the CONTRACT).

CONDITION

One of the AUCTION CONDUCT CONDITIONS or SALE CONDITIONS.

CONTRACT

The CONTRACT by which the SELLER agrees to sell and the BUYER agrees to buy the LOT.

CONTRACT DATE

The date of the AUCTION or, if the LOT is sold before or after the AUCTION:

- the date of the SALE MEMORANDUM signed by both the SELLER and BUYER; or
- if CONTRACTs are exchanged, the date of exchange. If exchange is not effected in person or by an irrevocable agreement to exchange made by telephone, fax or electronic mail the date of exchange is the date on which both parts have been signed and posted or otherwise placed beyond normal retrieval.

DOCUMENTS

DOCUMENTS of title including, if title is registered, the entries on the register and the title plan and other DOCUMENTS listed or referred to in the SPECIAL CONDITIONS relating to the LOT (apart from FINANCIAL CHARGES).

EXTRA GENERAL CONDITIONS

Any CONDITIONS added or varied by the AUCTIONEERS starting at CONDITION G30.

FINANCIAL CHARGE

A charge to secure a loan or other financial indebtedness (but not including a rentcharge or local land charge).

GENERAL CONDITIONS

The SALE CONDITIONS headed 'GENERAL CONDITIONS OF SALE', including any EXTRA GENERAL CONDITIONS.

INTEREST RATE

If not specified in the SPECIAL CONDITIONS, the higher of 6% and 4% above the base rate from time to time of Barclays Bank plc. The INTEREST RATE will also apply to any judgment debt, unless the statutory rate is higher.

LOT

Each separate property described in the CATALOGUE or (as the case may be) the property that the SELLER has agreed to sell and the BUYER to buy (including chattels, if any).

OLD ARREARS

ARREARS due under any of the TENANCIES that are not "new TENANCIES" as defined by the Landlord and Tenant (Covenants) Act 1995.

PARTICULARS

The section of the CATALOGUE that contains descriptions of each LOT (as varied by any ADDENDUM).

PRACTITIONER

An insolvency PRACTITIONER for the purposes of the Insolvency Act 1986 (or, in relation to jurisdictions outside the United Kingdom, a person undertaking a similar role).

PRICE

The PRICE (exclusive of VAT) that the BUYER agrees to pay for the LOT.

READY TO COMPLETE

Ready, willing and able to complete: if COMPLETION would enable the SELLER to discharge all FINANCIAL CHARGES secured on the LOT that have to be discharged by COMPLETION, then those outstanding financial charges do not prevent the SELLER from being READY TO COMPLETE.

SALE CONDITIONS

The GENERAL CONDITIONS as varied by any SPECIAL CONDITIONS or ADDENDUM.

SALE MEMORANDUM

The form so headed (whether or not set out in the CATALOGUE) in which the terms of the CONTRACT for the sale of the LOT are recorded.

SELLER

The person selling the LOT. If two or more are jointly the SELLER their obligations can be enforced against them jointly or against each of them separately.

SPECIAL CONDITIONS

Those of the SALE CONDITIONS so headed that relate to the LOT.

TENANCIES

TENANCIES, leases, licences to occupy and agreements for lease and any DOCUMENTS varying or supplemental to them.

TENANCY SCHEDULE

The schedule of TENANCIES (if any) forming part of the SPECIAL CONDITIONS.

TRANSFER

TRANSFER includes a conveyance or assignment (and "to TRANSFER" includes "to convey" or "to assign").

TUPE

The TRANSFER of Undertakings (Protection of Employment) Regulations 2006.

VAT

Value Added Tax or other tax of a similar nature.

VAT OPTION

An option to tax.

WE (AND US AND OUR)

The AUCTIONEERS.

YOU (AND YOUR)

Someone who has seen the CATALOGUE or who attends or bids at or otherwise participates in the AUCTION, whether or not a BUYER.

AUCTION CONDUCT CONDITIONS

Words in small capitals have the special meanings defined in the Glossary.

The AUCTION CONDUCT CONDITIONS (as supplemented or varied by CONDITION A6, if applicable) are a compulsory section of the Common AUCTION Conditions. They cannot be disappplied or varied without OUR agreement, even by a CONDITION purporting to replace the Common AUCTION Conditions in their entirety.

A1 INTRODUCTION

The AUCTION CONDUCT CONDITIONS apply wherever the LOT is located.

If YOU make a bid for a LOT or otherwise participate in the AUCTION it is on the basis that YOU accept these AUCTION CONDUCT CONDITIONS. They govern OUR relationship with YOU. They can be varied only if WE agree.

A2 OUR ROLE

As agents for each SELLER we have authority to (a) prepare the CATALOGUE from information supplied by or on behalf of each SELLER;

- offer each LOT for sale;
- sell each LOT;
- receive and hold deposits;
- sign each SALE MEMORANDUM; and
- treat a CONTRACT as repudiated if the BUYER fails to sign a SALE MEMORANDUM or pay a deposit as required by these AUCTION CONDUCT CONDITIONS or fails to provide identification as required by the AUCTIONEERS.

OUR decision on the conduct of the AUCTION is final. WE may cancel the AUCTION, or alter the order in which LOTS are offered for sale. WE may also combine or divide LOTS. A LOT may be sold or withdrawn from sale prior to the AUCTION.

YOU acknowledge that to the extent permitted by law WE owe YOU no duty of care and YOU have no claim against US for any loss.

WE may refuse to admit one or more persons to the AUCTION without having to explain why.

YOU may not be allowed to bid unless YOU provide such evidence of YOUR identity and other information as WE reasonably require from all bidders.

A3 BIDDING AND RESERVE PRICES

All bids are to be made in pounds sterling exclusive of VAT.

WE may refuse to accept a bid. WE do not have to explain why.

If there is a dispute over bidding WE are entitled to resolve it, and OUR decision is final.

Unless stated otherwise each LOT is subject to a reserve PRICE (which may be fixed just before the LOT is offered for sale). If no bid equals or exceeds that reserve PRICE the LOT will be withdrawn from the AUCTION.

Where there is a reserve PRICE the SELLER may bid (or ask US or another agent to bid on the SELLER's behalf) up to the reserve PRICE but may not make a bid equal to or exceeding the reserve PRICE. YOU accept that it is possible that all bids up to the reserve PRICE are bids made by or on behalf of the SELLER.

A4 THE PARTICULARS AND OTHER INFORMATION

WE have taken reasonable care to prepare PARTICULARS that correctly describe each LOT. The PARTICULARS are based on information supplied by or on behalf of the SELLER. YOU need to check that the information in the PARTICULARS is correct.

If the SPECIAL CONDITIONS do not contain a description of the LOT, or simply refer to the relevant LOT number, you take the risk that the description contained in the PARTICULARS is incomplete or inaccurate, as the PARTICULARS have not been prepared by a conveyancer and are not intended to form part of a legal CONTRACT. The PARTICULARS and the SALE CONDITIONS may change prior to the AUCTION and it is YOUR responsibility to check that YOU have the correct versions.

If WE provide information, or a copy of a DOCUMENT, WE do so only on the basis that WE are not responsible for the accuracy of that information or DOCUMENT.

A5 THE CONTRACT

A successful bid is one WE accept as such (normally on the fall of the hammer). This CONDITION A5 applies to YOU only if YOU make the successful bid for a LOT.

YOU are obliged to buy the LOT on the terms of the SALE MEMORANDUM at the PRICE YOU bid (plus VAT, if applicable).

YOU must before leaving the AUCTION

- provide all information WE reasonably need from YOU to enable US to complete the SALE MEMORANDUM (including proof of your identity if required by US);
- sign the completed SALE MEMORANDUM; and
- pay the deposit.

If YOU do not WE may either

- as agent for the SELLER treat that failure as YOUR repudiation of the CONTRACT and offer the LOT for sale again; the SELLER may then have a claim against YOU for breach of CONTRACT; or
- sign the SALE MEMORANDUM on YOUR behalf.

The deposit

- must be paid in pounds sterling by cheque or by bankers' draft made payable to US (or, at OUR option, the SELLER'S conveyancer) drawn on an APPROVED FINANCIAL INSTITUTION (CONDITION A6 may state if WE accept any other form of payment);
- may be declined by US unless drawn on YOUR account, or that of the BUYER, or of another person who (we are satisfied) would not expose US to a breach of money laundering regulations;
- is to be held by US (or, at OUR option, the SELLER'S conveyancer); and
- is to be held as stakeholder where VAT would be chargeable on the deposit were it to be held as agent for the SELLER, but otherwise is to be held as stakeholder unless the SALE CONDITIONS require it to be held as agent for the SELLER.

WE may retain the SALE MEMORANDUM signed by or on behalf of the SELLER until the deposit has been received in cleared funds.

Where WE hold the deposit as stakeholder WE are authorised to release it (and interest on it if applicable) to the SELLER on COMPLETION or, if COMPLETION does not take place, to the person entitled to it under the SALE CONDITIONS.

If the BUYER does not comply with its obligations under the CONTRACT then

- YOU are personally liable to buy the LOT even if YOU are acting as an agent; and
- YOU must indemnify the SELLER in respect of any loss the SELLER incurs as a result of the BUYER'S default.

Where the BUYER is a company YOU warrant that the BUYER is properly constituted and able to buy the LOT.

A6 EXTRA AUCTION CONDUCT CONDITIONS

Despite any CONDITION to the contrary:

- The minimum deposit WE accept is £5,000 (or the total PRICE, if less). A SPECIAL CONDITION may, however, require a higher minimum deposit
- WE do not accept cash or cheque for all or any part of the deposit
- Sub-clause (d) of AUCTION CONDUCT CONDITION A5.5 shall be deemed to be deleted and shall be replaced with the following:

"(d) is to be held as agent for the SELLER unless expressly stated otherwise in the SPECIAL CONDITIONS. Provided That where VAT would be chargeable on the deposit were it to be held as agent for the SELLER, the deposit will be held as stakeholder despite any contrary provision in any CONDITION; and"

- where the deposit is paid to US to be held as stakeholder, WE may if WE choose transfer all or part of it to the SELLER'S conveyancer for them to hold as stakeholder in OUR place. Any part of the deposit not so transferred will be held by US as stakeholder.

WE may refuse admittance to any person attending the AUCTION. WE do not have to explain why.

Common Auction Conditions of Sale (Edition Four June 2018 Reproduced with the Consent of the RICS)

Words in small capitals have the special meanings defined in the Glossary.

The GENERAL CONDITIONS (as WE supplement or change them by any EXTRA GENERAL CONDITIONS or ADDENDUM) are compulsory but may be disapplied or changed in relation to one or more LOTS by SPECIAL CONDITIONS. The template form of SALE MEMORANDUM is not compulsory but is to be varied only if WE agree. The template forms of SPECIAL CONDITIONS and schedules are recommended, but are not compulsory and may be changed by the SELLER of a LOT.

G1 THE LOT

- G1.1 The LOT (including any rights to be granted or reserved, and any exclusions from it) is described in the SPECIAL CONDITIONS, or if not so described is that referred to in the SALE MEMORANDUM.
- G1.2 The LOT is sold subject to any TENANCIES disclosed by the SPECIAL CONDITIONS, but otherwise with vacant possession on COMPLETION.
- G1.3 The LOT is sold subject to all matters contained or referred to in the DOCUMENTS. The SELLER must discharge FINANCIAL CHARGES on or before COMPLETION.
- G1.4 The LOT is also sold subject to such of the following as may affect it, whether they arise before or after the CONTRACT DATE and whether or not they are disclosed by the SELLER or are apparent from inspection of the LOT or from the DOCUMENTS:
- (a) matters registered or capable of registration as local land charges;
 - (b) matters registered or capable of registration by any competent authority or under the provisions of any statute;
 - (c) notices, orders, demands, proposals and requirements of any competent authority;
 - (d) charges, notices, orders, restrictions, agreements and other matters relating to town and country planning, highways or public health;
 - (e) rights, easements, quasi-easements, and wayleaves;
 - (f) outgoing and other liabilities;
 - (g) any interest which overrides, under the Land Registration Act 2002;
 - (h) matters that ought to be disclosed by the searches and enquiries a prudent BUYER would make, whether or not the BUYER has made them; and
 - (i) anything the SELLER does not and could not reasonably know about.
- G1.5 Where anything subject to which the LOT is sold would expose the SELLER to liability the BUYER is to comply with it and indemnify the SELLER against that liability.
- G1.6 The SELLER must notify the BUYER of any notices, orders, demands, proposals and requirements of any competent authority of which it learns after the CONTRACT DATE but the BUYER must comply with them and keep the SELLER indemnified.
- G1.7 The LOT does not include any tenant's or trade fixtures or fittings. The SPECIAL CONDITIONS state whether any chattels are included in the LOT, but if they are:
- (a) the BUYER takes them as they are at COMPLETION and the SELLER is not liable if they are not fit for use, and
 - (b) the SELLER is to leave them at the LOT.
- G1.8 The BUYER buys with full knowledge of
- (a) the DOCUMENTS, whether or not the BUYER has read them; and
 - (b) the physical condition of the LOT and what could reasonably be discovered on inspection of it, whether or not the BUYER has inspected it.
- G1.9 The BUYER admits that it is not relying on the information contained in the PARTICULARS or on any representations made by or on behalf of the SELLER but the BUYER may rely on the SELLER'S conveyancer's written replies to written enquiries to the extent stated in those replies.

G2 DEPOSIT

- G2.1 The amount of the deposit is the greater of:
- (a) any minimum deposit stated in the AUCTION CONDUCT CONDITIONS (or the total PRICE, if this is less than that minimum); and
 - (b) 10% of the PRICE (exclusive of any VAT on the PRICE).
- G2.2 If a cheque for all or part of the deposit is not cleared on first presentation the SELLER may treat the CONTRACT as at an end and bring a claim against the BUYER for breach of CONTRACT.
- G2.3 Interest earned on the deposit belongs to the SELLER unless the SALE CONDITIONS provide otherwise.

G3 BETWEEN CONTRACT AND COMPLETION

- G3.1 From the CONTRACT DATE the SELLER has no obligation to insure the LOT and the BUYER bears all risks of loss or damage unless
- (a) the LOT is sold subject to a TENANCY that requires the SELLER to insure the LOT or
 - (b) the SPECIAL CONDITIONS require the SELLER to insure the LOT.
- G3.2 If the SELLER is required to insure the LOT then the SELLER
- (a) must produce to the BUYER on request all relevant insurance details;
 - (b) must use reasonable endeavours to maintain that or equivalent insurance and pay the premiums when due;
 - (c) gives no warranty as to the adequacy of the insurance;
 - (d) must at the request of the BUYER use reasonable endeavours to have the BUYER'S interest noted on the policy if it does not cover a contracting

- purchaser;
- (e) must, unless otherwise agreed, cancel the insurance at COMPLETION, apply for a refund of premium and (subject to the rights of any tenant or other third party) pay that refund to the BUYER; and
 - (f) (subject to the rights of any tenant or other third party) hold on trust for the BUYER any insurance payments that the SELLER receives in respect of loss or damage arising after the CONTRACT DATE, or assign to the BUYER the benefit of any claim;
- and the BUYER must on COMPLETION reimburse to the SELLER the cost of that insurance as from the CONTRACT DATE (to the extent not already paid by the BUYER or a tenant or other third party).
- G3.3 No damage to or destruction of the LOT, nor any deterioration in its condition, however caused, entitles the BUYER to any reduction in PRICE, or to delay COMPLETION, or to refuse to complete.
- G3.4 Section 47 of the Law of Property Act 1925 does not apply to the CONTRACT.
- G3.5 Unless the BUYER is already lawfully in occupation of the LOT the BUYER has no right to enter into occupation prior to COMPLETION.
- G4 TITLE AND IDENTITY**
- G4.1 Unless CONDITION G4.2 applies, the BUYER accepts the title of the SELLER to the LOT as at the CONTRACT DATE and may raise no requisition or objection to any of the DOCUMENTS that is made available before the AUCTION or any other matter, except one that occurs after the CONTRACT DATE. The following provisions apply only to any of the following DOCUMENTS that is not made available before the AUCTION:
- (a) If the LOT is registered land the SELLER is to give to the BUYER within five BUSINESS DAYS of the CONTRACT DATE an official copy of the entries on the register and title plan and, where noted on the register, of all DOCUMENTS subject to which the LOT is being sold.
 - (b) If the LOT is not registered land the SELLER is to give to the BUYER within five BUSINESS DAYS of the CONTRACT DATE an abstract or epitome of title starting from the root of title mentioned in the SPECIAL CONDITIONS (or, if none is mentioned, a good root of title more than fifteen years old) and must produce to the BUYER the original or an examined copy of every relevant DOCUMENT.
 - (c) If title is in the course of registration, title is to consist of:
 - (i) certified copies of the application for registration of title made to the Land Registry and of the DOCUMENTS accompanying that application;
 - (ii) evidence that all applicable stamp duty land tax relating to that application has been paid; and
 - (iii) a letter under which the SELLER or its conveyancer agrees to use all reasonable endeavours to answer any requisitions raised by the Land Registry and to instruct the Land Registry to send the completed registration DOCUMENTS to the BUYER.
 - (d) The BUYER has no right to object to or make requisitions on any title information more than seven BUSINESS DAYS after that information has been given to the BUYER.
- G4.3 Unless otherwise stated in the SPECIAL CONDITIONS the SELLER sells with full title guarantee except that (and the TRANSFER shall so provide):
- (a) the covenant set out in section 3 of the Law of Property (Miscellaneous Provisions) Act 1994 shall not extend to matters recorded in registers open to public inspection; these are to be treated as within the actual knowledge of the BUYER; and
 - (b) the covenant set out in section 4(1)(b) of the Law of Property (Miscellaneous Provisions) Act 1994 shall not extend to any condition or tenant's obligation relating to the state or condition of the LOT where the LOT is leasehold property.
- G4.4 The TRANSFER is to have effect as if expressly subject to all matters subject to which the LOT is sold under the CONTRACT.
- G4.5 The SELLER does not have to produce, nor may the BUYER object to or make a requisition in relation to, any prior or superior title even if it is referred to in the DOCUMENTS.
- G4.6 The SELLER (and, if relevant, the BUYER) must produce to each other such confirmation of, or evidence of, their identity and that of their mortgagees and attorneys (if any) as is necessary for the other to be able to comply with applicable Money Laundering Regulations and Land Registry Rules.
- G5 TRANSFER**
- G5.1 Unless a form of TRANSFER is prescribed by the SPECIAL CONDITIONS
- (a) the BUYER must supply a draft TRANSFER to the SELLER at least ten BUSINESS DAYS before the AGREED COMPLETION DATE and the engrossment (signed as a deed by the BUYER if CONDITION G5.2 applies) five BUSINESS DAYS before that date or (if later) two BUSINESS DAYS after the draft has been approved by the SELLER; and
 - (b) the SELLER must approve or revise the draft TRANSFER within five BUSINESS DAYS of receiving it from the BUYER.
- G5.2 If the SELLER has any liability (other than to the BUYER) in relation to the LOT or a TENANCY following COMPLETION, the BUYER is specifically to covenant in the TRANSFER to indemnify the SELLER against that liability.
- G5.3 The SELLER cannot be required to TRANSFER the LOT to anyone other than the BUYER, or by more than one TRANSFER.

- G5.4 Where the SPECIAL CONDITIONS state that the SELLER is to grant a new lease to the BUYER
- (a) the CONDITIONS are to be read so that the TRANSFER refers to the new lease, the SELLER to the proposed landlord and the BUYER to the proposed tenant;
 - (b) the form of new lease is that described by the SPECIAL CONDITIONS; and
 - (c) the SELLER is to produce, at least five BUSINESS DAYS before the AGREED COMPLETION DATE, the engrossed counterpart lease, which the BUYER is to sign and deliver to the SELLER on COMPLETION.
- G6 COMPLETION**
- G6.1 COMPLETION is to take place at the offices of the SELLER'S conveyancer, or where the SELLER may reasonably require, on the AGREED COMPLETION DATE. The SELLER can only be required to complete on a BUSINESS DAY and between the hours of 0930 and 1700.
- G6.2 The amount payable on COMPLETION is the balance of the PRICE adjusted to take account of apportionments plus (if applicable) VAT and interest, but no other amounts unless specified in the SPECIAL CONDITIONS.
- G6.3 Payment is to be made in pounds sterling and only by
- (a) direct TRANSFER from the BUYER'S conveyancer to the SELLER'S conveyancer; and
 - (b) the release of any deposit held by a stakeholder or in such other manner as the SELLER'S conveyancer may agree.
- G6.4 Unless the SELLER and the BUYER otherwise agree, COMPLETION cannot take place until both have complied with the obligations under the CONTRACT that they are obliged to comply with prior to COMPLETION, and the amount payable on COMPLETION is unconditionally received in the SELLER'S conveyancer's client account or as otherwise required by the terms of the CONTRACT.
- G6.5 If COMPLETION takes place after 1400 hours for a reason other than the SELLER'S default it is to be treated, for the purposes of apportionment and calculating interest, as if it had taken place on the next BUSINESS DAY.
- G6.6 Where applicable the CONTRACT remains in force following COMPLETION.
- G7 NOTICE TO COMPLETE**
- G7.1 The SELLER or the BUYER may on or after the AGREED COMPLETION DATE but before COMPLETION give the other notice to complete within ten BUSINESS DAYS (excluding the date on which the notice is given) making time of the essence. The person giving the notice must be READY TO COMPLETE.
- G7.2 If the SELLER fails to comply with a notice to complete the SELLER may, without affecting any other remedy the SELLER has:
- (a) terminate the CONTRACT;
 - (b) claim the deposit and any interest on it if held by a stakeholder;
 - (c) forfeit the deposit and any interest on it;
 - (d) resell the LOT; and
 - (e) claim damages from the BUYER.
- G7.4 If the SELLER fails to comply with a notice to complete the BUYER may, without affecting any other remedy the BUYER has:
- (a) terminate the CONTRACT; and
 - (b) recover the deposit and any interest on it from the SELLER or, if applicable, a stakeholder.
- G8 IF THE CONTRACT IS BROUGHT TO AN END**
- If the CONTRACT is lawfully brought to an end:
- (a) the BUYER must return all papers to the SELLER and appoints the SELLER its agent to cancel any registration of the CONTRACT; and
 - (b) the SELLER must return the deposit and any interest on it to the BUYER (and the BUYER may claim it from the stakeholder, if applicable) unless the SELLER is entitled to forfeit the deposit under CONDITION G7.3.
- G9 LANDLORD'S LICENCE**
- G9.1 Where the LOT is or includes leasehold land and licence to assign or sublet is required this CONDITION G9 applies.
- G9.2 The CONTRACT is conditional on that licence being obtained, by way of formal licence if that is what the landlord lawfully requires.
- G9.3 The AGREED COMPLETION DATE is not to be earlier than the date five BUSINESS DAYS after the SELLER has given notice to the BUYER that licence has been obtained ("licence notice").
- G9.4 The SELLER must
- (a) use all reasonable endeavours to obtain the licence at the SELLER'S expense; and
 - (b) enter into any Authorised Guarantee Agreement ("AGA") properly required (procuring a guarantee of that AGA if lawfully required by the landlord).
- G9.5 The BUYER must promptly
- (a) provide references and other relevant information; and
 - (b) comply with the landlord's lawful requirements.
- G9.6 If within three months of the CONTRACT DATE (or such longer period as the SELLER and BUYER agree) the SELLER has not given licence notice to the BUYER the SELLER or the BUYER may (if not then in breach of any obligation under this CONDITION G9) by notice to the other terminate the CONTRACT at any time before the SELLER has given licence notice. That termination is without prejudice to the claims of either SELLER or BUYER for breach of this CONDITION G9.
- G10 INTEREST AND APPORTIONMENTS**
- G10.1 If the ACTUAL COMPLETION DATE is after the AGREED COMPLETION DATE for any reason other than the SELLER'S default the BUYER must pay interest at the INTEREST RATE on the money due

	from the BUYER at COMPLETION for the period starting on the AGREED COMPLETION DATE and ending on the ACTUAL COMPLETION DATE.		the SELLER to a liability that the SELLER would not otherwise have, in which case the SELLER may act reasonably in such a way as to avoid that liability;		connection with the BUYER's claim for capital allowances.
G10.2	Subject to CONDITION G11 the SELLER is not obliged to apportion or account for any sum at COMPLETION unless the SELLER has received that sum in cleared funds. The SELLER must promptly pay to the BUYER after COMPLETION any sum to which the BUYER is entitled that the SELLER subsequently receives in cleared funds.		(b) if the SELLER gives the BUYER notice of the SELLER's intended act and the BUYER does not object within five BUSINESS DAYS giving reasons for the objection the SELLER may act as the SELLER intends; and	G16.3	The value to be attributed to those items on which capital allowances may be claimed is set out in the SPECIAL CONDITIONS.
G10.3	Income and outgoings are to be apportioned at the ACTUAL COMPLETION DATE unless: (a) the BUYER is liable to pay interest; and (b) the SELLER has given notice to the BUYER at any time up to COMPLETION requiring apportionment on the date from which interest becomes payable by the BUYER;		(c) the BUYER is to indemnify the SELLER against all loss or liability the SELLER incurs through acting as the BUYER requires, or by reason of delay caused by the BUYER.	G16.4	The SELLER and BUYER agree: (a) to make an election on COMPLETION under Section 198 of the Capital Allowances Act 2001 to give effect to this CONDITION G16; and (b) to submit the value specified in the SPECIAL CONDITIONS to HM Revenue and Customs for the purposes of their respective capital allowance computations.
G10.4	Apportionments are to be calculated on the basis that: (a) the SELLER receives income and is liable for outgoings for the whole of the day on which apportionment is to be made; (b) annual income and expenditure accrues at an equal daily rate assuming 365 days in a year (or 366 in a leap year), and income and expenditure relating to some other period accrues at an equal daily rate during the period to which it relates; and (c) where the amount to be apportioned is not known at COMPLETION apportionment is to be made by reference to a reasonable estimate and further payment is to be made by SELLER or BUYER as appropriate within five BUSINESS DAYS of the date when the amount is known.	G13 RENT DEPOSITS G13.1 Where any TENANCY is an assured shorthold TENANCY, the SELLER and the BUYER are to comply with their respective statutory duties in relation to the protection of tenants' deposits, and to demonstrate in writing to the other (before COMPLETION, so far as practicable) that they have complied.		G17 MAINTENANCE AGREEMENTS G17.1 The SELLER agrees to use reasonable endeavours to TRANSFER to the BUYER, at the BUYER's cost, the benefit of the maintenance agreements specified in the SPECIAL CONDITIONS.	
G10.5	If a payment due from the BUYER to the SELLER on or after COMPLETION is not paid by the due date, the BUYER is to pay interest to the SELLER at the INTEREST RATE on that payment from the due date up to and including the date of payment.	G13.2 The remainder of this CONDITION G13 applies where the SELLER is holding or otherwise entitled to money by way of rent deposit in respect of a TENANCY. In this CONDITION G13 "rent deposit deed" means the deed or other DOCUMENT under which the rent deposit is held.		G17.2 The BUYER must assume, and indemnify the SELLER in respect of, all liability under such agreements from the ACTUAL COMPLETION DATE.	
G11. ARREARS <i>Part 1 – Current rent</i> G11.1 "Current rent" means, in respect of each of the TENANCIES subject to which the LOT is sold, the instalment of rent and other sums payable by the tenant on the most recent rent payment date on or within four months preceding COMPLETION.		G13.3 If the rent deposit is not assignable the SELLER must on COMPLETION hold the rent deposit on trust for the BUYER and, subject to the terms of the rent deposit deed, comply at the cost of the BUYER with the BUYER's lawful instructions.		G18 LANDLORD AND TENANT ACT 1987 G18.1 This CONDITION G18 applies where the sale is a relevant disposal for the purposes of part I of the Landlord and Tenant Act 1987	
G11.2 If on COMPLETION there are any ARREARS of current rent the BUYER must pay them, whether or not details of those ARREARS are given in the SPECIAL CONDITIONS.		G13.4 Otherwise the SELLER must on COMPLETION pay and assign its interest in the rent deposit to the BUYER under an assignment in which the BUYER covenants with the SELLER to: (a) observe and perform the SELLER's covenants and conditions in the rent deposit deed and indemnify the SELLER in respect of any breach; (b) give notice of assignment to the tenant; and (c) give such direct covenant to the tenant as may be required by the rent deposit deed.		G18.2 The SELLER warrants that the SELLER has complied with sections 5B and 7 of that Act and that the requisite majority of qualifying tenants has not accepted the offer.	
G11.3 Parts 2 and 3 of this CONDITION G11 do not apply to ARREARS of current rent.		G14 VAT G14.1 Where a SALE CONDITION requires money to be paid or other consideration to be given, the payer must also pay any VAT that is chargeable on that money or consideration, but only if given a valid VAT invoice.		G19 SALE BY PRACTITIONER G19.1 This CONDITION G19 applies where the sale is by a PRACTITIONER either as SELLER or as agent of the SELLER.	
<i>Part 2 – BUYER to pay for ARREARS</i> G11.4 Part 2 of this CONDITION G11 applies where the SPECIAL CONDITIONS give details of ARREARS.		G14.2 Where the SPECIAL CONDITIONS state that no VAT OPTION has been made the SELLER confirms that none has been made by it or by any company in the same VAT group nor will be prior to COMPLETION.		G19.2 The PRACTITIONER has been duly appointed and is empowered to sell the LOT.	
G11.5 The BUYER is on COMPLETION to pay, in addition to any other money then due, an amount equal to all ARREARS of which details are set out in the SPECIAL CONDITIONS.		G15 TRANSFER AS A GOING CONCERN G15.1 Where the SPECIAL CONDITIONS so state: (a) the SELLER and the BUYER intend, and will take all practicable steps (short of an appeal) to procure, that the sale is treated as a TRANSFER of a going concern; and (b) this CONDITION G15 applies.		G19.3 Neither the PRACTITIONER nor the firm or any member of the firm to which the PRACTITIONER belongs has any personal liability in connection with the sale or the performance of the SELLER's obligations. The TRANSFER is to include a declaration excluding that personal liability.	
G11.6 If those ARREARS are not OLD ARREARS the SELLER is to assign to the BUYER all rights that the SELLER has to recover those ARREARS.		G15.2 The SELLER confirms that the SELLER: (a) is registered for VAT, either in the SELLER's name or as a member of the same VAT group; and (b) has (unless the sale is a standard-rated supply) made in relation to the LOT a VAT OPTION that remains valid and will not be revoked before COMPLETION.		G19.4 The LOT is sold (a) in its condition at COMPLETION; (b) for such title as the SELLER may have; and (c) with no title guarantee; and the BUYER has no right to terminate the CONTRACT or any other remedy if information provided about the LOT is inaccurate, incomplete or missing.	
<i>Part 3 – BUYER not to pay for ARREARS</i> G11.7 Part 3 of this CONDITION G11 applies where the SPECIAL CONDITIONS (a) so state; or (b) give no details of any ARREARS.		G15.3 The BUYER confirms that (a) it is registered for VAT, either in the BUYER'S name or as a member of a VAT group; (b) it has made, or will make before COMPLETION, a VAT OPTION in relation to the LOT and will not revoke it before or within three months after COMPLETION; (c) article 5(2B) of the Value Added Tax (Special Provisions) Order 1995 does not apply to it; and (d) it is not buying the LOT as a nominee for another person.		G19.5 Where relevant: (a) the DOCUMENTS must include certified copies of those under which the PRACTITIONER is appointed, the DOCUMENT of appointment and the PRACTITIONER'S acceptance of appointment; and (b) the SELLER may require the TRANSFER to be by the lender exercising its power of sale under the Law of Property Act 1925.	
G11.8 While any ARREARS due to the SELLER remain unpaid the BUYER must: (a) try to collect them in the ordinary course of management but need not take legal proceedings or forfeit the TENANCY; (b) pay them to the SELLER within five BUSINESS DAYS of receipt in cleared funds (plus interest at the INTEREST RATE calculated on a daily basis for each subsequent day's delay in payment); (c) on request, at the cost of the SELLER, assign to the SELLER or as the SELLER may direct the right to demand and sue for OLD ARREARS, such assignment to be in such form as the SELLER'S conveyancer may reasonably require; (d) if reasonably required, allow the SELLER'S conveyancer to have on loan the counterpart of any TENANCY against an undertaking to hold it to the BUYER's order; (e) not without the consent of the SELLER release any tenant or surety from liability to pay ARREARS or accept a surrender of or forfeit any TENANCY under which ARREARS are due; and (f) if the BUYER disposes of the LOT prior to recovery of all ARREARS obtain from the BUYER'S successor in title a covenant in favour of the SELLER in similar form to part 3 of this CONDITION G11.		G15.4 The BUYER is to give to the SELLER as early as possible before the AGREED COMPLETION DATE evidence (a) of the BUYER'S VAT registration; (b) that the BUYER has made a VAT OPTION; and (c) that the VAT OPTION has been notified in writing to HM Revenue and Customs; and if it does not produce the relevant evidence at least two BUSINESS DAYS before the AGREED COMPLETION DATE, CONDITION G14.1 applies at COMPLETION.		G19.6 The BUYER understands this CONDITION G19 and agrees that it is fair in the circumstances of a sale by a PRACTITIONER.	
G11.9 Where the SELLER has the right to recover ARREARS it must not without the BUYER'S written consent bring insolvency proceedings against a tenant or seek the removal of goods from the LOT.		G15.5 The BUYER confirms that after COMPLETION the BUYER intends to (a) retain and manage the LOT for the BUYER'S own benefit as a continuing business as a going concern subject to and with the benefit of the TENANCIES; and (b) collect the rents payable under the TENANCIES and charge VAT on them.		G20 TUPE G20.1 If the SPECIAL CONDITIONS state "there are no employees to which TUPE applies", this is a warranty by the SELLER to this effect.	
G12 MANAGEMENT G12.1 This CONDITION G12 applies where the LOT is sold subject to TENANCIES.		G15.6 If, after COMPLETION, it is found that the sale of the LOT is not a TRANSFER of a going concern then: (a) the SELLER's conveyancer is to notify the BUYER's conveyancer of that finding and provide a VAT invoice in respect of the sale of the LOT; (b) the BUYER must within five BUSINESS DAYS of receipt of the VAT invoice pay to the SELLER the VAT due; and (c) if VAT is payable because the BUYER has not complied with this CONDITION G15, the BUYER must pay and indemnify the SELLER against all costs, interest, penalties or surcharges that the SELLER incurs as a result.		G20.2 If the SPECIAL CONDITIONS do not state "there are no employees to which TUPE applies" the following paragraphs apply: (a) The SELLER must notify the BUYER of those employees whose CONTRACTS of employment will TRANSFER to the BUYER on COMPLETION (the "Transferring Employees"). This notification must be given to the BUYER not less than 14 days before COMPLETION. (b) The BUYER confirms that it will comply with its obligations under TUPE and any SPECIAL CONDITIONS in respect of the TRANSFERring Employees. (c) The BUYER and the SELLER acknowledge that pursuant and subject to TUPE, the CONTRACTS of employment between the TRANSFERring Employees and the SELLER will TRANSFER to the BUYER on COMPLETION. (d) The BUYER is to keep the SELLER indemnified against all liability for the TRANSFERring Employees after COMPLETION.	
G12.2 The SELLER is to manage the LOT in accordance with its standard management policies pending COMPLETION.		G16 CAPITAL ALLOWANCES G16.1 This CONDITION G16 applies where the SPECIAL CONDITIONS state that there are capital allowances available in respect of the LOT.		G21 ENVIRONMENTAL G21.1 This CONDITION G21 only applies where the SPECIAL CONDITIONS so provide.	
G12.3 The SELLER must consult the BUYER on all management issues that would affect the BUYER after COMPLETION (such as, but not limited to, an application for licence; a rent review; a variation, surrender, agreement to surrender or proposed forfeiture of a TENANCY; or a new TENANCY or agreement to grant a new TENANCY) and: (a) the SELLER must comply with the BUYER's reasonable requirements unless to do so would (but for the indemnity in paragraph (c)) expose		G16.2 The SELLER is promptly to supply to the BUYER all information reasonably required by the BUYER in		G21.2 The SELLER has made available such reports as the SELLER has as to the environmental condition of the LOT and has given the BUYER the opportunity to carry out investigations (whether or not the BUYER has read those reports or carried out any investigation) and the BUYER admits that the PRICE takes into account the environmental condition of the LOT	
				G21.3 The BUYER agrees to indemnify the SELLER in respect of all liability for or resulting from the environmental condition of the LOT.	
				G22 SERVICE CHARGE G22.1 This CONDITION G22 applies where the LOT is sold subject to TENANCIES that include service charge provisions.	
				G22.2 No apportionment is to be made at COMPLETION in respect of service charges.	
				G22.3 Within two months after COMPLETION the SELLER must provide to the BUYER a detailed service charge account for the service charge year current on COMPLETION showing: (a) service charge expenditure attributable to each TENANCY; (b) payments on account of service charge received from each tenant; (c) any amounts due from a tenant that have not	

	been received; (d) any service charge expenditure that is not attributable to any TENANCY and is for that reason irrecoverable.	G25 G25.1	WARRANTIES Available warranties are listed in the SPECIAL CONDITIONS.		
G22.4	In respect of each TENANCY, if the service charge account shows: (a) that payments that the tenant has made on account exceed attributable service charge expenditure, the SELLER must pay to the BUYER an amount equal to that excess when it provides the service charge account; or (b) that attributable service charge expenditure exceeds payments made on account, the BUYER must use all reasonable endeavours to recover the shortfall from the tenant as soon as practicable and promptly pay the amount so recovered to the SELLER; but in respect of payments on account that are still due from a tenant CONDITION G11 (ARREARS) applies.	G25.2	Where a warranty is assignable the SELLER must: (a) on COMPLETION assign it to the BUYER and give notice of assignment to the person who gave the warranty; and (b) apply for (and the SELLER and the BUYER must use all reasonable endeavours to obtain) any consent to assign that is required. If consent has not been obtained by COMPLETION the warranty must be assigned within five BUSINESS DAYS after the consent has been obtained.	G2.4	If a cheque for all or part of the deposit is not cleared on first presentation the SELLER may treat the CONTRACT as at an end and bring a claim against the BUYER for breach of contract"
G22.5	In respect of service charge expenditure that is not attributable to any TENANCY the SELLER must pay the expenditure incurred in respect of the period before ACTUAL COMPLETION DATE and the BUYER must pay the expenditure incurred in respect of the period after ACTUAL COMPLETION DATE. Any necessary monetary adjustment is to be made within five BUSINESS DAYS of the SELLER providing the service charge account to the BUYER.	G25.3	If a warranty is not assignable the SELLER must after COMPLETION: (a) hold the warranty on trust for the BUYER; and (b) at the BUYER's cost comply with such of the lawful instructions of the BUYER in relation to the warranty as do not place the SELLER in breach of its terms or expose the SELLER to any liability or penalty.	G30.2 18.3	LANDLORD AND TENANT ACT 1987 The following provisions shall apply in addition to those set out in GENERAL CONDITION 18: Where the provisions of the Landlord and Tenant Act 1987 and/or the Housing Act 1996 ("the Acts") apply to the sale of the LOT and the qualifying tenants have served all relevant notices in accordance with the Acts and have appointed a nominee with the intention of acquiring the SELLER's interest in the LOT, the SELLER will inform the BUYER of this as soon as possible after the date of the CONTRACT and of whether the nominee elects to accept the terms of and take over the benefit and burden of the CONTRACT and purchase the LOT.
G22.6	If the SELLER holds any reserve or sinking fund on account of future service charge expenditure or a depreciation fund: (a) the SELLER must pay it (including any interest earned on it) to the BUYER on COMPLETION; and (b) the BUYER must covenant with the SELLER to hold it in accordance with the terms of the TENANCIES and to indemnify the SELLER if it does not do so.	G26 NO ASSIGNMENT G27 G27.1	The BUYER must not assign, mortgage or otherwise TRANSFER or part with the whole or any part of the BUYER's interest under this CONTRACT. REGISTRATION AT THE LAND REGISTRY This CONDITION G27.1 applies where the LOT is leasehold and its sale either triggers first registration or is a registrable disposition. The BUYER must at its own expense and as soon as practicable: (a) procure that it becomes registered at the Land Registry as proprietor of the LOT; (b) procure that all rights granted and reserved by the lease under which the LOT is held are properly noted against the affected titles; and (c) provide the SELLER with an official copy of the register relating to such lease showing itself registered as proprietor.	18.4	If the nominee does elect to purchase the LOT in accordance with the Acts and pays a deposit to the SELLER or the AUCTIONEERS in accordance with the CONTRACT: (a) the SELLER will repay any deposit paid in accordance with the CONTRACT to the BUYER but without any additional payment relating to interest (b) the CONTRACT shall have effect as if the nominee had entered into it and the agreement with the BUYER shall be null and void and of no further effect but without prejudice to the rights of the SELLER in respect of any previous breach by the BUYER (c) the BUYER shall take all necessary steps to cancel any registrations at Land Registry or Land Charges Registry entered in respect of the agreement for the sale of the LOT to the BUYER (d) completion of the sale of the LOT to the nominee shall take place 22 BUSINESS DAYS after the day on which the nominee complies with the provisions of the Acts and takes over the CONTRACT (e) the nominee shall immediately pay to the AUCTIONEERS the buyer's fee referred to in the Auctioneers' Pre-Sale Announcements printed towards the front of the CATALOGUE
G23 G23.1	RENT REVIEWS This CONDITION G23 applies where the LOT is sold subject to a TENANCY under which a rent review due on or before the ACTUAL COMPLETION DATE has not been agreed or determined.	G27.2	This CONDITION G27.2 applies where the LOT comprises part of a registered title. The BUYER must at its own expense and as soon as practicable: (a) apply for registration of the TRANSFER; (b) provide the SELLER with an official copy and title plan for the BUYER's new title; and (c) join in any representations the SELLER may properly make to the Land Registry relating to the application.	18.5	If the nominee does not comply with the provisions of the Acts COMPLETION shall be 30 BUSINESS DAYS after the date of the SALE MEMORANDUM or (if earlier) a date (not earlier than 10 BUSINESS DAYS after the date of the SALE MEMORANDUM) which is 10 BUSINESS DAYS after the SELLER notifies the BUYER in writing that the nominee has served or is deemed to have served notice of withdrawal under the Acts.
G23.2	The SELLER may continue negotiations or rent review proceedings up to the ACTUAL COMPLETION DATE but may not agree the level of the revised rent or commence rent review proceedings without the written consent of the BUYER, such consent not to be unreasonably withheld or delayed.	G28 G28.1	NOTICES AND OTHER COMMUNICATIONS All communications, including notices, must be in writing. Communication to or by the SELLER or the BUYER may be given to or by their conveyancers.		
G23.3	Following COMPLETION the BUYER must complete rent review negotiations or proceedings as soon as reasonably practicable but may not agree the level of the revised rent without the written consent of the SELLER, such consent not to be unreasonably withheld or delayed.	G28.2	A communication may be relied on if: (a) delivered by hand; or (b) made electronically and personally acknowledged (automatic acknowledgement does not count); or (c) there is proof that it was sent to the address of the person to whom it is to be given (as specified in the SALE MEMORANDUM) by a postal service that offers normally to deliver mail the next following BUSINESS DAY.		
G23.4	The SELLER must promptly: (a) give to the BUYER full details of all rent review negotiations and proceedings, including copies of all correspondence and other papers; and (b) use all reasonable endeavours to substitute the BUYER for the SELLER in any rent review proceedings.	G28.3	A communication is to be treated as received: (a) when delivered, if delivered by hand; or (b) when personally acknowledged, if made electronically; but if delivered or made after 1700 hours on a BUSINESS DAY a communication is to be treated as received on the next BUSINESS DAY.	G30.3 LEASES	With regard to the Landlord & Tenant (Covenants) Act 1995 ("the 1995 Act"): (a) the SELLER may within the period commencing on the date of the SALE MEMORANDUM up to COMPLETION serve notice on any tenant of the LOT in accordance with the 1995 Act requesting a complete release of the SELLER from future liability under the lessor covenants contained in any relevant TENANCIES
G23.5	The SELLER and the BUYER are to keep each other informed of the progress of the rent review and have regard to any proposals the other makes in relation to it.	G28.4	A communication sent by a postal service that offers normally to deliver mail the next following BUSINESS DAY will be treated as received on the second BUSINESS DAY after it has been posted.		(b) If the SELLER serves any such notice the SELLER shall use reasonable endeavours to obtain such a release without being obliged to apply to the Court for a declaration and the BUYER agrees promptly to supply at the BUYER's cost such information as the SELLER reasonably requires to satisfy the tenant under any relevant TENANCY or the Court that it is reasonable to grant the release requested
G23.6	When the rent review has been agreed or determined the BUYER must account to the SELLER for any increased rent and interest recovered from the tenant that relates to the SELLER's period of ownership within five BUSINESS DAYS of receipt of cleared funds.	G29 CONTRACTS (RIGHTS OF THIRD PARTIES) ACT 1999	No one is intended to have any benefit under the CONTRACT pursuant to the CONTRACTs (Rights of Third Parties) Act 1999.		(c) In the event of the SELLER failing to obtain any such release from the said covenants by COMPLETION or not serving any such notice then, in the TRANSFER, the BUYER shall covenant with the SELLER: (i) to serve notice in writing on the SELLER on completion or within 5 BUSINESS DAYS after completion of the transfer of the LOT or any part of it by the BUYER to any transferee of the BUYER (ii) until such time (if ever) that the SELLER is released from the lessor's covenants in any relevant TENANCY, the BUYER will obtain a covenant from its transferee in favour of the SELLER in identical form (mutatis mutandis) to this clause and the parties will apply to the Chief Land Registrar to enter in the Proprietorship Register of the title to the property transferred a restriction preventing the registration of any further transfer of the property except under an Order of the Registrar unless the application is accompanied by a certificate by the solicitors of the registered proprietor stating either that the provisions of this clause have been performed or that the SELLER has been fully released from future liability under the covenants contained in any relevant TENANCY
G23.7	If a rent review is agreed or determined before COMPLETION but the increased rent and any interest recoverable from the tenant has not been received by COMPLETION the increased rent and any interest recoverable is to be treated as ARREARS.	G30 G30.1	EXTRA GENERAL CONDITIONS DEPOSIT GENERAL CONDITION G2 shall be deemed to be deleted in its entirety and shall be replaced by the following: DEPOSIT The amount of the deposit is the greater of: (a) any minimum deposit stated in the AUCTION CONDUCT CONDITIONS (or the total PRICE if this is less than that minimum); and (b) 10% of the PRICE (exclusive of any VAT on the PRICE)		
G23.8	The SELLER and the BUYER are to bear their own costs in relation to rent review negotiations and proceedings.	G2 G2.1	The deposit: (a) must be paid to the AUCTIONEERS in pounds sterling by debit card or banker's draft drawn on an APPROVED FINANCIAL INSTITUTION (or by any other means that the AUCTIONEERS may accept) and (b) is to be held as agent for the SELLER unless the SPECIAL CONDITIONS expressly state otherwise. Provided That where VAT would be chargeable on the deposit were it to be held as agent for the SELLER, the deposit will be held as stakeholder despite any contrary provision in any CONDITION		
G24 G24.1	TENANCY RENEWALS This CONDITION G24 applies where the tenant under a TENANCY has the right to remain in occupation under part II of the Landlord and Tenant Act 1954 (as amended) and references to notices and proceedings are to notices and proceedings under that Act.	G2.2	Where the AUCTIONEERS hold the deposit as stakeholder, then: (a) they are entitled with the consent and irrevocable authority of the BUYER (which the BUYER hereby acknowledges and grants) to release such deposit to the SELLER's solicitors upon receipt by the AUCTIONEERS of written confirmation from the SELLER's solicitors that COMPLETION has taken place and, for the avoidance of doubt, upon the AUCTIONEERS releasing the deposit, their liability as stakeholder shall be discharged (b) if COMPLETION does not take place, the AUCTIONEERS are authorised (and the SELLER and the BUYER acknowledge and irrevocably confirm their agreement to such authority) to	G30.4 BUYER'S FEE	The BUYER and, where applicable, the nominee appointed by qualifying tenants under the provisions of the Landlord & Tenant Act 1987 (as amended by the Housing Act 1996) shall be jointly and separately liable to pay to the AUCTIONEERS the buyer's fee referred to in the Auctioneers' Pre-Sale Announcements printed towards the front of the CATALOGUE. The buyer's fee is payable in respect of each LOT purchased.
G24.2	Where practicable, without exposing the SELLER to liability or penalty, the SELLER must not without the written consent of the BUYER (which the BUYER must not unreasonably withhold or delay) serve or respond to any notice or begin or continue any proceedings.	G2.3	Where the AUCTIONEERS hold the deposit as stakeholder, then: (a) they are entitled with the consent and irrevocable authority of the BUYER (which the BUYER hereby acknowledges and grants) to release such deposit to the SELLER's solicitors upon receipt by the AUCTIONEERS of written confirmation from the SELLER's solicitors that COMPLETION has taken place and, for the avoidance of doubt, upon the AUCTIONEERS releasing the deposit, their liability as stakeholder shall be discharged (b) if COMPLETION does not take place, the AUCTIONEERS are authorised (and the SELLER and the BUYER acknowledge and irrevocably confirm their agreement to such authority) to		
G24.3	If the SELLER receives a notice the SELLER must send a copy to the BUYER within five BUSINESS DAYS and act as the BUYER reasonably directs in relation to it.				
G24.4	Following COMPLETION the BUYER must: (a) with the co-operation of the SELLER take immediate steps to substitute itself as a party to any proceedings; (b) use all reasonable endeavours to conclude any proceedings or negotiations for the renewal of the TENANCY and the determination of any interim rent as soon as reasonably practicable at the best rent or rents reasonably obtainable; and (c) if any increased rent is recovered from the tenant (whether as interim rent or under the renewed TENANCY) account to the SELLER for the part of that increase that relates to the SELLER's period of ownership of the LOT within five BUSINESS DAYS of receipt of cleared funds.				
G24.5	The SELLER and the BUYER are to bear their own costs in relation to the renewal of the TENANCY and any proceedings relating to this.				

SELL YOUR PROPERTY UNDER THE HAMMER WITH ONE OF THE UK'S LARGEST AUCTION NETWORKS

CHESHIRE & NORTH WALES

Chester Racecourse
Call 01244 401 100

NORTH WEST

AJ Bell Stadium, Manchester
Call 0161 774 7333

NOTTINGHAM

Racecourse
Call 0115 958 8702

LEICESTER

King Power Stadium
Call 0116 254 9654

STOKE

bet365 Stadium
Call 01782 481 232

DERBY

Pride Park Stadium
Call 01332 242 880

BIRMINGHAM

Villa Park
Call 0121 233 5046

ENTRIES ARE NOW INVITED FOR OUR NEXT AUCTIONS

MEMBERSHIP CARD

Save time at
the registration
desk with our new
membership card

REMOTE BIDDING

Bid by proxy,
telephone or
internet if you
can't make the
room

BOOK VIEWINGS ONLINE

Visit our website
to book viewings
for all lots.

ONLINE AUCTIONS

Sell online & get
greater flexibility
in a timescale to
suit you

Derby

Wednesday 13th February
Thursday 11th April
Friday 24th May
Thursday 25th July
Thursday 5th September
Friday 25th October
Friday 13th December

01332 242 880

Cheshire & North Wales

Thursday 21st February
Thursday 4th April
Wednesday 5th June
Thursday 22nd August
Thursday 10th October
Thursday 28th November

01244 401 100

North West

Thursday 21st February
Thursday 4th April
Wednesday 5th June
Thursday 22nd August
Thursday 10th October
Thursday 28th November

0161 774 7333

Birmingham

Thursday 14th February
Thursday 21st March
Thursday 23rd May
Thursday 18th July
Thursday 12th September
Thursday 24th October
Thursday 12th December

0121 233 5046

Leicester

Tuesday 12th February
Monday 8th April
Tuesday 21st May
Tuesday 23rd July
Tuesday 3rd September
Tuesday 22nd October
Tuesday 10th December

0116 254 9654

Nottingham

Friday 15th February
Tuesday 9th April
Wednesday 22nd May
Wednesday 24th July
Wednesday 4th September
Wednesday 23rd October
Wednesday 11th December

0115 958 8702

