

elwell taylor

Shakestones Farm
Chelmsford

£26,500 Per annum

4417 sqft

- TO LET - OPEN PLAN
AGRICULTURAL UNIT
- OFFICE AREA
- GOOD TRANSPORT LINKS VIA
A414/A12



LOCATION

The property is located on Shakestones Farm, Writtle, and is situated close to Highlands Park & Widford Industrial Estate. Good transport links are available via the nearby A414 & A12.

DESCRIPTION

An open plan warehouse unit with an office area suitable for a variety of agricultural uses.

The warehouse has a concrete floor, translucent roof panels, 3-phase power. Shared WC facilities are available on site.

ACCOMMODATION

Gross internal area: 4,417 sq ft (410 sq m)

TERMS

The property is available on a new full repairing and insuring lease for a term to be agreed at a rent of £26,500 per annum.

LEGAL COSTS

Each party to be responsible for their own legal costs.



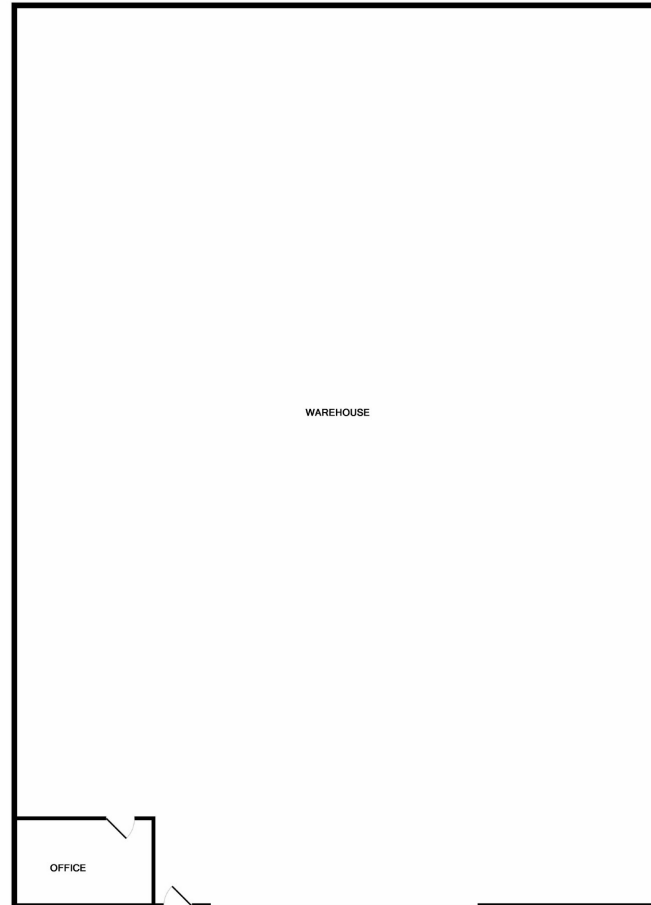

TOTAL APPROX. FLOOR AREA 4417 SQ.FT. (410.3 SQ.M.)
Whilst every attempt has been made to ensure the accuracy of the floor plan contained here, measurements of doors, windows, rooms and any other items are approximate and no responsibility is taken for any error, omission, or mis-statement. This plan is for illustrative purposes only and should be used as such by any prospective purchaser. The services, systems and appliances shown have not been tested and no guarantee as to their operability or efficiency can be given.
Made with Metapix 02019

Elwell Taylor for themselves and for the vendors or lessors of this property whose agents they are give notice that : (1) The particulars are set out as a general outline only for the guidance of intending purchasers or lessees, and do not constitute, nor constitute part of, an offer or contract; (2) all descriptions, dimensions, references to condition and necessary permissions for use and occupation and other details are given without responsibility and any intending purchasers or lessees should not rely on them as statements or representations of fact but must satisfy themselves by inspections or otherwise as to the correctness of each of them; (3) No person in the employment of Elwell Taylor has any authority to make or given any representation or warranty whatever in relation to this property.