

**AUCTION  
HOUSE**

**MANCHESTER**

**Tuesday**  
**9th July 2019**  
**2.00pm**

The Etihad Stadium  
93.20 Central  
Manchester City Football Club  
Sport City  
Manchester M11 3FF



# AUCTION VENUE



**Tuesday 9th July 2019**  
**2.00pm**

The Etihad Stadium  
93.20 Central  
Manchester City Football Club  
Sport City  
Manchester M11 3FF



Visitors directions on the day

Everyone attending the auction should enter via gate 7 on Ashton New Road (A662) and park in the adjacent Car Park. The 93.20 Central is accessible via the South Stand Reception (Near M2) and overlooks Ashton New Road.

Now Taking Entries for our next auction

**3rd September 2019**

Please call for your free appraisal

**0161 925 3254**

**AUCTION  
HOUSE**

**MANCHESTER**

[auctionhouse.co.uk/manchester](http://auctionhouse.co.uk/manchester)



# MESSAGE FROM THE AUCTIONEERS



Ian Hill BSc (EstMan)  
FRICS  
Director



Amanda Lamont  
MNAVA  
Manager/Valuer



Victoria Hindle  
Registration



Yvette Taylor  
Administrator



Sarah Lynn  
Administrator

## Auction House exceeds 1,400 Lots Sold one month earlier than last year

At a time when most Auctioneers and Estate Agents are reporting reduced stock levels this is an outstanding result especially as it represents a 76% success rate. Largely we put this down to sellers preferring to sell in-region through a local auctioneer and the good prices being achieved in our Manchester Auctions.

Without doubt we are seeing a huge increase in enquiries, particularly from the South East, from potential buyers looking to acquire properties in the North West of the country, seeking to take advantage of strong returns on investment properties and the opportunity to add value to existing poorer quality property.

Rental returns continue to outperform anything that can be obtained from Banks and Building Societies which makes tenanted properties very attractive to investors. The great advantage is that the tenants stay in-situ, so rent continues to be received by the seller until completion, and by the buyer from their date of purchase.

We expect that the climate over the coming months will remain challenging for all involved in the property sector, but sellers will always have auction available as a speedy exit solution for surplus properties, whether they are vacant or tenanted. Buyers benefit as well with, more choice, an increased number of bargain priced Lots and affordable lending.

Today, as usual, we have Lots available to suit every pocket and taste. From Lots with a Nil Reserve up to the Lock House Guided at £250,000 surely the perfect opportunity, for the canal and boating enthusiast, to create that dream waterside home. In between we have a variety of tenanted and vacant properties plus a variety of land opportunities.

Good Luck with your bidding!

Ian Hill  
Director

## INTRODUCING AGENTS



## NEXT AUCTION DATES

3rd September 2019 • 22nd October 2019 • 10th December 2019

# AUCTION INFORMATION



**Administration Charge** Purchasers will be required to pay by cheque, an administration charge of 0.6% inc VAT of the purchase price subject to a minimum of £1080.00 (£900 + VAT) or the fixed figure as stated in the property details, in addition to the deposit. A VAT receipt will be issued after the auction. Some lots may carry additional charges, please check the catalogue description and legal pack.



**Attending the Auction** It is always wise to allow sufficient time to get to the auction. Legal packs for most of the properties will be available for inspection. It is important you read these and the final addendum/amendment sheet which will also be available as any purchase will be subject to these.



**Bidding** Each property will be offered individually by the Auctioneer. Ensure that your bids are clear and noticed by the Auctioneer. If you are successful in bidding for the property you will be approached by a member of Auction House staff who will request your personal information and identification. You will then be guided to our administration area and then the cashier desk for payment of the deposit.



**Bidding by Proxy or Telephone** If you are unable to attend the auction you are invited to contact us to discuss special arrangements for bidding by proxy or telephone. A Non-Attending Bid or Telephone Bid form and conditions are included in auction catalogues or can be downloaded from the Bidding Form links on our website.



**Buyers Premium** Purchasers of some lots will be required to pay a Buyers Premium to the auctioneer in addition to the deposit – see individual property details.



**Deposit** When you sign the Memorandum of Sale you will be asked to pay a deposit of 10% of the purchase price subject to a minimum deposit of £5,000. Deposits can only be paid by electronic bank transfer, bankers draft, personal cheque, debit card or building society cheque. Cash or credit card payments will not be accepted. Please note, should the cheque have to be represented, a processing charge of £60.00 (£50.00 + VAT) will be charged by deduction from the deposit.



**Disbursements** Some disbursements may become payable by the purchaser on completion, these will be detailed in the Special Conditions of Sale within the property's Legal Pack.



**Disclaimer** Particulars on the website and within our catalogue are believed to be correct but their accuracy is not guaranteed. Information relating to Rating matters has been obtained by verbal enquiry only. Prospective purchasers are advised to make their own enquiries of the appropriate Authority. All measurements, areas and distances are approximate only. Potential purchasers are advised to check them.



**Energy Performance Certificates (EPCs)** Where required we include EPC ratings within Full Details and on the lot page within our catalogue. When available EPC Graphs can be viewed online at [auctionhouse.co.uk](http://auctionhouse.co.uk).



**General Data Protection Regulations (GDPR)** This defines new customer rights and company obligations introduced on 25th May 2018. For full details please refer to the Privacy Policy showing on our website [www.auctionhouse.co.uk/manchester](http://www.auctionhouse.co.uk/manchester).



**\*Guide Prices** Guide prices quoted online and in the catalogue are provided as an indication of each seller's minimum expectation. They are not necessarily figures which a property will sell for and may change at any time prior to the auction. The sale price will be dependent on bidding in the auction room and on the Vendors' instructions.



**Insurance** On some properties the seller will continue to insure through to completion. Others will need to be insured by the purchaser, and auctioneers advice to all purchasers is that they should consider insuring from the date of exchange.



**Plans, Maps and Photographs** The plans, floorplans, maps, photograph's and video tours published on our website and in the catalogue are to aid identification of the property only. The plans are not to scale.



**Pre Auction Sales** Offers made on property included in this auction may be accepted by the Vendor prior to the auction. In such instances all buyer charges will be payable including the Administration Charge, any Buyers Premium plus all other payments detailed in the Special Conditions of Sale. If you are intending to bid at the auction for a specific lot, we recommend that you keep in contact with the Auctioneer's office.

The Auctioneers or Vendors cannot be held responsible for costs incurred in respect of any lot which is withdrawn or sold prior to auction.



**Post Auction Sales** If a property you are interested in is not sold during the auction please speak to the Auctioneer and make an offer at, above or below the Guide. Your offer will be put forward to the Vendor and if accepted, you will be able to proceed with your purchase under auction rules. Offers should take into account the Administration Charge, any Buyers Premium plus all other payments detailed in the Special Conditions of Sale as all of these are still payable irrespective of the circumstances.



**Proof of Identification** In order to comply with Anti-Money Laundering regulations we ask that all prospective purchasers provide Proof of Identity and Residence. Please bring your passport or photographic UK driving licence and a recent utility bill, bank statement or council tax bill to the auction. If purchasing on behalf of a company you will also need a letter of authority on company letterhead. We will carry out Electronic AML checks on successful buyers and remote bidders. It will include a search with Experian who may check the details you supply against any particulars on any database (public or otherwise) to which they have access. They may also use your details in the future to assist other companies for verification purposes. A record of the search will be retained.



**Reserve Price** Each property will be offered subject to a reserve price which we expect will be set within the guide price range or no more than 10% above a single figure guide. This is a confidential figure set between the Vendor and the Auctioneer just prior to the auction. It is a figure below which the Auctioneer cannot sell the property during the auction. After the auction offers will be sought and considered on Unsold Lots at prices below the reserves.



**Solicitors Details** The name, address and telephone number of the solicitor who will be acting for you in any purchase will be required before you leave the auction room.



**The Catalogue** Details of the property and land to be sold are set out in our catalogue and on our website [auctionhouse.co.uk](http://auctionhouse.co.uk) All lots are sold subject to Special Conditions of Sale. It is important that prospective purchasers satisfy themselves as to the location, boundaries, condition and state of the lots before the auction.



**The Contract** The Memorandum of Sale will be signed in duplicate. One copy will be given to you, which you must give to your solicitor. The second copy will be retained by the Vendors' solicitor. Completion usually takes place after 28 days but this date can vary. The legal pack of each property will state the completion date due. The date may also be announced immediately prior to the commencement of bidding of each lot.



**The Legal Aspect** Buying at auction is a contractual commitment. Before making an offer prior to auction or bidding at the auction or post auction, it is advisable to consult a solicitor regarding the General and Special Conditions of Sale, the local authority search and other legal documentation.



**Viewing** Due to the nature and condition of auction properties we highlight the potential risk that viewing such properties carries and advise all to proceed with caution and take necessary requirements to ensure their own safety whilst viewing any lot in this catalogue. Viewings are conducted entirely at your own risk, these properties are not owned or controlled by Auction House and we cannot be held liable for loss or injury caused while viewing or accessing any Lot.

Due to the nature of some auction properties, electricity may not be turned on therefore viewing times are restricted. Viewers will also have to bring their own lighting/ladders if wanting to inspect cupboards, cellars and roof spaces.

\*\*\*Please refer to the common auction conditions included on our website or at the back of our catalogue\*\*\*



# ORDER OF SALE

**Tuesday 9th July 2019 2.00pm**

The Etihad Stadium, 93.20 Central, Manchester City Football Club, Sport City, Manchester M11 3FF

LOT	ADDRESS	*GUIDE PRICE	LOT TYPE
1	5 Nield Street, Mossley, Lancashire	£40,000+	Residential
2	Land at Ashes Lane, Stalybridge, Cheshire	£45,000 - £55,000	Land
3	Land to the rear of Belfield Road, Accrington	SOLD PRIOR	Land
4	144 Stockfield Mount, Chadderton, Lancashire	£35,000 - £45,000	Residential Investment
5	14 Whiston Road, Manchester	£75,000+	Residential for Improvement
6	57 Tower Street, Heywood, Lancashire	£50,000 - £60,000	Residential
7	2 Bainbridge Road, Oldham, Lancashire	£125,000 - £150,000	Residential
8	2 The Lock House, High Bank Road, Droylsden, Manchester	£250,000+	Residential for Improvement
9	Tonge Green House, Lower Broadacre, Stalybridge, Cheshire	£220,000+	Residential for Improvement
10	Storage Pod GA76, Unit 8 Centurion Park, Blackburn, Lancashire	NIL RESERVE	Commercial
11	6 Stanier Street, Manchester	£90,000 - £110,000	Residential
12	9 Huddersfield Road, Newhey, Rochdale, Lancashire	£75,000+	Residential
13	Land at Irwell Springs, off Greenwood Drive, Bacup, Lancashire	£15,000 - £25,000	Land
14	8 Grelley Walk, Manchester	£65,000 - £75,000	Residential
15	30 Mobberley Road, Bolton, Lancashire	£80,000 - £90,000	Residential Investment
16	3 Storage Pods GB066 GB154 GC013, Ashroyd Business Park, South Yorkshire	NIL RESERVE	Commercial
17	Land adjacent to The River Dane, Middlewich, Cheshire	SOLD PRIOR	Land
18	8 Albany Close, Little Hulton, Lancashire	£100,000 - £120,000	Residential Investment
19	Several Freehold Ground Rents, and Land Lying to the South of Church Street, Whitworth, Lancashire	£500+	Ground Rents
20	Land off Green Lane, Hollingworth, Hyde, Greater Manchester	£70,000 - £90,000	Amenity Land
21	524 Bury Road, Bamford, Rochdale, Lancashire	£100,000 - £120,000	Residential for Improvement
22	10 Bright Street, Oswaldtwistle, Accrington, Lancashire	£45,000 - £55,000	Residential
23	100 Burnley Road, Accrington	£40,000 - £50,000	Residential
24	44 Mayford Road, Manchester	£145,000+	Residential
25	8 Matlock Close, Warrington, Cheshire	£100,000 - £120,000	Residential
26	Land to the West of Bradford Road, Winsford, Cheshire	£3,000 - £5,000	Land
27	696 Huddersfield Road, Oldham, Lancashire	£140,000+	Residential
28	86 Baguley Crescent, Middleton, Manchester	£25,000 - £35,000	Residential
29	Apt.13 The Abode, Sunderland Street, Halifax, West Yorkshire	£20,000 - £30,000	Residential
30	2 The Stables, Frederick Street, Oldham, Lancashire	£100,000 - £120,000	Residential
31	Apt.12 the Gateway, 11-21 Broughton Road, Salford	£35,000 - £45,000	Residential Investment
32	Apt.33 the Gateway, 11-21 Broughton Road, Salford	£45,000 - £55,000	Residential Investment
33	17 Rochdale Road, Shaw, Oldham, Lancashire	£150,000 - £175,000	Residential

**\*Description on Auction Information page**



**Tenure:** See Legal Pack  
**Local Authority:** Tameside Metropolitan Borough Council  
**Energy Performance Rating (EPC):** Current Rating G

## Residential

1

### 5 Nield Street, Mossley, Ashton-Under-Lyne, Lancashire OL5 0PP

**\*GUIDE PRICE**

**£40,000 +** (plus fees)

#### A One Bedroomed End Terraced Cottage

Situated in the popular Top Mossley area with easy access to the shops in the nearby village centre makes this perfect for the First Time Buyer or Buy to let Investor. Briefly comprises, Lounge, Kitchen, Bedroom, Bathroom and Cellar. Whilst the property would benefit from some upgrading this is a great opportunity to acquire a very attractively Guided property in an area where demand is extremely strong.

**Please Note there will be a further Buyers Premium of £1140 including VAT.**

#### Description

**Ground Floor:** Lounge, Kitchen

**First Floor:** Landing, Bedroom, Bathroom

**Cellar**

#### Additional Fees

**Buyer's Premium:** Please Note there will be a further Buyers Premium of £1140 including VAT.

**Administration Charge:** Purchasers will be required to pay an administration fee of 0.6% inc VAT, subject to a minimum of £1080 inc VAT

**Disbursements:** Please see legal pack for any disbursements that may become payable by the purchaser on completion.

[auctionhouse.co.uk](http://auctionhouse.co.uk)

[\\*Description on Auction Information Page](#)



## Land

### Land at Ashes Lane, Stalybridge, Cheshire SK15 2RH

**\*GUIDE PRICE**

**£45,000 - £55,000** (plus fees)

#### Land

The land, more particularly shown edged red on the attached plan, comprises a single plot. The land is most easily approached from the Mottram Old Road end of Ashes Lane and is situated between Nos. 60 and 62 Mottram Old Road. Outline planning for residential development was granted in 1960 for a much larger area, including this site, and confirmation has been obtained from the planning authority that this is still valid, see legal pack for further information. However in September 2007 planning permission, application number 07/01000/FUL was refused for the erection of 1 dwelling, see legal pack for the decision reasons. Interested parties should make their own enquiries of the Local Authority to satisfy themselves that their proposed use of the land is acceptable prior to bidding. The plans on the website and in the catalogue show the approximate boundaries and are for identification purposes only. Precise boundaries will be as shown in the legal pack.



**Tenure:** See legal pack  
**Local Authority:** Tameside Council  
**Energy Performance Rating (EPC):** N/A

#### Additional Fees

**Administration Charge:** Purchasers will be required to pay an administration fee of 0.6% inc VAT, subject to a minimum of £1080 inc VAT

**Disbursements:** Please see legal pack for any disbursements that may become payable by the purchaser on completion.

[auctionhouse.co.uk](http://auctionhouse.co.uk)

[\\*Description on Auction Information Page](#)



## Land

### Land to the Rear of Belfield Road, Accrington, Lancashire BB5 2JD

**\*GUIDE PRICE**

**£20,000 - £30,000** (plus fees)

**Land of Approximately 0.344 Acres Comprising Four Instant Double Garages**

Appealing to all the residents within the surrounding areas!! Land of approximately 0.344 acres with Planning Permission Approved (application number 11/18/0186) in June 2018 and works completed for the erection of concrete garages as replacement for 4 wooden garages. There are sheds/greenhouse on the land to the rear of the garages.

**Please note there is a further Buyers Premium of £1,200 inc VAT payable on this lot.**

**Tenure:** See legal pack

**Local Authority:**

**Energy Performance Rating (EPC):** N/A

#### Additional Fees

**Administration Charge:** Purchasers will be required to pay an administration fee of 0.6% inc VAT, subject to a minimum of £1080 inc VAT

**Disbursements:** Please see legal pack for any disbursements that may become payable by the purchaser on completion.

[auctionhouse.co.uk](http://auctionhouse.co.uk)

[\\*Description on Auction Information Page](#)



**Tenure:** See legal pack

**Local Authority:** Oldham Council

**Energy Performance Rating (EPC):** Current Rating C

## Residential Investments

### 144 Stockfield Mount, Chadderton, Oldham, Lancashire OL9 9AS

**\*GUIDE PRICE**

**£35,000 - £45,000** (plus fees)

**A Tenanted One Bedroomed Top Floor Apartment Producing £4,740pa/£395pcm**

Situated on the 14th Floor of this apartment block which has been extensively improved over recent years this apartment benefits from a tenant who has already been in occupation for two years. Let under the terms of an AST at a rental of £4,740pa/£395pcm. Briefly comprises, Hall, Lounge/Diner, Kitchen, Bedroom and Bathroom. Benefits from Central Heating. Great location with stunning views over Manchester and with easy access to transport links including the Metrolink, a short distance away at Freehold.

#### Description

**Ground Floor:** Communal Entrance

**14th Floor Apartment:** Entrance Hall, Lounge/Diner, Kitchen, Bedroom, Bathroom

#### Additional Fees

**Administration Charge:** Purchasers will be required to pay an administration fee of 0.6% inc VAT, subject to a minimum of £1080 inc VAT

**Disbursements:** Please see legal pack for any disbursements that may become payable by the purchaser on completion.

[auctionhouse.co.uk](http://auctionhouse.co.uk)

[\\*Description on Auction Information Page](#)





## Residential for improvement

5

### 14 Whiston Road, Manchester M8 5AU

**\*GUIDE PRICE**

**£75,000 +** (plus fees)

#### A Three Bedroomed End Terraced House

Situated off Ash Tree Road, close to North Manchester General Hospital and local amenities. The property briefly comprises Two Reception Rooms, Dining Room, Kitchen, Three Bedrooms and a Bathroom. The property requires upgrading/refurbishment throughout, some of which may be structural. There may be contents remaining inside and outside the property upon completion and **please note there is Buyers Premium of £1,140 including VAT.**

#### Description

**Ground Floor:** Entrance Hall, Reception Room One, Reception Room Two, Dining Room, Kitchen

**First Floor:** Landing, Bedroom One, Bedroom Two, Bedroom Three, Bathroom

**Second Floor:** Loft Room

**Outside:** There is a forecourt to the front and a garden to the rear of the property.

#### Additional Fees

**Buyer's Premium:** Please note there is Buyers Premium of £1,140 including VAT.

**Administration Charge:** Purchasers will be required to pay an administration fee of 0.6% inc VAT, subject to a minimum of £1080 inc VAT

**Disbursements:** Please see legal pack for any disbursements that may become payable by the purchaser on completion.

**Tenure:** See legal pack

**Local Authority:** Manchester City Council

**Energy Performance Rating (EPC):** Current Rating F

[auctionhouse.co.uk](http://auctionhouse.co.uk)

[\\*Description on Auction Information Page](#)



## Residential

6

### 57 Tower Street, Heywood, Lancashire OL10 3AD

**\*GUIDE PRICE**

**£50,000 - £60,000** (plus fees)

#### A Three Bedroomed Mid Terraced Property

The property is approximately 500 metres to Heywood Town Centre and within easy access to motorway networks. The accommodation is deceptively spacious and briefly comprises entrance vestibule, lounge, fitted kitchen, three bedrooms and a bathroom/wc. Externally the property has an easy to maintain paved yard to the rear.

**Please Note there will be a further Buyers Premium of £1140 including VAT.**

#### Description

**Ground Floor:** Entrance Vestibule, Lounge, Kitchen/Diner

**First Floor:** Landing, Bedroom One, Bedroom Two, Bedroom Three, Bathroom

**Outside:** There is a paved yard to the rear of the property.

#### Additional Fees

**Buyer's Premium:** Please Note there will be a further Buyers Premium of £1140 including VAT.

**Administration Charge:** Purchasers will be required to pay an administration fee of 0.6% inc VAT, subject to a minimum of £1080 inc VAT

**Disbursements:** Please see legal pack for any disbursements that may become payable by the purchaser on completion.

**Tenure:** See Legal Pack

**Local Authority:** Rochdale Metropolitan Borough Council

**Energy Performance Rating (EPC):** Current Rating E

[auctionhouse.co.uk](http://auctionhouse.co.uk)

[\\*Description on Auction Information Page](#)



# EXPERTS IN AUCTION PROPERTIES

*& on hand to give you legal advice*



SALE



PURCHASE



BUY TO LET



LENDER  
SERVICES



NEW LEASES  
& TITLE SPLITS



PROPERTY  
FINANCE



CONVERSIONS



TENANCY  
AGREEMENTS



AUCTION  
PACKS

Call us today for expert advice: 0800 103 2600  
or visit our website: [www.russellrussell.co.uk](http://www.russellrussell.co.uk)



**Tenure:** See legal pack  
**Local Authority:** Oldham Council  
**Energy Performance Rating (EPC):** Current Rating D



## Residential

### 2 Bainbridge Road, Waterhead, Oldham, Lancashire OL4 2LY

**\*GUIDE PRICE**

**£125,000 - £150,000 (plus fees)**

#### A Spacious Five Bedroomed Semi Detached House

This property is situated in the popular residential area of Waterhead being close to well regarded primary and secondary schools and with easy access to the Metrolink and Oldham Town Centre. Briefly comprises, Porch, Lounge, Dining Room, Kitchen, Shower Room, Conservatory, Five Bedrooms and a Bathroom. Benefiting from a drive way and gardens to the front and rear, Double Glazing and Gas Central Heating.

#### Description

**Ground Floor:** Porch, Lounge, Dining Room, Kitchen, Conservatory, Bedroom Four, Bedroom Five, Shower Room

**First Floor:** Landing, Bedroom One, Bedroom Two, Bedroom Three, Bathroom

**Outside:** To the front is a garden and driveway and also a garden to the rear.

#### Additional Fees

**Administration Charge:** Purchasers will be required to pay an administration fee of 0.6% inc VAT, subject to a minimum of £1080 inc VAT

**Disbursements:** Please see legal pack for any disbursements that may become payable by the purchaser on completion.

[auctionhouse.co.uk](http://auctionhouse.co.uk)

[\\*Description on Auction Information Page](#)



**Tenure:** See legal pack  
**Local Authority:** Tameside Council  
**Energy Performance Rating (EPC):** Current Rating TBC



## Residential for improvement

### 2 The Lock House, High Bank Road, Droylsden, Manchester M43 6FS

**\*GUIDE PRICE**

**£250,000 + (plus fees)**

#### A Four Bedroomed Detached Grade II Property

Occupying a prime location adjacent to the Ashton Canal and only a short distance from the Droylsden Marina this detached property, whilst requiring a modernisation programme, offers the opportunity to create a stunning family home. Offering extensive internal space briefly comprising, Hall, Lounge, Dining Room, Sitting Room, Kitchen, Utility Room, Four Bedrooms and Bathroom together with a good sized garden and ample parking space makes this a perfect refurbishment project with the opportunity to add significant value. There may be some contents internally and externally remaining at the property on completion.

#### Description

**Ground Floor:** Entrance Hall, Lounge, Sitting Room, Dining Room, Kitchen, Utility

**First Floor:** Landing, Bedroom One, Bedroom Two, Bedroom Three, Bedroom Four, Bathroom

**Outside:** There is car parking space to the front and to the rear, overlooking the canal, is a good sized garden and store.

#### Additional Fees

**Administration Charge:** Purchasers will be required to pay an administration fee of 0.6% inc VAT, subject to a minimum of £1080 inc VAT

**Disbursements:** Please see legal pack for any disbursements that may become payable by the purchaser on completion.

[auctionhouse.co.uk](http://auctionhouse.co.uk)

[\\*Description on Auction Information Page](#)



## Residential for Improvement

9

### Tonge Green House, Lower Broadcare, Stalybridge, Cheshire SK15 2UE

**\*GUIDE PRICE**

**£220,000 +** (plus fees)

#### A Grade II Listed Four Bedroomed Detached Property

This property is within a sought after location, close to a range of local amenities and approximately 2½ miles from junction 4 of the M67 motorway. The property requires refurbishment/renovation and would be suitable for a builder. Briefly comprising lounge, dining room, two reception rooms, kitchen, four bedrooms, bathroom, separate WC and a loft room. Please note there may be some contents remaining in the property upon completion.

**There is a further buyers premium of £1,140 inc VAT payable on this lot.**

#### Description

**Ground Floor:** Entrance Hall, Lounge, Dining Room, Reception Room One, Kitchen, Reception Room Two

**First Floor:** Landing, Bedroom One with En-suite, Bedroom Two, Bedroom Three, Bedroom Four, Bathroom, Separate WC

**Second Floor:** Loft Room

**Outside:** There are gardens to the front and rear of the property with the benefit of off road parking.

**Tenure:** See legal pack

**Local Authority:** Tameside Council

**Energy Performance Rating (EPC):** N/A

#### Additional Fees

**Buyer's Premium:** There is a further buyers premium of £1,140 inc VAT payable on this lot.

**Administration Charge:** Purchasers will be required to pay an administration fee of 0.6% inc VAT, subject to a minimum of £1080 inc VAT

**Disbursements:** Please see legal pack for any disbursements that may become payable by the purchaser on completion.

[auctionhouse.co.uk](http://auctionhouse.co.uk)

[\\*Description on Auction Information Page](#)



## Commercial

10

### Storage Pod GA76, Unit 8 Centurion Business Park, Blackburn, Lancashire BB1 2QY

**\*GUIDE PRICE**

**NIL RESERVE** (plus fees)

#### Vacant Storage Unit 100sq ft/9.30sq m

A secure, lock up storage unit in a modern purpose built warehouse facility. Not inspected by Auction House Manchester but we are advised, by the vendor, that it comprises approximately 100sq ft/ 9.30sqm. On-site facilities include, car parking, canteen, office accommodation and CCTV. Located within 1 mile of Junction 5 of the M65 Motorway. Perfect for using to declutter your house!

**Please note there is a further buyers premium of £1,200 inc VAT.**

**Tenure:** See legal pack

**Local Authority:** Blackburn and Darwen Council

**Energy Performance Rating (EPC):** N/A

#### Additional Fees

**Buyer's Premium:** Please note there is a further buyers premium of £1,200 inc VAT.

**Administration Charge:** Purchasers will be required to pay an administration fee of 0.6% inc VAT, subject to a minimum of £1080 inc VAT

**Disbursements:** Please see legal pack for any disbursements that may become payable by the purchaser on completion.

[auctionhouse.co.uk](http://auctionhouse.co.uk)

[\\*Description on Auction Information Page](#)





**Tenure:** See legal pack

**Local Authority:** Manchester City Council

**Energy Performance Rating (EPC):** Current Rating TBC

11

## Residential

### 6 Stainer Street, Manchester M9 4JZ

**\*GUIDE PRICE**

**£90,000 - £110,000 (plus fees)**

#### A Three Bedroomed Semi Detached Property

This property is situated in a popular residential area, close to local amenities and transport links to Manchester City Centre. Briefly comprising lounge, kitchen/diner, three bedrooms and a bathroom with the benefit of gas central heating and double glazing. Please note that there may contents remaining inside and outside the property upon completion.

#### Description

**Ground Floor:** Lounge, Kitchen/Diner

**First Floor:** Landing, Bedroom One, Bedroom Two, Bedroom Three, Bathroom

**Outside:** There are gardens to the front and to the rear of the property

#### Additional Fees

**Administration Charge:** Purchasers will be required to pay an administration fee of 0.6% inc VAT, subject to a minimum of £1080 inc VAT

**Disbursements:** Please see legal pack for any disbursements that may become payable by the purchaser on completion.

[auctionhouse.co.uk](http://auctionhouse.co.uk)

[\\*Description on Auction Information Page](#)



**Tenure:** See Legal Pack

**Local Authority:** Rochdale Metropolitan Borough Council

**Energy Performance Rating (EPC):** Current Rating D

12

## Residential

### 9 Huddersfield Road, Newhey, Rochdale, Lancashire OL16 3RU

**\*GUIDE PRICE**

**£75,000 + (plus fees)**

#### A Two Bedroomed Mid Terraced House

Offering very spacious accommodation this renovated mid terraced house would suit both the Owner Occupier and Buy to Let investor. An inspection is needed to appreciate the accommodation on offer which comprises, Hall, Lounge, Dining Room, Kitchen, Morning Room, Three Bedrooms and Bathroom. Benefits from Gas Central Heating and Double Glazing. To the rear is an enclosed yard. Excellent location close to all amenities including a Metrolink Station so ideal for a commuter.

#### Description

**Ground Floor:** Hall, Lounge, Dining Room, Kitchen, Morning Room

**First Floor:** Landing, Bedroom One, Bedroom Two, Bedroom Three, Bathroom

#### Additional Fees

**Administration Charge:** Purchasers will be required to pay an administration fee of 0.6% inc VAT, subject to a minimum of £1080 inc VAT

**Disbursements:** Please see legal pack for any disbursements that may become payable by the purchaser on completion.

[auctionhouse.co.uk](http://auctionhouse.co.uk)

[\\*Description on Auction Information Page](#)



## Land

13

### Land at Irwell Springs off Greenwood Drive, Wier, Bacup, Lancashire OL13 8QX

**\*GUIDE PRICE**

**£15,000 - £25,000 (plus fees)**

**Land comprising Approximately 1 Acre/0.4 Hectares**

The land, more particularly shown edged red on the plan, comprises an area of sloping land comprising approximately 1 Acre/0.61 Hectares. The land would be suitable for a variety of amenity uses, however, interested parties should make their own enquiries of the Local Authority to satisfy themselves that their proposed use of the land is acceptable prior to bidding. The plans on the website and in the catalogue show the approximate boundaries and are for identification purposes only. Precise boundaries will be as shown in the legal pack.

**Please note there is a further Buyers Premium of £1,500 inc VAT payable on this Lot.**

**Tenure:** See legal pack

**Local Authority:** Rossendale Council

**Energy Performance Rating (EPC):** N/A

#### Additional Fees

**Buyers Premium:** Please note there is a further Buyers Premium of £1,500 inc VAT payable on this Lot.

**Administration Charge:** Purchasers will be required to pay an administration fee of 0.6% inc VAT, subject to a minimum of £1080 inc VAT

**Disbursements:** Please see legal pack for any disbursements that may become payable by the purchaser on completion.

[auctionhouse.co.uk](http://auctionhouse.co.uk)

[\\*Description on Auction Information Page](#)



## Residential

14

### 8 Grelley Walk, Rusholme, Manchester M14 5UG

**\*GUIDE PRICE**

**£65,000 - £75,000 (plus fees)**

**A Vacant One Bedroomed First Floor Flat**

Perfect for a Buy to Let Landlord or owner occupier!! Situated close to Wilmslow Road and all of the amenities surrounding this popular street. The flat is ready to move into and comprises entrance hallway, lounge with balcony, kitchen, double bedroom and a bathroom with the benefit of gas central heating and double glazing throughout.

#### Description

**Ground Floor:** Entrance and stairs leading to the first floor.

**First Floor:** Landing, Lounge, Kitchen, Bedroom, Bathroom

**Outside:** There is a communal gated garden.

**Tenure:** See Legal Pack

**Local Authority:** Manchester City Council

**Energy Performance Rating (EPC):** Current Rating C

#### Additional Fees

**Administration Charge:** Purchasers will be required to pay an administration fee of 0.6% inc VAT, subject to a minimum of £1080 inc VAT

**Disbursements:** Please see legal pack for any disbursements that may become payable by the purchaser on completion.

[auctionhouse.co.uk](http://auctionhouse.co.uk)

[\\*Description on Auction Information Page](#)



**Tenure:** See legal pack  
**Local Authority:** Bolton Metropolitan Borough Council  
**Energy Performance Rating (EPC):** D

## Residential Investments

15

### 30 Mobberley Road, Bolton, Lancashire BL2 5AW

**\*GUIDE PRICE**

**£80,000 - £90,000 (plus fees)**

**A Semi Detached House Converted Into a 5 Bedroomed Multi Let Property Producing £16,640pa/£1,386pcm**

Occupying a pleasant outlook over the Crescent this semi detached house has been converted into a multi let property producing £16,640pa/£1,386pcm inclusive of all household bills and Council Tax. See legal pack regarding licensing. To the rear is a further Annex/Store that could be converted to provide additional, self contained lettable, accommodation. Briefly comprises, Hall, Five Letting Rooms, Kitchen, Bathroom and Separate WC. Benefits from gas central Heating with a new boiler installed approximately 2 years ago. There is a garden to the front and annex to the rear. The sale includes all furnishings and white goods

#### Description

**Ground Floor:** Room One currently Let at £70/week, Room Two currently Let at £60/week, Kitchen

**First Floor:** Landing, Room Three currently Let at £70/week, Room Four currently Let at £70/week, Room Five currently Let at £50/week Bathroom with 3 piece suite, Separate WC with whb.

**Outside:** There is a Garden to the front and an annex/store to the rear.

#### Additional Fees

**Administration Charge:** Purchasers will be required to pay an administration fee of 0.6% inc VAT, subject to a minimum of £1080 inc VAT

**Disbursements:** Please see legal pack for any disbursements that may become payable by the purchaser on completion.

[auctionhouse.co.uk](http://auctionhouse.co.uk)

[\\*Description on Auction Information Page](#)



**Tenure:** See legal pack  
**Local Authority:** Barnsley Council  
**Energy Performance Rating (EPC):** N/A

## Commercial

16

### Three Storage Pods, GB066, GB154 & GC013, Ashroyd Business Park, Barnsley, South Yorkshire S74 9SB

**\*GUIDE PRICE**

**NIL RESERVE (plus fees)**

**Two Vacant Storage Units Approximately 125sq ft/11.61sq m**

Two individual secure storage pods with benefits including Car Parking, CCTV and WiFi. Situated on a modern Business Park just off the Dearne Valley Parkway within approximately 1.5 miles of the M1 Motorway. Barnsley Town Centre is approximately 3.75 miles to the north and Sheffield City Centre is approximately 8.5 miles to the south. Perfect for using to declutter your house!

**Please note there is a further buyers premium of £1,200 inc VAT.**

#### Additional Fees

**Buyer's Premium:** Please note there is a further buyers premium of £1,200 inc VAT.

**Administration Charge:** Purchasers will be required to pay an administration fee of 0.6% inc VAT, subject to a minimum of £1080 inc VAT

**Disbursements:** Please see legal pack for any disbursements that may become payable by the purchaser on completion.

[auctionhouse.co.uk](http://auctionhouse.co.uk)

[\\*Description on Auction Information Page](#)



# EXTRA PROTECTION FOR LANDLORDS

**RYDER &  
DUTTON**

CHARTERED SURVEYORS  
VALUERS • ESTATE AGENTS

The Government have continued to make life more difficult for Landlords. There are now 170 pieces of legislation with which to comply. At Ryder & Dutton our Property Management team work tirelessly to ensure our Landlords are always compliant and within the law.

Now we are adding further protection for our Landlords with the **Ryder & Dutton Rent On Time Scheme**. This means that all our Fully Managed and Rent Collect clients will always receive their rent on the day it is due even if the Tenant hasn't paid. **No More Arrears Ever!**

Full legal protection to deal with Tenants that don't pay is also included. We are happy to explain the terms and conditions.



**CONTACT GARETH HUNT  
LETTINGS MANAGER  
FOR MORE DETAILS**

**0161 626 6800**

**[www.ryder-dutton.co.uk](http://www.ryder-dutton.co.uk)**

**[ghunt@ryder-dutton.co.uk](mailto:ghunt@ryder-dutton.co.uk)**

## Land

### Land Adjacent to the River Dane, King Street, Middlewich, Cheshire CW10 9LZ

**\*GUIDE PRICE**

**£5,000 - £10,000** (plus fees)

**A Parcel of Land Comprising Approximately 23sq yds/195sq m with River Frontage**

Situated on King Street at its junction with the B5309 the land, more particularly shown edged red on the plan, comprises approximately 23sq yds/195sq m. Enjoying a frontage to the River Dane and being prominently located at the King Street/B5309 junction the land is likely to be of interest to a variety of local users. Interested parties should make their own enquiries of the Local Authority to satisfy themselves that the proposed use of the land is acceptable prior to bidding.

#### Additional Fees

**Administration Charge:** Purchasers will be required to pay an administration fee of 0.6% inc VAT, subject to a minimum of £1080 inc VAT

**Disbursements:** Please see legal pack for any disbursements that may become payable by the purchaser on completion.

**Tenure:** See Legal Pack

**Local Authority:** Cheshire East Council

**Energy Performance Rating (EPC):** N/A

[auctionhouse.co.uk](http://auctionhouse.co.uk)

\*Description on Auction Information Page

## Residential Investments

### 8 Albany Close, Little Hulton, Manchester M38 9GE

**\*GUIDE PRICE**

**£100,000 - £120,000** (plus fees)

**A Semi Detached Property Converted into Four Studio Apartments Previously Producing £20,540pa/1,711pcm**

Occupying a cul-de-sac location and with good access to Manchester, Wigan and Bolton the property has been converted into Four Self Contained Studio Apartments. Additionally there is a, larger, communal Kitchen/Utility Room. The property is reaching completion of a partial refurbishment so 3 apartments are currently vacant. When fully tenanted it, previously, produced £20,540pa/£1,711pcm inclusive of all household bills and Council Tax. Please note there is currently only one Council Tax bill being received so each apartment may have to be separately assessed. The sale includes all furnishings and white goods.

#### Description

**Ground Floor:** Porch, Hall, Apartment One currently Vacant, previously, Let at £90/week comprising Bedsitting Room, Kitchenette, Shower, WC & whb. Apartment Two currently Vacant, previously, Let at £110/week comprising Bedsitting Room, Kitchenette, Shower, WC & whb. Communal Kitchen.

**First Floor:** Landing, Apartment Three currently Let at £100/week comprising Bedsitting Room, Kitchenette, Separate Shower Room, WC & whb. Apartment Four currently Vacant, previously, Let at £95/week comprising Bedsitting Room, Kitchenette, Separate Bathroom, WC & whb.

**Outside:** There is a garden to the front and rear.

#### Additional Fees

**Administration Charge:** Purchasers will be required to pay an administration fee of 0.6% inc VAT, subject to a minimum of £1080 inc VAT

**Disbursements:** Please see legal pack for any disbursements that may become payable by the purchaser on completion.

**Tenure:** See Legal Pack

**Local Authority:** Salford City Council

**Energy Performance Rating (EPC):** Current Rating E

[auctionhouse.co.uk](http://auctionhouse.co.uk)

\*Description on Auction Information Page



19

## Ground Rents

Several Freehold Ground Rents, and Land Lying to the South of Church Street, Whitworth, Lancashire OL12 8QG

**\*GUIDE PRICE**  
**£500 +** (plus fees)

### Several Freehold Ground Rents Plus Land

A small parcel of land lying to the South of Church Street plus several Freehold Ground Rents. This land/investment opportunity will certainly appeal to the local residents.

**Please not there will be a further Buyers Premium of £900 inclusive of VAT.**

**Tenure:** See Legal Pack  
**Local Authority:** Lancashire County Council  
**Energy Performance Rating (EPC):** N/A

**Additional Fees**  
**Buyer's Premium:** Please not there will be a further Buyers Premium of £900 inclusive of VAT.  
**Administration Charge:** Purchasers will be required to pay an administration fee of 0.6% inc VAT, subject to a minimum of £1080 inc VAT  
**Disbursements:** Please see legal pack for any disbursements that may become payable by the purchaser on completion.



20

## Amenity Land

Land off Green Lane, Hollingworth, Hyde SK14 8JQ

**\*GUIDE PRICE**  
**£70,000 - £90,000** (plus fees)

### Approximately 5 Acres/2.023 Hectares Grazing/Amenity Land

An opportunity to acquire a parcel of Greenbelt amenity/grazing land, more particularly shown edged red on the attached plan, comprising approximately 5 Acres/2.023 Hectares. Situated off Green Lane and accessed via Thorncliffe Vale and Spring Street. This would make ideal grazing land for someone living locally.



**Tenure:** See legal pack  
**Local Authority:** Tameside Council  
**Energy Performance Rating (EPC):** N/A

**Additional Fees**  
**Administration Charge:** Purchasers will be required to pay an administration fee of 0.6% inc VAT, subject to a minimum of £1080 inc VAT  
**Disbursements:** Please see legal pack for any disbursements that may become payable by the purchaser on completion.





**Tenure:** See legal pack

**Local Authority:** Rochdale Council

**Energy Performance Rating (EPC):** Current Rating TBC

## Residential for Improvement

21

**524 Bury Road, Bamford, Rochdale, Lancashire OL11 4DQ**

**\*GUIDE PRICE**

**£100,000 - £120,000 (plus fees)**

### A Three Bedroom End Terraced House

Offering extensive accommodation over three floors this garden fronted property is situated in Rochdale's premier district of Bamford. Now requiring modernisation and repair, some of which may be structural, the property offers a superb opportunity to create a stunning family home. Briefly comprises, Vestibule, Lounge, Dining Room, Kitchen, Conservatory, Three Bedrooms and Bathroom. There are gardens to the front and rear. This is an amazing opportunity to acquire a very attractively Guided property in this sought after area and is perfect for the Builder/Investor looking for a project where they can add considerable value. Please note there may be some contents remaining in the property on completion.

### Description

**Ground Floor:** Entrance Vestibule, Lounge, Dining Room, Kitchen, Conservatory

**First Floor:** Landing, Bedroom One, Bedroom Two, Bathroom

**Second Floor:** Bedroom Three

**Outside:** There are gardens to the front and rear

### Additional Fees

**Administration Charge:** Purchasers will be required to pay an administration fee of 0.6% inc VAT, subject to a minimum of £1080 inc VAT

**Disbursements:** Please see legal pack for any disbursements that may become payable by the purchaser on completion.

[auctionhouse.co.uk](http://auctionhouse.co.uk)

[\\*Description on Auction Information Page](#)



**Tenure:** See legal pack

**Local Authority:** Lancashire County Council & Hyndburn Borough Council

**Energy Performance Rating (EPC):** Current Rating D

## Residential

22

**10 Bright Street, Oswaldtwistle, Accrington, Lancashire BB5 3LD**

**\*GUIDE PRICE**

**£45,000 - £55,000 (plus fees)**

### A Two Bedroomed Plus Room Mid Terraced House

This stone fronted property offers spacious accommodation within easy reach of a range of amenities being very close to Oswaldtwistle Mills and only a short drive from Accrington Town Centre. Briefly comprises, Vestibule, Lounge, Dining Room, Kitchen, Two Bedrooms, Bathroom and Attic Room. Benefits from Gas Central Heating and Double Glazing. To the rear is an enclosed yard. Perfect starter home or for the Buy to Let investor.

### Description

**Ground Floor:** Entrance Vestibule, Lounge, Dining Room, Kitchen

**First Floor:** Landing, Bedroom One, Bedroom Two, Bathroom

**Second Floor:** Attic Room

**Outside:** To the rear is an enclosed yard.

### Additional Fees

**Administration Charge:** Purchasers will be required to pay an administration fee of 0.6% inc VAT, subject to a minimum of £1080 inc VAT

**Disbursements:** Please see legal pack for any disbursements that may become payable by the purchaser on completion.

[auctionhouse.co.uk](http://auctionhouse.co.uk)

[\\*Description on Auction Information Page](#)



Fast

# remortgages available

for your **home** or  
**buy-to-let** mortgages

Are you looking to review the mortgage on your property, or replace costly bridging finance, or perhaps you need to raise funds to finance the purchase of another property investment?

- Access to **12,000 products** from **90+ lenders** across the UK.
- Expert advice from friendly advisers.
- A full range of lifestyle and income protection cover to protect you from the unexpected.
- Covering all aspects of property-related lending including:  
First Time buying, Homemovers, Buy-to-Let, Help to Buy, Affordable Housing schemes and many more.

Contact your expert adviser today

**0161 655 6633**

Award-winning mortgage broker



**Mortgage  
Advice Bureau**

There is no guarantee that it will be possible to arrange continuous letting of the property, nor that rental income will be sufficient to meet the cost of the mortgage.

Your property may be repossessed if you do not keep up repayments on your mortgage.

There will be a fee for mortgage advice. The actual amount you pay will depend upon your circumstances. The fee is up to 1% but a typical fee is 0.3% of the amount borrowed.



**Tenure:** See Legal Pack  
**Local Authority:** Lancashire County Council  
**Energy Performance Rating (EPC):** Current Rating E

23

## Residential

### 100 Burnley Road, Accrington, Lancashire BB5 6DW

**\*GUIDE PRICE**

**£40,000 - £50,000 (plus fees)**

#### A Stylish Two Bedroomed Mid Terraced Property

An ideal purchase for the first time buyer or buy to let investor!! Smartly presented accommodation comprising entrance hall, lounge, kitchen/diner, utility room, two bedrooms and a bathroom with the benefit of PVCu double glazing and gas central heating. Conveniently located for Accrington Town Centre and its range of shops and amenities. Internal viewing is highly recommended.

**Please Note there will be a further Buyers Premium of £900 including VAT.**

#### Description

**Ground Floor:** Entrance Vestibule, Lounge, Kitchen/Diner, Utility Room

**First Floor:** Landing, Bedroom One, Bedroom Two, Bathroom

**Outside:** There is a generous yard to the rear of the property.

#### Additional Fees

**Buyer's Premium:** Please Note there will be a further Buyers Premium of £900 including VAT.

**Administration Charge:** Purchasers will be required to pay an administration fee of 0.6% inc VAT, subject to a minimum of £1080 inc VAT

**Disbursements:** Please see legal pack for any disbursements that may become payable by the purchaser on completion.

[auctionhouse.co.uk](http://auctionhouse.co.uk)

[\\*Description on Auction Information Page](#)



**Tenure:** See legal pack  
**Local Authority:** Manchester City Council  
**Energy Performance Rating (EPC):** Current Rating D

24

## Residential

### 44 Mayford Road, Levenshulme, Manchester M19 3AS

**\*GUIDE PRICE**

**£145,000 + (plus fees)**

#### A Spacious Two Bedroomed Mid Terraced Property

Situated in a popular residential area, close to local amenities, approximately 3 miles to Manchester City Centre and within walking distance to the railway station. Briefly comprising entrance hall, lounge, dining room, kitchen, two bedrooms and a bathroom with the benefit of PVCu double glazing and gas central heating throughout. Externally there is a forecourt to the front and a courtyard to the rear. Please note there may be some contents remaining inside and outside the property upon completion.

#### Description

**Ground Floor:** Entrance Hallway, Lounge, Dining Room, Kitchen

**First Floor:** Landing, Bedroom One, Bedroom Two, Bathroom

**Outside:** There is a forecourt to the front and a yard to the rear of the property.

#### Additional Fees

**Administration Charge:** Purchasers will be required to pay an administration fee of 0.6% inc VAT, subject to a minimum of £1080 inc VAT

**Disbursements:** Please see legal pack for any disbursements that may become payable by the purchaser on completion.

[auctionhouse.co.uk](http://auctionhouse.co.uk)

[\\*Description on Auction Information Page](#)





**Tenure:** See Legal Pack  
**Local Authority:** Warrington Borough Council  
**Energy Performance Rating (EPC):** Current Rating D

25

## Residential

### 8 Matlock Close, Great Sankey, Warrington, Cheshire WA5 3QZ

**\*GUIDE PRICE**

**£100,000 - £120,000 (plus fees)**

#### A Vacant Well Presented Two Bedroomed Semi Detached Property

This property will certainly appeal to first time buyers and buy to let landlords, making this an ideal family home. Situated close to local motorway network and amenities. Briefly comprising lounge, open plan kitchen, two bedrooms and a bathroom with the benefit of gas central heating and PVCu double glazing throughout. Externally there is a driveway to the front and a decked private enclosed garden to the rear plus a detached utility/store room. Must be viewed to appreciate the high standard of internal and external condition of the property. Please note there may be some contents remaining in the property upon completion.

#### Description

**Ground Floor:** Open Plan Lounge/Kitchen

**First Floor:** Landing, Bedroom One, Bedroom Two, Bathroom

**Outside:** There is a garden including a driveway to the front with a decked garden, including a utility/store room to the rear.

#### Additional Fees

**Administration Charge:** Purchasers will be required to pay an administration fee of 0.6% inc VAT, subject to a minimum of £1080 inc VAT

**Disbursements:** Please see legal pack for any disbursements that may become payable by the purchaser on completion.

[auctionhouse.co.uk](http://auctionhouse.co.uk)

[\\*Description on Auction Information Page](#)

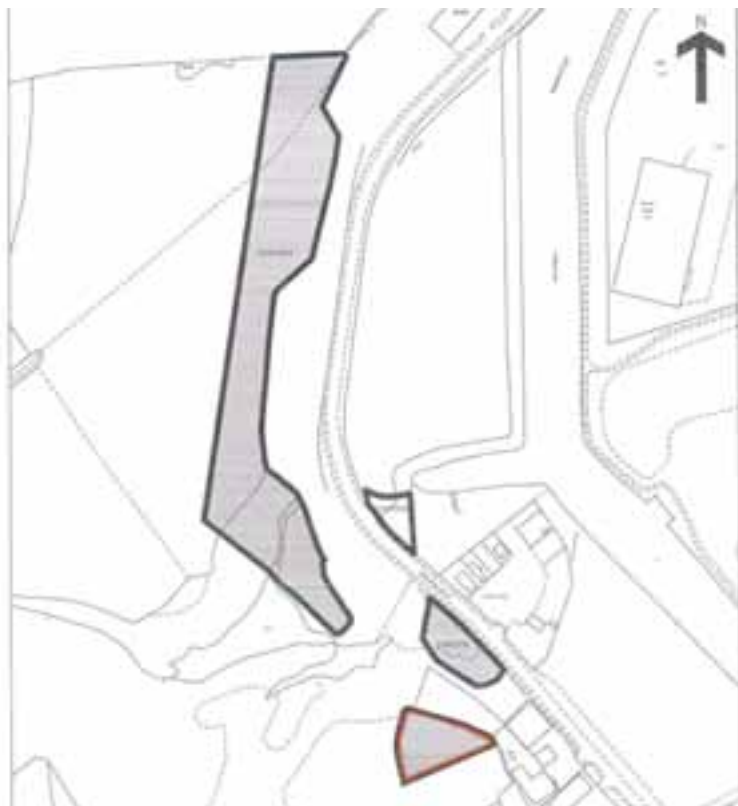

**Tenure:** See Legal Pack  
**Local Authority:** Cheshire West and Chester Council  
**Energy Performance Rating (EPC):** N/A

26

## Land

### Land to the West of Bradford Road, Winsford, Cheshire CW7 2NX

**\*GUIDE PRICE**

**£3,000 - £5,000 (plus fees)**

#### A Parcel of Land Comprising Approximately 0.4 Acres/0.16 Hectares

The land, more particularly shown edged red on the attached plan, comprises approximately 0.4 Acres/0.16 Hectares. For identification purposes only it is situated to the rear of Electra Fence Security Ltd CW7 2NX. Interested parties should make their own enquiries of the Local Authority to satisfy themselves that their proposed use of the land is acceptable prior to bidding.

**Please note there is a further Buyers Premium of £1,500 inc VAT payable on this Lot.**

#### Additional Fees

**Buyers Premium:** Please note there is a further Buyers Premium of £1,500 inc VAT payable on this lot

**Administration Charge:** Purchasers will be required to pay an administration fee of 0.6% inc VAT, subject to a minimum of £1080 inc VAT

**Disbursements:** Please see legal pack for any disbursements that may become payable by the purchaser on completion.

[auctionhouse.co.uk](http://auctionhouse.co.uk)

[\\*Description on Auction Information Page](#)



**Tenure:** See Legal Pack  
**Local Authority:** Oldham Council  
**Energy Performance Rating (EPC):** Current Rating E

27

## Residential

### 696 Huddersfield Road, Oldham, Lancashire OL4 3PZ

**\*GUIDE PRICE**

**£140,000 + (plus fees)**

#### A Large Three Bedroomed Semi Detached Property Over Four Floors

A perfect home for the growing family!! In brief the accommodation comprises to the lower ground floor, utility room, wc, large storage area and a sitting room. The ground floor comprises entrance hall, lounge/dining room and a breakfast kitchen and to the first floor there are three bedrooms and shower room/wc. The property has the benefit of gas central heating and double glazing. Viewing is a must to appreciate the size of property on offer!!! Please note there may be some contents remaining in the property upon completion.

#### Description

**Lower Ground Floor:** Storage Room, Sitting Room, Utility Room, WC

**Ground Floor:** Lounge/Dining Room, Breakfast Kitchen

**First Floor:** Landing, Bedroom One with en-suite, Bedroom Two, Shower Room

**Second Floor:** Bedroom Three, Shower Room

**Outside:** There is a garden to the rear of the property.

#### Additional Fees

**Administration Charge:** Purchasers will be required to pay an administration fee of 0.6% inc VAT, subject to a minimum of £1080 inc VAT

**Disbursements:** Please see legal pack for any disbursements that may become payable by the purchaser on completion.

[auctionhouse.co.uk](http://auctionhouse.co.uk)

[\\*Description on Auction Information Page](#)



**Tenure:** See Legal Pack  
**Local Authority:** Bury Metropolitan Borough Council  
**Energy Performance Rating (EPC):** Current Rating E

28

## Residential

### 86 Baguley Crescent, Middleton, Manchester M24 4GU

**\*GUIDE PRICE**

**£25,000 - £35,000 (plus fees)**

#### A One Bedroomed Ground Floor Apartment

Situated in a highly convenient location close to the M60/M62/M66 and just approximately 5 miles north of Manchester city centre. This property should have an obvious appeal to the investor and offers accommodation comprising of lounge, kitchen, bedroom and bathroom/wc with the benefit of gas central heating. There is also an excellent range of local amenities. Please note there may be some contents remaining in the property upon completion.

#### Description

**Ground Floor:** Communal Entrance, Entrance, Lounge, Kitchen, Bedroom, Bathroom

**Outside:** There are communal Gardens.

#### Additional Fees

**Administration Charge:** Purchasers will be required to pay an administration fee of 0.6% inc VAT, subject to a minimum of £1080 inc VAT

**Disbursements:** Please see legal pack for any disbursements that may become payable by the purchaser on completion.

[auctionhouse.co.uk](http://auctionhouse.co.uk)

[\\*Description on Auction Information Page](#)



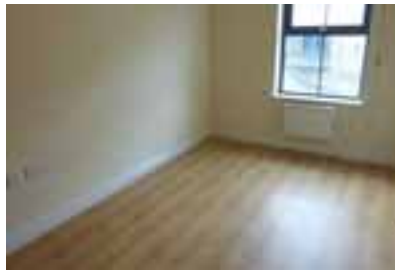

**Tenure:** See legal pack

**Local Authority:** Calderdale Council

**Energy Performance Rating (EPC):** Current Rating TBC

## Residential

29

### Apt 13 The Abode, Sunderland Street, Halifax, West Yorkshire HX1 5AF

**\*GUIDE PRICE**

**£20,000 - £30,000 (plus fees)**

#### A Two Bedroomed Second Floor Apartment

Located in the centre of Halifax providing easy access to local amenities and public transport links. Having electric heating and double glazing. The property briefly comprising entrance hall, open lounge/kitchen, two bedrooms (master en-suite) and bathroom.

**Please note there is a Further Buyers Premium of £600 inc VAT payable on this lot.**

#### Description

**Ground Floor:** Communal Entrance

**Second Floor:** Entrance Hall, Lounge/Kitchen, Bedroom One with En-suite, Bedroom Two, Bathroom

#### Additional Fees

**Buyer's Premium:** Please note there is a Further Buyers Premium of £600 inc VAT payable on this lot.

**Administration Charge:** Purchasers will be required to pay an administration fee of 0.6% inc VAT, subject to a minimum of £1080 inc VAT

**Disbursements:** Please see legal pack for any disbursements that may become payable by the purchaser on completion.

[auctionhouse.co.uk](http://auctionhouse.co.uk)

[\\*Description on Auction Information Page](#)



## Residential

30

### 2 The Stables, Frederick Street, Coppice, Oldham, Lancashire OL8 4DA

**\*GUIDE PRICE**

**£100,000 - £120,000 (plus fees)**

#### A Three Bedroomed Town House

Situated in the ever popular Coppice area this character property offers good sized living accommodation with excellent access to local amenities and good transport links to Oldham and Manchester. Briefly comprises, Hall, Lounge, Kitchen/Diner, WC, Three Bedrooms, Bathroom and Integral Garage. There is a driveway to the front and two allocated parking spaces. Perfect for the Owner Occupier and Buy to Let Landlord and especially attractive having the benefit of the designated parking and the potential to convert the garage into additional living accommodation subject to any necessary planning consent. Please note there may be some contents remaining in the property upon completion.

#### Description

**Ground Floor:** Entrance Hall, Kitchen/Diner, Garage, WC

**First Floor:** Landing, Lounge, Bedroom One, Bedroom Two, Bedroom Three, Bathroom

**Outside:** To the front is a driveway and two allocated car parking spaces.

#### Additional Fees

**Administration Charge:** Purchasers will be required to pay an administration fee of 0.6% inc VAT, subject to a minimum of £1080 inc VAT

**Disbursements:** Please see legal pack for any disbursements that may become payable by the purchaser on completion.

**Tenure:** See legal pack

**Local Authority:** Oldham Council

**Energy Performance Rating (EPC):** Current Rating D

[auctionhouse.co.uk](http://auctionhouse.co.uk)

[\\*Description on Auction Information Page](#)



We're the ones  
giving you an  
interest rate of  
0.49%\*. Interested?

Lending for the  
new normal.

**together.**<sup>®</sup>

Have you considered finance to purchase your auction property? With rates from 0.49%\* our flexible approach to lending will get you going, going, gone in no time.

Call us on 0372 291 2605 or find out more at [togethermoney.co.uk/auction-finance](https://togethermoney.co.uk/auction-finance)

\*Other fees and charges apply and are variable based on the loan amount. 0.49% pm is applicable for the duration of the loan. 12 months as standard. No exit fee applies. Standard construction only. Any property used as security may be repossessed if you do not keep up the repayments.



**Tenure:** See Legal Pack  
**Local Authority:** Salford City Council  
**Energy Performance Rating (EPC):** Current Rating G

31

## Residential Investments

**Apt.12 The Gateway, 11-21 Broughton Road, Salford, Manchester M6 6LS**

**\*GUIDE PRICE**

**£35,000 - £45,000 (plus fees)**

**A Tenanted One Bedroomed Mid Floor Apartment producing an income of £6,000pa (£500pcm)**

This apartment is located in a popular development and close to local amenities, transport links and Manchester City Centre. Whilst we have not had sight yet of any documentation we have been advised that the property is occupied under an Assured Shorthold Tenancy producing £6,000pa (£500pcm). Whilst we have not inspected the apartment we believe it comprises entrance hall, open plan living/kitchen area, one bedroom and a bathroom.

### Description

**Ground Floor:** Communal Entrance with Stairs and Lift

**Mid Floor:** Entrance Hall, Lounge/Kitchen, Bedroom, Bathroom

### Additional Fees

**Administration Charge:** Purchasers will be required to pay an administration fee of 0.6% inc VAT, subject to a minimum of £1080 inc VAT

**Disbursements:** Please see legal pack for any disbursements that may become payable by the purchaser on completion.

[auctionhouse.co.uk](http://auctionhouse.co.uk)

[\\*Description on Auction Information Page](#)



**Tenure:** See Legal Pack  
**Local Authority:** Salford City Council  
**Energy Performance Rating (EPC):** Current Rating G

32

## Residential Investments

**Apt 33 The Gateway, 11-21 Broughton Road, Salford, Manchester M6 6LS**

**\*GUIDE PRICE**

**£45,000 - £55,000 (plus fees)**

**A Tenanted Two Bedroomed Mid Floor Apartment producing an income of £7,800pa (£650pcm)**

This apartment is located in a popular development and close to local amenities, transport links and Manchester City Centre. Whilst we have not had sight of any documentation we have been advised that the property is occupied under an Assured Shorthold Tenancy producing £7,800pa (£650pcm). Whilst we have not inspected the apartment we believe it comprises entrance hall, open plan living/kitchen area, two bedrooms and a bathroom.

### Description

**Ground Floor:** Communal Entrance with Stairs and Lift

**Mid Floor:** Entrance Hall, Lounge/Kitchen, Two Bedrooms, Bathroom

### Additional Fees

**Administration Charge:** Purchasers will be required to pay an administration fee of 0.6% inc VAT, subject to a minimum of £1080 inc VAT

**Disbursements:** Please see legal pack for any disbursements that may become payable by the purchaser on completion.

[auctionhouse.co.uk](http://auctionhouse.co.uk)

[\\*Description on Auction Information Page](#)

## Residential

## 217 Rochdale Road, High Crompton, Shaw, Lancashire OL2

\*GUIDE PRICE

**£150,000 - £175,000** (plus fees)**A Substantial Three Bedroomed Detached True Bungalow with Garage**

An amazing opportunity to purchase a property situated within the highly sought after area of High Crompton, occupying a large plot with huge potential!!! Briefly comprising entrance hall, w.c, lounge/dining area, kitchen, three bedrooms, bathroom and rear porch with the benefit of good sized gardens, garage and driveway with off road parking. The property requires renovation and refurbishment throughout therefore potential purchasers have the opportunity to reconfigure and also extend, subject to the necessary planning consents. Please note there may be some contents remaining in the property upon completion.

**Description**

**Ground Floor:** Entrance Hallway, W.C, Lounge/Dining Area, Rear Porch, Kitchen Area, Bedroom One, Bedroom Two, Bedroom Three, Bathroom

**Outside:** There are good sized gardens to the front and rear including a garage/ driveway with off road parking.

**Additional Fees**

**Administration Charge:** Purchasers will be required to pay an administration fee of 0.6% inc VAT, subject to a minimum of £1080 inc VAT

**Disbursements:** Please see legal pack for any disbursements that may become payable by the purchaser on completion.



**Tenure:** See legal pack

**Local Authority:** Oldham Council

**Energy Performance Rating (EPC):** Current Rating TBC

[auctionhouse.co.uk](http://auctionhouse.co.uk)

\*Description on Auction Information Page

# Property Types for Auction

There are many different types of property that sell well at Auction, and if you have one that falls into any of these categories you certainly should consider the Auction route. Check through the list below, and if you find a match, then give Auction House a call.



Properties for Improvement



Tenanted Properties



Residential Investments



Development Propositions



Building Land



Mixed Use Properties



Commercial Investments



Unique Properties



Amenity Land and Other Property

**0161 925 3254**  
[manchester@auctionhouse.co.uk](mailto:manchester@auctionhouse.co.uk)



# DO YOU OWN A PIECE OF LAND THAT YOU THINK IS WORTHLESS?

## **EVEN WORSE IT'S A FLY TIPPING NIGHTMARE?**

### PERHAPS IT'S TIME TO THINK AGAIN



**Land Off Kent Street,  
Oldham**

148sq yds/123sq m

**GUIDE PRICE: NIL RESERVE**

**SOLD PRICE: £21,000**



**Woodland, Harefield Drive,  
Heywood**

0.4 acres/0.16 hectares

**GUIDE PRICE: NIL RESERVE**

**SOLD PRICE: £2,000**



**Land At Estate Street,  
Oldham**

350sq yds/293sq m

**GUIDE PRICE: £5,000 plus**

**SOLD PRICE: £46,000**



**The Paddock, Harefield  
Drive, Heywood**

0.75 acres/0.3 hectares

Numerous Failed Planning Applications

**GUIDE PRICE:**

**£5,000-£10,000**

**SOLD PRICE: £19,250**



**Land Off Netherhey Street,  
Oldham**

0.4 acres/0.16 hectares

Landlocked

**GUIDE PRICE:**

**£20,000-£30,000**

**SOLD PRICE: £76,000**

**CONTACT US TO ARRANGE A FREE NO  
OBLIGATION AUCTION APPRAISAL**

Call: 0161 925 3254

Email: [manchester@auctionhouse.co.uk](mailto:manchester@auctionhouse.co.uk)

Visit: [www.auctionhouse.co.uk/manchester](http://www.auctionhouse.co.uk/manchester)

**AUCTION  
HOUSE**  
MANCHESTER

# MEMORANDUM OF SALE



Property Address:

Lot No.

Price:

The Vendor:

The Purchaser:

Post Code:

Tel:

It is agreed that the Vendor sells and the Purchaser buys the property described in the accompanying particulars and \*conditions of sale subject to their provisions and the terms and stipulations in them at the price above mentioned.

Purchase Price:

£

Less Deposit:

£

Balance:

£

Dated:

Completion Date:

**AS PER SPECIAL CONDITIONS OF SALE OR 20 BUSINESS DAYS  
AFTER THE CONTRACT DATE**

Signed:

Authorised Agent for Vendor

As Agents for the Vendor we acknowledge receipt of the deposit in the form

of:

Dated:

Signed:

The Purchaser

Purchasers Solicitor:

Post Code:

Tel:

Vendors Solicitor:

Post Code:

Tel:

\* For the purpose of this contract, the conditions of sale include the three sections of the RICS Common Auction Conditions, the Glossary, Conduct of the Auction and the General Conditions.

In addition and at the same time, the purchaser is required to pay by cheque to the Auctioneer an Administration Charge of 0.6% inc VAT of the purchase price subject to a minimum of £1080.00 inc VAT plus Buyers Premium if applicable. Auction Administration Charge may be higher, as detailed in the catalogue lot description.

# NON-ATTENDING BID OR TELEPHONE BID

Please also sign and return the reverse side of this form



## AUTHORISATION FOR BIDDING BY PROXY OR TELEPHONE

Proxy

☐

Telephone

☐

Full Name (s):

Name of Company (if applicable):

Home or Company (address):  Postcode:

Tel:  Mobile:

Email:

Hereby authorise Auction House to bid on my behalf by proxy / telephone (delete as applicable) bid for the property detailed below.

I confirm that I have read and understood the General Conditions of Sale and signed the Conditions of Bidding by Proxy or Telephone set out overleaf.

## PROPERTY AND BID DETAILS

Lot No.:  Property Address:

My maximum bid (proxy bids only) will be: £

(amount in words):

## DEPOSIT (tick as applicable)

☐

I attach a cheque for 10% of my proxy bid or £5000, whichever is the greater, plus 0.6% inc VAT/£1,080 (£900 +VAT) minimum (Administration Charge) and any buyers premium payable as per any description in the catalogue or legal pack.

OR

☐

I attach a blank cheque to be completed by the Auctioneer if my bid is successful, within which he will include 0.6% inc VAT/£1,080 (£900 +VAT) minimum (Administration Charge) and any buyers premium payable as per any description in the catalogue or legal pack.

My cheque of £  payable to AUCTION HOUSE MANCHESTER (amount if applicable)

I hereby authorise Auction House to undertake Proof of Identification checks using the information provided.

Date of Birth  Period living at current address  NI Number

Passport Number

Driving Licence Number

Previous address if less than 6 months

## SOLICITORS

My solicitors are:

Of (address):

Postcode:

Tel:  Person Acting:

If my bid is successful, I authorise the Auctioneer to sign the Memorandum of Sale on my behalf and recognise that I will be the legally bound purchaser of the property referred to above and must complete the purchase of the property within the time specified in the General/Special Conditions of Sale.

Signed:  Date:

**PLEASE MARK THE ENVELOPE EITHER PROXY OR TELEPHONE BID**



## TERMS AND CONDITIONS FOR TELEPHONE BIDS AND BIDDING BY LETTER

Anyone not able to attend the auction and wishing to make a bid for any property,  
do so on the following terms and conditions:

1. The bidder must complete a separate authority form for each Lot involved, and provide a bankers draft, solicitor's client's account cheque or personal cheque for 10% of the maximum amount of the bid for each Lot. Please note the minimum deposit for any bid is £5,000 PER LOT.
2. The bidder must upload Proof of Identity in the form of a scan of a driving licence or passport, and a scan of a utility bill to the Auctions Passport Service that accesses the property's Legal Pack. Also you authorise Auction House to undertake a search with Experian for the purpose of verifying your identity. To do so Experian may check the details you supply against any particulars on any database (public or otherwise) to which they have access. They may also use your details in the future to assist other companies for verification purposes. A record of the search will be retained.
3. The form must be sent to, or delivered to: Written & Telephone Bids, Auction House Manchester, Edge View House, Salmon Fields Business Village, Royton OL2 6HT to arrive before 4pm one working day prior to the auction date. It is the bidders responsibility to check that the form is received by Auction House and this can be done by telephoning the office.
4. In the case of a telephone bid the prospective purchaser should provide a blank cheque in the name of the purchaser which the Auctioneer will complete on behalf of the prospective purchaser if the prospective purchaser is successful in purchasing the relevant property for 10% of the purchase price, plus the administration charge or in accordance with the General or Special Conditions of Sale relating to the lot.
5. The bidder shall be deemed to have read the "Important Notice to be read by all bidders"; the particulars of the relevant Lot in the catalogue the general and special conditions of sale. The bidder shall be deemed to have taken all necessary professional and legal advice and to have made enquiries and have knowledge of any announcements to be made from the rostrum of any amendments relating to the relevant Lot. Announcements can and should be checked by bidders on the day before the auction. However, the Auctioneers will advise the bidders of any announcements as soon as possible prior to the Auction.
6. In the case of a written bid, Auction House staff will compete in the bidding up to the maximum of the authorisation. If no maximum is inserted, Auction House reserve the right not to bid.
7. Auction House reserve the right not to bid on behalf of written bidders, in the event of any error, doubt, omission, uncertainty as to the bid, any failure to validate Proof of Identification, or for any reason whatsoever and give no warranty, or guarantee, that a bid would be made on behalf of the bidder and accept no liability.
8. In the event that the written or telephone bid is successful, the Auctioneer will sign the Memorandum of the Contract on behalf of the bidder (a Contract would have been formed on the fall of the hammer).
9. In the event of a Contract, the deposit monies will be applied so far as necessary to meet the requirement for a 10% deposit (minimum £5,000) and the balance of the deposit (if any) will be held by the vendors solicitor pending completion. An Administration charge of 0.6% inc VAT/£1,080 (£900 +VAT) minimum and any additional buyers premium payable as per any description in the catalogue or legal pack should be added to the deposit cheque or a separate cheque should be made payable to Auction House Manchester.
10. In the event that the bidder is unsuccessful in gaining the Contract, the deposit monies shall be returned to the bidder promptly.
11. The Auctioneer will make no charge to a prospective purchaser for this service and will accept no liability whatsoever for any bid not being made on behalf of the prospective purchaser whether through lack of clarity of instructions or for any other reason whatsoever. Prospective telephone purchasers will not hold Auction House liable for any loss or claims relating to the telephone bidding system. The prospective purchaser will be advised if the relevant lot has been successfully purchased on his behalf as soon as possible after the auction. Where the lot has not been purchased the prospective purchaser will be notified by post and the deposit returned as soon as reasonably possible.
12. Once delivered to the Auctioneers, the authority to bid is binding on the bidder on the day on which the particular Lot is auctioned. This is to allow for the possibility of a Vendor agreeing to sell post auction where the bidding has not reached the reserve.
13. The authority can only be withdrawn by notification in writing delivered to Auction House at their office two hours before the start of the auction on the day the relevant Lot is scheduled to be auctioned, or by delivery into the hands of the Auctioneer in the auction room half-an-hour before the start of that day's auction. It is the bidders responsibility to obtain a receipt on a copy of the withdrawal notification signed by one of the Auctioneers and without such a receipt the authority stands, any successful Contract is binding on the bidder.
14. If the bidder, or an agent, actually bids at the auction without having previously withdrawn the authority, the Auctioneer is at liberty to accept such bid in addition to any bid from Auction House staff as empowered under the written authority. Auction House will have no liability whatsoever if the price achieved is the result only of this competition in bidding without intervention from other bidders.
15. Prospective purchasers are advised in respect of telephone bids should they become disconnected during bidding or are unobtainable, Auction House will not be held responsible or liable for any loss suffered in respect thereof. I hereby confirm that I have read and understood the above terms and conditions to bid by letter.

Signed: ..... Date: .....

Please sign this page and ensure the form overleaf is completed

# COMMON AUCTION CONDITIONS (EDITION 3)

REPRODUCED WITH THE CONSENT OF THE RICS

## INTRODUCTION

The Common Auction Conditions have been produced for real estate auctions in England and Wales to set a common standard across the industry. They are in three sections:

### GLOSSARY

The glossary gives special meanings to certain words used in both sets of conditions..

### AUCTION CONDUCT CONDITIONS

The Auction Conduct Conditions govern the relationship between the auctioneer and anyone who has a catalogue, or who attends or bids at the auction. They cannot be changed without the auctioneer's agreement.

### SALE CONDITIONS

The Sale Conditions govern the agreement between each seller and buyer. They include general conditions of sale and template forms of special conditions of sale, tenancy and arrears schedules and a sale memorandum.

### IMPORTANT NOTICE

A prudent buyer will, before bidding for a lot at an auction:

- take professional advice from a conveyancer and, in appropriate cases, a chartered surveyor and an accountant;
- read the conditions;
- inspect the lot;
- carry out usual searches and make usual enquiries;
- check the content of all available leases and other documents relating to the lot;
- check that what is said about the lot in the catalogue is accurate;
- have finance available for the deposit and purchase price;
- check whether VAT registration and election is advisable;

The conditions assume that the buyer has acted like a prudent buyer.

If you choose to buy a lot without taking these normal precautions you do so at your own risk.

## GLOSSARY

This glossary applies to the auction conduct conditions and the sale conditions.

Wherever it makes sense:

- singular words can be read as plurals, and plurals as singular words;
- a "person" includes a corporate body;
- words of one gender include the other genders;
- references to legislation are to that legislation as it may have been modified or re-enacted by the date of the auction or the contract date (as applicable); and
- where the following words are printed in bold type they have the specified meanings.

### Actual completion date

The date when completion takes place or is treated as taking place for the purposes of apportionment and calculating interest.

### Addendum

An amendment or addition to the conditions or to the particulars or to both whether contained in a supplement to the catalogue, a written notice from the auctioneers or an oral announcement at the auction.

### Agreed completion date

Subject to condition G9.3:

- (a) the date specified in the special conditions; or
  - (b) if no date is specified, 20 business days after the contract date;
- but if that date is not a business day the first subsequent business day.

### Approved financial institution

Any bank or building society that has signed up to the Banking Code or Business Banking Code or is otherwise acceptable to the auctioneers.

### Arrears

Arrears of rent and other sums due under the tenancies and still outstanding on the actual completion date.

### Arrears schedule

The arrears schedule (if any) forming part of the special conditions.

### Auction

The auction advertised in the catalogue.

### Auction conduct conditions

The conditions so headed, including any extra auction conduct conditions.

### Auctioneers

The auctioneers at the auction.

### Business day

Any day except (a) a Saturday or a Sunday; (b) a bank holiday in England and Wales; or (c) Good Friday or Christmas Day.

### Buyer

The person who agrees to buy the lot or, if applicable, that person's personal representatives: if two or more are jointly the buyer their obligations can be enforced against them jointly or against each of them separately.

### Catalogue

The catalogue to which the conditions refer including any supplement to it.

### Completion

Unless otherwise agreed between seller and buyer (or their conveyancers) the occasion when both seller and buyer have complied with their obligations under the contract and the balance of the price is unconditionally received in the seller's conveyancer's client account.

### Condition

One of the auction conduct conditions or sales conditions.

### Contract

The contract by which the seller agrees to sell and the buyer agrees to buy the lot.

### Contract date

The date of the auction or, if the lot is not sold at the auction:

- (a) the date of the sale memorandum signed by both the seller and buyer; or
- (b) if contracts are exchanged, the date of exchange. If exchange is not effected in person or by an irrevocable agreement to exchange made by telephone, fax or electronic mail the date of exchange is the date on which both parts have been signed and posted or otherwise placed beyond normal retrieval.

### Documents

Documents of title (including, if title is registered, the entries on the register and the title plan) and other documents listed or referred to in the special conditions relating to the lot.

### Financial charge

A charge to secure a loan or other financial indebtedness (not including a rentcharge).

### General conditions

That part of the sale conditions so headed, including any extra general conditions.

### Interest rate

If not specified in the special conditions, 4% above the base rate from time to time of Barclays Bank plc. (The interest rate will also apply to judgment debts, if applicable.)

### Lot

Each separate property described in the catalogue or (as the case may be) the property that the seller has agreed to sell and the buyer to buy (including chattels, if any).

### Old arrears

Arrears due under any of the tenancies that are not "new tenancies" as defined by the Landlord and Tenant (Covenants) Act 1995.

### Particulars

The section of the catalogue that contains descriptions of each lot (as varied by any addendum).

### Practitioner

An insolvency practitioner for the purposes of the Insolvency Act 1986 (or, in relation to jurisdictions outside the United Kingdom, any similar official).

### Price

The price that the buyer agrees to pay for the lot.

### Ready to complete

Ready, willing and able to complete: if completion would enable the seller to discharge all financial charges secured on the lot that have to be discharged by completion, then those outstanding financial charges do not prevent the seller from being ready to complete.

### Sale conditions

The general conditions as varied by any special conditions or addendum.

### Sale memorandum

The form so headed (whether or not set out in the catalogue) in which the terms of the contract for the sale of the lot are recorded.

### Seller

The person selling the lot. If two or more are jointly the seller their obligations can be enforced against them jointly or against each of them separately.

### Special conditions

Those of the sale conditions so headed that relate to the lot.

### Tenancies

Tenancies, leases, licences to occupy and agreements for lease and any documents varying or supplemental to them.

### Tenancy schedule

The tenancy schedule (if any) forming part of the special conditions.

### Transfer

Transfer includes a conveyance or assignment (and "to transfer" includes "to convey" or "to assign").

### TUPE

The Transfer of Undertakings (Protection of Employment) Regulations 2006.

### VAT

Value Added Tax or other tax of a similar nature.

### VAT option

An option to tax.

### We (and us and our)

The auctioneers.

### You (and your)

Someone who has a copy of the catalogue or who attends or bids at the auction, whether or not a buyer.

## AUCTION CONDUCT CONDITIONS

### A1 INTRODUCTION

A1.1 Words in bold type have special meanings, which are defined in the Glossary.

A1.2 The catalogue is issued only on the basis that you accept these auction conduct conditions. They govern our relationship with you and cannot be disappplied or varied by the sale conditions (even by a condition purporting to replace the whole of the Common Auction Conditions). They can be varied only if we agree.

### A2 OUR ROLE

A2.1 As agents for each seller we have authority to:

- (a) prepare the catalogue from information supplied by or on behalf of each seller;
- (b) offer each lot for sale;
- (c) sell each lot;
- (d) receive and hold deposits;
- (e) sign each sale memorandum; and
- (f) treat a contract as repudiated if the buyer fails to sign a sale memorandum or pay a deposit as required by these auction conduct conditions.

A2.2 Our decision on the conduct of the auction is final.

A2.3 We may cancel the auction, or alter the order in which lots are offered for sale. We may also combine or divide lots. A lot may be sold or withdrawn from sale prior to the auction.

A2.4 You acknowledge that to the extent permitted by law we owe you no duty of care and you have no claim against us for any loss.

### A3 BIDDING AND RESERVE PRICES

A3.1 All bids are to be made in pounds sterling exclusive of any applicable VAT.

A3.2 We may refuse to accept a bid. We do not have to explain why.

A3.3 If there is a dispute over bidding we are entitled to resolve it, and our decision is final.

A3.4 Unless stated otherwise each lot is subject to a reserve price (which may be fixed just before the lot is offered for sale). If no bid equals or exceeds that reserve price the lot will be withdrawn from the auction.

A3.5 Where there is a reserve price the seller may bid (or ask us or another agent to bid on the seller's behalf) up to the reserve price but may not make a bid equal to or exceeding the reserve price. You accept that it is possible that all bids up to the reserve price are bids made by or on behalf of the seller.

A3.6 Where a guide price (or range of prices) is given that guide is the minimum price at which, or range of prices within which, the seller might be prepared to sell at the date of the guide price. But guide prices may change. The last published guide price will normally be at or above any reserve price, but not always – as the seller may fix the final reserve price just before bidding commences

### A4 THE PARTICULARS AND OTHER INFORMATION

A4.1 We have taken reasonable care to prepare particulars that correctly describe each lot. The particulars are based on information supplied by or on behalf of the seller. You need to check that the information in the particulars is correct.

# COMMON AUCTION CONDITIONS (EDITION 3)

REPRODUCED WITH THE CONSENT OF THE RICS

A4.2 If the **special conditions** do not contain a description of the **lot**, or simply refer to the relevant **lot number**, you take the risk that the description contained in the **particulars** is incomplete or inaccurate, as the **particulars** have not been prepared by a conveyancer and are not intended to form part of a legal contract.

A4.3 The **particulars** and the **sale conditions** may change prior to the **auction** and it is **your** responsibility to check that **you** have the correct versions.

A4.4 If **we** provide information, or a copy of a document, provided by others **we** do so only on the basis that **we** are not responsible for the accuracy of that information or document.

## A5 THE CONTRACT

A5.1 A successful bid is one **we** accept as such (normally on the fall of the hammer). This **condition A5** applies to **you** if **you** make the successful bid for a **lot**.

A5.2 **You** are obliged to buy the **lot** on the terms of the **sale memorandum** at the **price** **you** bid plus **VAT** (if applicable).

A5.3 **You** must before leaving the **auction**:

- (a) provide all information **we** reasonably need from **you** to enable **us** to complete the **sale memorandum** (including proof of your identity if required by **us**);
- (b) sign the completed **sale memorandum**; and
- (c) pay the deposit.

A5.4 If **you** do not **we** may either:

- (a) as agent for the **seller** treat that failure as **your** repudiation of the **contract** and offer the **lot** for sale again: the **seller** may then have a claim against **you** for breach of contract; or
- (b) sign the **sale memorandum** on **your** behalf.

A5.5 **The deposit**:

- (a) is to be held as stakeholder where **VAT** would be chargeable on the deposit were it to be held as agent for the **seller**, but otherwise is to be held as stated in the **sale conditions**; and
- (b) must be paid in pounds sterling by cheque or by bankers' draft made payable to **us** on an **approved financial institution**. The extra auction conduct conditions may state if **we** accept any other form of payment.

A5.6 **We** may retain the **sale memorandum** signed by or on behalf of the **seller** until the deposit has been received in cleared funds.

A5.7 If the **buyer** does not comply with its obligations under the **contract** then:

- (a) **you** are personally liable to buy the **lot** even if **you** are acting as an agent; and
- (b) **you** must indemnify the **seller** in respect of any loss the **seller** incurs as a result of the **buyer's** default.

A5.8 Where the **buyer** is a company **you** warrant that the **buyer** is properly constituted and able to buy the **lot**.

## A6 EXTRA AUCTION CONDUCT CONDITIONS

A6.1 Despite any **special condition** to the contrary the minimum deposit **we** accept is £3,000 (or the total **price**, if less). A **special condition** may, however, require a higher minimum deposit.

## GENERAL CONDITIONS OF SALE

Words in **bold type** have special meanings, which are defined in the Glossary

### G1. THE LOT

G1.1 The **lot** (including any rights to be granted or reserved, and any exclusions from it) is described in the **special conditions**, or if not so described the **lot** is that referred to in the **sale memorandum**.

G1.2 The **lot** is sold subject to any **tenancies** disclosed by the **special conditions**, but otherwise with vacant possession on **completion**.

G1.3 The **lot** is sold subject to all matters contained or referred to in the **documents**, but excluding any **financial charges**: these the **seller** must discharge on or before **completion**.

G1.4 The **lot** is also sold subject to such of the following as may affect it, whether they arise before or after the **contract date** and whether or not they are disclosed by the **seller** or are apparent from inspection of the **lot** or from the **documents**:

- (a) matters registered or capable of registration as local land charges;
- (b) matters registered or capable of registration by any competent authority or under the provisions of any statute;
- (c) notices, orders, demands, proposals and requirements of any competent authority;
- (d) charges, notices, orders, restrictions, agreements and other matters relating to town and country planning, highways or public health;
- (e) rights, easements, quasi-easements, and wayleaves;
- (f) outgoing and other liabilities;
- (g) any interest which overrides, within the meaning of the Land Registration Act 2002;
- (h) matters that ought to be disclosed by the searches and enquiries a prudent buyer would make, whether or not the **buyer** has made them; and
- (i) anything the **seller** does not and could not reasonably know about.

G1.5 Where anything subject to which the **lot** is sold would expose the **seller** to liability the **buyer** is to comply with it and indemnify the **seller** against that liability.

G1.6 The **seller** must notify the **buyer** of any notices, orders, demands, proposals and requirements of any competent authority of which it learns after the **contract date** but the **buyer** must comply with them and keep the **seller** indemnified.

G1.7 The **lot** does not include any tenant's or trade fixtures or fittings.

G1.8 Where chattels are included in the **lot** the **buyer** takes them as they are at **completion** and the **seller** is not liable if they are not fit for use.

G1.9 The **buyer** buys with full knowledge of:

- (a) the **documents**, whether or not the **buyer** has read them; and
- (b) the physical condition of the **lot** and what could reasonably be discovered on inspection of it, whether or not the **buyer** has inspected it.

G1.10 The **buyer** is not to rely on the information contained in the **particulars** but may rely on the **seller's** conveyancer's written replies to preliminary enquiries to the extent stated in those replies.

### G2. DEPOSIT

G2.1 The amount of the deposit is the greater of:

- (a) any minimum deposit stated in the **auction conduct conditions** (or the total **price**, if this is less than that minimum); and
- (b) 10% of the **price** (exclusive of any **VAT** on the **price**).

G2.2 **The deposit**

- (a) must be paid in pounds sterling by cheque or banker's draft drawn on an **approved financial institution** (or by any other means of payment that the **auctioneers** may accept); and
- (b) is to be held as stakeholder unless the **auction conduct conditions** provide that it is to be held as agent for the **seller**.

G2.3 Where the **auctioneers** hold the deposit as stakeholder they are authorised to release it (and interest on it if applicable) to the **seller** on **completion** or, if **completion** does not take place, to the person entitled to it under the **sale conditions**.

G2.4 If a cheque for all or part of the deposit is not cleared on first presentation the **seller** may treat

the **contract** as at an end and bring a claim against the **buyer** for breach of contract.

G2.5 Interest earned on the deposit belongs to the **seller** unless the **sale conditions** provide otherwise.

### G3. BETWEEN CONTRACT AND COMPLETION

G3.1 Unless the **special conditions** state otherwise, the **seller** is to insure the **lot** from and including the **contract date** to **completion** and:

- (a) produce to the **buyer** on request all relevant insurance details;
  - (b) pay the premiums when due;
  - (c) if the **buyer** so requests, and pays any additional premium, use reasonable endeavours to increase the sum insured or make other changes to the policy;
  - (d) at the request of the **buyer** use reasonable endeavours to have the **buyer's** interest noted on the policy if it does not cover a contracting purchaser;
  - (e) unless otherwise agreed, cancel the insurance at **completion**, apply for a refund of premium and (subject to the rights of any tenant or other third party) pay that refund to the **buyer**; and
  - (f) (subject to the rights of any tenant or other third party) hold on trust for the **buyer** any insurance payments that the **seller** receives in respect of loss or damage arising after the **contract date** or assign to the **buyer** the benefit of any claim;
- and the **buyer** must on **completion** reimburse to the **seller** the cost of that insurance (to the extent not already paid by the **buyer** or a tenant or other third party) for the period from and including the **contract date** to **completion**.

G3.2 No damage to or destruction of the **lot** nor any deterioration in its condition, however caused, entitles the **buyer** to any reduction in **price**, or to delay **completion**, or to refuse to complete.

G3.3 Section 47 of the Law of Property Act 1925 does not apply.

G3.4 Unless the **buyer** is already lawfully in occupation of the **lot** the **buyer** has no right to enter into occupation prior to **completion**.

### G4. TITLE AND IDENTITY

G4.1 Unless **condition G4.2** applies, the **buyer** accepts the title of the **seller** to the **lot** as at the **contract date** and may raise no requisition or objection except in relation to any matter that occurs after the **contract date**.

G4.2 If any of the **documents** is not made available before the **auction** the following provisions apply:

- (a) The **buyer** may raise no requisition on or objection to any of the **documents** that is made available before the **auction**.
- (b) If the **lot** is registered land the **seller** is to give to the **buyer** within five **business days** of the **contract date** an official copy of the entries on the register and title plan and, where noted on the register, of all documents subject to which the **lot** is being sold.
- (c) If the **lot** is not registered land the **seller** is to give to the **buyer** within five **business days** an abstract or epitome of title starting from the root of title mentioned in the **special conditions** (or, if none is mentioned, a good root of title more than fifteen years old) and must produce to the **buyer** the original or an examined copy of every relevant document.
- (d) If title is in the course of registration, title is to consist of certified copies of:
  - (i) the application for registration of title made to the land registry;
  - (ii) the **documents** accompanying that application;
  - (iii) evidence that all applicable stamp duty land tax relating to that application has been paid; and
  - (iv) a letter under which the **seller** or its conveyancer agrees to use all reasonable endeavours to answer any requisitions raised by the land registry and to instruct the land registry to send the completed registration documents to the **buyer**.
- (e) The **buyer** has no right to object to or make requisitions on any title information more than seven **business days** after that information has been given to the **buyer**.

G4.3 Unless otherwise stated in the **special conditions** the **seller** sells with full title guarantee except that (and the **transfer** shall so provide):

- (a) the covenant set out in section 3 of the Law of Property (Miscellaneous Provisions) Act 1994 shall not extend to matters recorded in registers open to public inspection; these are to be treated as within the actual knowledge of the **buyer**; and
- (b) the covenant set out in section 4 of the Law of Property (Miscellaneous Provisions) Act 1994 shall not extend to any condition or tenant's obligation relating to the state or condition of the **lot** where the **lot** is leasehold property.

G4.4 The **transfer** is to have effect as if expressly subject to all matters subject to which the **lot** is sold under the **contract**.

G4.5 The **seller** does not have to produce, nor may the **buyer** object to or make a requisition in relation to, any prior or superior title even if it is referred to in the **documents**.

G4.6 The **seller** (and, if relevant, the **buyer**) must produce to each other such confirmation of, or evidence of, their identity and that of their mortgagees and attorneys (if any) as is necessary for the other to be able to comply with applicable Land Registry Rules when making application for registration of the transaction to which the **conditions** apply.

### G5. TRANSFER

G5.1 Unless a form of **transfer** is prescribed by the **special conditions**:

- (a) the **buyer** must supply a draft **transfer** to the **seller** at least ten **business days** before the **agreed completion date** and the engrossment (signed as a deed by the **buyer** if **condition G5.2** applies) five **business days** before that date or (if later) two **business days** after the draft has been approved by the **seller**; and
- (b) the **seller** must approve or revise the draft **transfer** within five **business days** of receiving it from the **buyer**.

G5.2 If the **seller** remains liable in any respect in relation to the **lot** (or a **tenancy**) following **completion** the **buyer** is specifically to covenant in the **transfer** to indemnify the **seller** against that liability.

G5.3 The **seller** cannot be required to **transfer** the **lot** to anyone other than the **buyer**, or by more than one **transfer**.

### G6. COMPLETION

G6.1 **Completion** is to take place at the offices of the **seller's** conveyancer, or where the **seller** may reasonably require, on the **agreed completion date**. The **seller** can only be required to complete on a **business day** and between the hours of 0930 and 1700.

G6.2 The amount payable on **completion** is the balance of the **price** adjusted to take account of apportionments plus (if applicable) **VAT** and interest.

G6.3 Payment is to be made in pounds sterling and only by:

- (a) direct transfer to the **seller's** conveyancer's client account; and
- (b) the release of any deposit held by a stakeholder.

G6.4 Unless the **seller** and the **buyer** otherwise agree, **completion** cannot take place until both have complied with their obligations under the **contract** and the balance of the **price** is unconditionally received in the **seller's** conveyancer's client account.

G6.5 If **completion** takes place after 1400 hours for a reason other than the **seller's** default it is to be treated, for the purposes of apportionment and calculating interest, as if it had taken place on the next **business day**.

G6.6 Where applicable the **contract** remains in force following **completion**.



# COMMON AUCTION CONDITIONS (EDITION 3)

REPRODUCED WITH THE CONSENT OF THE RICS

## G7. NOTICE TO COMPLETE

G7.1 The seller or the buyer may on or after the agreed completion date but before completion give the other notice to complete within ten business days (excluding the date on which the notice is given) making time of the essence.

G7.2 The person giving the notice must be ready to complete.

G7.3 If the buyer fails to comply with a notice to complete the seller may, without affecting any other remedy the seller has:

- (a) terminate the contract;
- (b) claim the deposit and any interest on it if held by a stakeholder;
- (c) forfeit the deposit and any interest on it;
- (d) resell the lot; and
- (e) claim damages from the buyer.

G7.4 If the seller fails to comply with a notice to complete the buyer may, without affecting any other remedy the buyer has:

- (a) terminate the contract; and
- (b) recover the deposit and any interest on it from the seller or, if applicable, a stakeholder.

## G8. IF THE CONTRACT IS BROUGHT TO AN END

If the contract is lawfully brought to an end:

- (a) the buyer must return all papers to the seller and appoints the seller its agent to cancel any registration of the contract; and
- (b) the seller must return the deposit and any interest on it to the buyer (and the buyer may claim it from the stakeholder, if applicable) unless the seller is entitled to forfeit the deposit under condition G7.3.

## G9. LANDLORD'S LICENCE

G9.1 Where the lot is or includes leasehold land and licence to assign is required this condition G9 applies.

G9.2 The contract is conditional on that licence being obtained, by way of formal licence if that is what the landlord lawfully requires.

G9.3 The agreed completion date is not to be earlier than the date five business days after the seller has given notice to the buyer that licence has been obtained.

G9.4 The seller must:

- (a) use all reasonable endeavours to obtain the licence at the seller's expense; and
- (b) enter into any authorised guarantee agreement properly required.

G9.5 The buyer must:

- (a) promptly provide references and other relevant information; and
- (b) comply with the landlord's lawful requirements.

G9.6 If within three months of the contract date (or such longer period as the seller and buyer agree) the licence has not been obtained the seller or the buyer may (if not then in breach of any obligation under this condition G9) by notice to the other terminate the contract at any time before licence is obtained. That termination is without prejudice to the claims of either seller or buyer for breach of this condition G9.

## G10. INTEREST AND APPORTIONMENTS

G10.1 If the actual completion date is after the agreed completion date for any reason other than the seller's default the buyer must pay interest at the interest rate on the price (less any deposit paid) from the agreed completion date up to and including the actual completion date.

G10.2 Subject to condition G11 the seller is not obliged to apportion or account for any sum at completion unless the seller has received that sum in cleared funds. The seller must pay to the buyer after completion any sum to which the buyer is entitled that the seller subsequently receives in cleared funds.

G10.3 Income and outgoings are to be apportioned at actual completion date unless:

- (a) the buyer is liable to pay interest; and
  - (b) the seller has given notice to the buyer at any time up to completion requiring apportionment on the date from which interest becomes payable by the buyer;
- in which event income and outgoings are to be apportioned on the date from which interest becomes payable by the buyer.

G10.4 Apportionments are to be calculated on the basis that:

- (a) the seller receives income and is liable for outgoings for the whole of the day on which apportionment is to be made;
- (b) annual income and expenditure accrues at an equal daily rate assuming 365 days in a year, and income and expenditure relating to some other period accrues at an equal daily rate during the period to which it relates; and
- (c) where the amount to be apportioned is not known at completion apportionment is to be made by reference to a reasonable estimate and further payment is to be made by seller or buyer as appropriate within five business days of the date when the amount is known.

## G11. ARREARS

### Part 1 Current rent

G11.1 "Current rent" means, in respect of each of the tenancies subject to which the lot is sold, the instalment of rent and other sums payable by the tenant in advance on the most recent rent payment date on or within four months preceding completion.

G11.2 If on completion there are any arrears of current rent the buyer must pay them, whether or not details of those arrears are given in the special conditions.

G11.3 Parts 2 and 3 of this condition G11 do not apply to arrears of current rent.

### Part 2 Buyer to pay for arrears

G11.4 Part 2 of this condition G11 applies where the special conditions give details of arrears.

G11.5 The buyer is on completion to pay, in addition to any other money then due, an amount equal to all arrears of which details are set out in the special conditions.

G11.6 If those arrears are not old arrears the seller is to assign to the buyer all rights that the seller has to recover those arrears.

### Part 3 Buyer not to pay for arrears

G11.7 Part 3 of this condition G11 applies where the special conditions:

- (a) so state; or
- (b) give no details of any arrears.

G11.8 While any arrears due to the seller remain unpaid the buyer must:

- (a) try to collect them in the ordinary course of management but need not take legal proceedings or forfeit the tenancy;
- (b) pay them to the seller within five business days of receipt in cleared funds (plus interest at the interest rate calculated on a daily basis for each subsequent day's delay in payment);
- (c) on request, at the cost of the seller, assign to the seller or as the seller may direct the right to demand and sue for old arrears, such assignment to be in such form as the seller's conveyancer may reasonably require;
- (d) if reasonably required, allow the seller's conveyancer to have on loan the counterpart of any tenancy against an undertaking to hold it to the buyer's order;

(e) not without the consent of the seller release any tenant or surety from liability to pay arrears or accept a surrender of or forfeit any tenancy under which arrears are due; and

(f) if the buyer disposes of the lot prior to recovery of all arrears obtain from the buyer's successor in title a covenant in favour of the seller in similar form to part 3 of this condition G11.

G11.9 Where the seller has the right to recover arrears it must not without the buyer's written consent bring insolvency proceedings against a tenant or seek the removal of goods from the lot.

## G12. MANAGEMENT

G12.1 This condition G12 applies where the lot is sold subject to tenancies.

G12.2 The seller is to manage the lot in accordance with its standard management policies pending completion.

G12.3 The seller must consult the buyer on all management issues that would affect the buyer after completion (such as, but not limited to, an application for licence; a rent review; a variation, surrender, agreement to surrender or proposed forfeiture of a tenancy; or a new tenancy or agreement to grant a new tenancy) and:

- (a) the seller must comply with the buyer's reasonable requirements unless to do so would (but for the indemnity in paragraph (c)) expose the seller to a liability that the seller would not otherwise have, in which case the seller may act reasonably in such a way as to avoid that liability;
- (b) if the seller gives the buyer notice of the seller's intended act and the buyer does not object within five business days giving reasons for the objection the seller may act as the seller intends; and
- (c) the buyer is to indemnify the seller against all loss or liability the seller incurs through acting as the buyer requires, or by reason of delay caused by the buyer.

## G13. RENT DEPOSITS

G13.1 This condition G13 applies where the seller is holding or otherwise entitled to money by way of rent deposit in respect of a tenancy. In this condition G13 "rent deposit deed" means the deed or other document under which the rent deposit is held.

G13.2 If the rent deposit is not assignable the seller must on completion hold the rent deposit on trust for the buyer and, subject to the terms of the rent deposit deed, comply at the cost of the buyer with the buyer's lawful instructions.

G13.3 Otherwise the seller must on completion pay and assign its interest in the rent deposit to the buyer under an assignment in which the buyer covenants with the seller to:

- (a) observe and perform the seller's covenants and conditions in the rent deposit deed and indemnify the seller in respect of any breach;
- (b) give notice of assignment to the tenant; and
- (c) give such direct covenant to the tenant as may be required by the rent deposit deed.

## G14. VAT

G14.1 Where a sale condition requires money to be paid or other consideration to be given, the payer must also pay any VAT that is chargeable on that money or consideration, but only if given a valid VAT invoice.

G14.2 Where the special conditions state that no VAT option has been made the seller confirms that none has been made by it or by any company in the same VAT group nor will be prior to completion.

## G15. TRANSFER AS A GOING CONCERN

G15.1 Where the special conditions so state:

- (a) the seller and the buyer intend, and will take all practicable steps (short of an appeal) to procure, that the sale is treated as a transfer of a going concern; and
- (b) this condition G15 applies.

G15.2 The seller confirms that the seller

- (a) is registered for VAT, either in the seller's name or as a member of the same VAT group; and
- (b) has (unless the sale is a standard-rated supply) made in relation to the lot a VAT option that remains valid and will not be revoked before completion.

G15.3 The buyer confirms that:

- (a) it is registered for VAT, either in the buyer's name or as a member of a VAT group;
- (b) it has made, or will make before completion, a VAT option in relation to the lot and will not revoke it before or within three months after completion;
- (c) article 5(2B) of the Value Added Tax (Special Provisions) Order 1995 does not apply to it; and
- (d) it is not buying the lot as a nominee for another person.

G15.4 The buyer is to give to the seller as early as possible before the agreed completion date evidence:

- (a) of the buyer's VAT registration;
- (b) that the buyer has made a VAT option; and
- (c) that the VAT option has been notified in writing to HM Revenue and Customs; and if it does not produce the relevant evidence at least two business days before the agreed completion date, condition G14.1 applies at completion.

G15.5 The buyer confirms that after completion the buyer intends to:

- (a) retain and manage the lot for the buyer's own benefit as a continuing business as a going concern subject to and with the benefit of the tenancies; and
- (b) collect the rents payable under the tenancies and charge VAT on them

G15.6 If, after completion, it is found that the sale of the lot is not a transfer of a going concern then:

- (a) the seller's conveyancer is to notify the buyer's conveyancer of that finding and provide a VAT invoice in respect of the sale of the lot;
- (b) the buyer must within five business days of receipt of the VAT invoice pay to the seller the VAT due; and
- (c) if VAT is payable because the buyer has not complied with this condition G15, the buyer must pay and indemnify the seller against all costs, interest, penalties or surcharges that the seller incurs as a result.

## G16. CAPITAL ALLOWANCES

G16.1 This condition G16 applies where the special conditions state that there are capital allowances available in respect of the lot.

G16.2 The seller is promptly to supply to the buyer all information reasonably required by the buyer in connection with the buyer's claim for capital allowances.

G16.3 The value to be attributed to those items on which capital allowances may be claimed is set out in the special conditions.

G16.4 The seller and buyer agree:

- (a) to make an election on completion under Section 198 of the Capital Allowances Act 2001 to give effect to this condition G16; and
- (b) to submit the value specified in the special conditions to HM Revenue and Customs for the purposes of their respective capital allowance computations.

## G17. MAINTENANCE AGREEMENTS

G17.1 The seller agrees to use reasonable endeavours to transfer to the buyer, at the buyer's cost, the benefit of the maintenance agreements specified in the special conditions.

G17.2 The buyer must assume, and indemnify the seller in respect of, all liability under such contracts from the actual completion date.

# COMMON AUCTION CONDITIONS (EDITION 3)

REPRODUCED WITH THE CONSENT OF THE RICS

## G18. LANDLORD AND TENANT ACT 1987

G18.1 This condition G18 applies where the sale is a relevant disposal for the purposes of part I of the Landlord and Tenant Act 1987.

G18.2 The seller warrants that the seller has complied with sections 5B and 7 of that Act and that the requisite majority of qualifying tenants has not accepted the offer.

## G19. SALE BY PRACTITIONER

G19.1 This condition G19 applies where the sale is by a practitioner either as seller or as agent of the seller.

G19.2 The practitioner has been duly appointed and is empowered to sell the lot.

G19.3 Neither the practitioner nor the firm or any member of the firm to which the practitioner belongs has any personal liability in connection with the sale or the performance of the seller's obligations. The transfer is to include a declaration excluding that personal liability.

G19.4 The lot is sold:

- (a) in its condition at completion;
  - (b) for such title as the seller may have; and
  - (c) with no title guarantee;
- and the buyer has no right to terminate the contract or any other remedy if information provided about the lot is inaccurate, incomplete or missing.

G19.5 Where relevant:

- (a) the documents must include certified copies of those under which the practitioner is appointed, the document of appointment and the practitioner's acceptance of appointment; and
- (b) the seller may require the transfer to be by the lender exercising its power of sale under the Law of Property Act 1925.

G19.6 The buyer understands this condition G19 and agrees that it is fair in the circumstances of a sale by a practitioner.

## G20. TUPE

G20.1 If the special conditions state "There are no employees to which TUPE applies", this is a warranty by the seller to this effect.

G20.2 If the special conditions do not state "There are no employees to which TUPE applies" the following paragraphs apply:

- (a) The seller must notify the buyer of those employees whose contracts of employment will transfer to the buyer on completion (the "Transferring Employees"). This notification must be given to the buyer not less than 14 days before completion.
- (b) The buyer confirms that it will comply with its obligations under TUPE and any special conditions in respect of the Transferring Employees.
- (c) The buyer and the seller acknowledge that pursuant and subject to TUPE, the contracts of employment between the Transferring Employees and the seller will transfer to the buyer on completion.
- (d) The buyer is to keep the seller indemnified against all liability for the Transferring Employees after completion.

## G21. ENVIRONMENTAL

G21.1 This condition G21 only applies where the special conditions so provide.

G21.2 The seller has made available such reports as the seller has as to the environmental condition of the lot and has given the buyer the opportunity to carry out investigations (whether or not the buyer has read those reports or carried out any investigation) and the buyer admits that the price takes into account the environmental condition of the lot.

G21.3 The buyer agrees to indemnify the seller in respect of all liability for or resulting from the environmental condition of the lot.

## G22. SERVICE CHARGE

G22.1 This condition G22 applies where the lot is sold subject to tenancies that include service charge provisions.

G22.2 No apportionment is to be made at completion in respect of service charges.

G22.3 Within two months after completion the seller must provide to the buyer a detailed service charge account for the service charge year current on completion showing:

- (a) service charge expenditure attributable to each tenancy;
- (b) payments on account of service charge received from each tenant;
- (c) any amounts due from a tenant that have not been received;
- (d) any service charge expenditure that is not attributable to any tenancy and is for that reason irrecoverable.

G22.4 In respect of each tenancy, if the service charge account shows that:

- (a) payments on account (whether received or still then due from a tenant) exceed attributable service charge expenditure, the seller must pay to the buyer an amount equal to the excess when it provides the service charge account;
  - (b) attributable service charge expenditure exceeds payments on account (whether those payments have been received or are still then due), the buyer must use all reasonable endeavours to recover the shortfall from the tenant at the next service charge reconciliation date and pay the amount so recovered to the seller within five business days of receipt in cleared funds;
- but in respect of payments on account that are still due from a tenant condition G11 (arrears) applies.

G22.5 In respect of service charge expenditure that is not attributable to any tenancy the seller must pay the expenditure incurred in respect of the period before actual completion date and the buyer must pay the expenditure incurred in respect of the period after actual completion date. Any necessary monetary adjustment is to be made within five business days of the seller providing the service charge account to the buyer.

G22.6 If the seller holds any reserve or sinking fund on account of future service charge expenditure or a depreciation fund:

- (a) the seller must pay it (including any interest earned on it) to the buyer on completion; and
- (b) the buyer must covenant with the seller to hold it in accordance with the terms of the tenancies and to indemnify the seller if it does not do so.

## G23. RENT REVIEWS

G23.1 This condition G23 applies where the lot is sold subject to a tenancy under which a rent review due on or before the actual completion date has not been agreed or determined.

G23.2 The seller may continue negotiations or rent review proceedings up to the actual completion date but may not agree the level of the revised rent or commence rent review proceedings without the written consent of the buyer, such consent not to be unreasonably withheld or delayed.

G23.3 Following completion the buyer must complete rent review negotiations or proceedings as soon as reasonably practicable but may not agree the level of the revised rent without the written consent of the seller, such consent not to be unreasonably withheld or delayed.

G23.4 The seller must promptly:

- (a) give to the buyer full details of all rent review negotiations and proceedings, including copies of all correspondence and other papers; and
- (b) use all reasonable endeavours to substitute the buyer for the seller in any rent review proceedings.

G23.5 The seller and the buyer are to keep each other informed of the progress of the rent review and have regard to any proposals the other makes in relation to it.

G23.6 When the rent review has been agreed or determined the buyer must account to the seller for any increased rent and interest recovered from the tenant that relates to the seller's period of ownership within five business days of receipt of cleared funds.

G23.7 If a rent review is agreed or determined before completion but the increased rent and any interest recoverable from the tenant has not been received by completion the increased rent and any interest recoverable is to be treated as arrears.

G23.8 The seller and the buyer are to bear their own costs in relation to rent review negotiations and proceedings.

## G24. TENANCY RENEWALS

G24.1 This condition G24 applies where the tenant under a tenancy has the right to remain in occupation under part II of the Landlord and Tenant Act 1954 (as amended) and references to notices and proceedings are to notices and proceedings under that Act.

G24.2 Where practicable, without exposing the seller to liability or penalty, the seller must not without the written consent of the buyer (which the buyer must not unreasonably withhold or delay) serve or respond to any notice or begin or continue any proceedings.

G24.3 If the seller receives a notice the seller must send a copy to the buyer within five business days and act as the buyer reasonably directs in relation to it.

G24.4 Following completion the buyer must:

- (a) with the co-operation of the seller take immediate steps to substitute itself as a party to any proceedings;
- (b) use all reasonable endeavours to conclude any proceedings or negotiations for the renewal of the tenancy and the determination of any interim rent as soon as reasonably practicable at the best rent or rents reasonably obtainable; and
- (c) if any increased rent is recovered from the tenant (whether as interim rent or under the renewed tenancy) account to the seller for the part of that increase that relates to the seller's period of ownership of the lot within five business days of receipt of cleared funds.

G24.5 The seller and the buyer are to bear their own costs in relation to the renewal of the tenancy and any proceedings relating to this.

## G25. WARRANTIES

G25.1 Available warranties are listed in the special conditions.

G25.2 Where a warranty is assignable the seller must:

- (a) on completion assign it to the buyer and give notice of assignment to the person who gave the warranty; and
- (b) apply for (and the seller and the buyer must use all reasonable endeavours to obtain) any consent to assign that is required. If consent has not been obtained by completion the warranty must be assigned within five business days after the consent has been obtained.

G25.3 If a warranty is not assignable the seller must after completion:

- (a) hold the warranty on trust for the buyer; and
- (b) at the buyer's cost comply with such of the lawful instructions of the buyer in relation to the warranty as do not place the seller in breach of its terms or expose the seller to any liability or penalty.

## G26. NO ASSIGNMENT

The buyer must not assign, mortgage or otherwise transfer or part with the whole or any part of the buyer's interest under this contract.

## G27. REGISTRATION AT THE LAND REGISTRY

G27.1 This condition G27.1 applies where the lot is leasehold and its sale either triggers first registration or is a registrable disposition. The buyer must at its own expense and as soon as practicable:

- (a) procure that it becomes registered at Land Registry as proprietor of the lot;
- (b) procure that all rights granted and reserved by the lease under which the lot is held are properly noted against the affected titles; and
- (c) provide the seller with an official copy of the register relating to such lease showing itself registered as proprietor.

G27.2 This condition G27.2 applies where the lot comprises part of a registered title. The buyer must at its own expense and as soon as practicable:

- (a) apply for registration of the transfer;
- (b) provide the seller with an official copy and title plan for the buyer's new title; and
- (c) join in any representations the seller may properly make to Land Registry relating to the application.

## G28. NOTICES AND OTHER COMMUNICATIONS

G28.1 All communications, including notices, must be in writing. Communication to or by the seller or the buyer may be given to or by their conveyancers.

G28.2 A communication may be relied on if:

- (a) delivered by hand; or
- (b) made electronically and personally acknowledged (automatic acknowledgement does not count); or
- (c) there is proof that it was sent to the address of the person to whom it is to be given (as specified in the sale memorandum) by a postal service that offers normally to deliver mail the next following business day.

G28.3 A communication is to be treated as received:

- (a) when delivered, if delivered by hand; or
- (b) when personally acknowledged, if made electronically; but if delivered or made after 1700 hours on a business day a communication is to be treated as received on the next business day.

G28.4 A communication sent by a postal service that offers normally to deliver mail the next following business day will be treated as received on the second business day after it has been posted.

## G29. CONTRACTS (RIGHTS OF THIRD PARTIES) ACT 1999

No one is intended to have any benefit under the contract pursuant to the Contract (Rights of Third Parties) Act 1999.

# Top 9 Results – May 2019

The Smithy, rear of Fern Lea Street,  
Rossendale

Guide Price: £15,000 – £25,000



**SOLD £49,000**

6 Sholver Hill Close, Oldham

Guide Price: £100,000 – £120,000



**SOLD £140,500**

1 Herbert Street, Oldham

Guide Price: £55,000 – £65,000



**SOLD £73,000**

24 Bentmeadows, Rochdale

Guide Price: £55,000 – £65,000



**SOLD £73,500**

29 Chestnut Avenue, Droylsden

Guide Price: £75,000 plus



**SOLD £86,000**

Land adjacent to 120a Withington Road,  
Manchester

Guide Price: £5,000 – £10,000



**SOLD £41,000**

6 Brook Street, Swinton

Guide Price: £125,000 – £150,000



**SOLD £161,000**

Land at Huddersfield Road, Delph

Guide Price: £10,000 – £20,000



**SOLD £88,000**

122 Stakehill Lane, Middleton

Guide Price: £60,000 – £70,000



**SOLD £81,000**

## Do you need to sell quickly?

Entries are being taken for our next auction on

**Tuesday 3rd September 2019**

Call us now on **0161 925 3254**

**AUCTION  
HOUSE  
MANCHESTER**



# Going once...

## The most suitable properties for auction include:

- 🔨 Properties for improvement
- 🔨 Tenanted properties
- 🔨 Residential investments
- 🔨 Development propositions
- 🔨 Building Land
- 🔨 Mixed use properties
- 🔨 Commercial investments
- 🔨 Unique properties
- 🔨 Land (development or greenfield)
- 🔨 Lock up garages

## Auction dates:

**3rd September 2019**

**22nd October 2019**

**10th December 2019**

**[auctionhouse.co.uk/manchester](https://auctionhouse.co.uk/manchester)**

Edge View House, Salmon Fields Business  
Village, Royton OL2 6HT  
☎ 0161 925 3254  
✉ [manchester@auctionhouse.co.uk](mailto:manchester@auctionhouse.co.uk)



**PROPERTY AUCTION EXPERTS**  
**LOCALLY REGIONALLY NATIONALLY**