

AMOSPHERIC SILENCE / CANALIZATION / LUMINESCENCE / PROCESSION

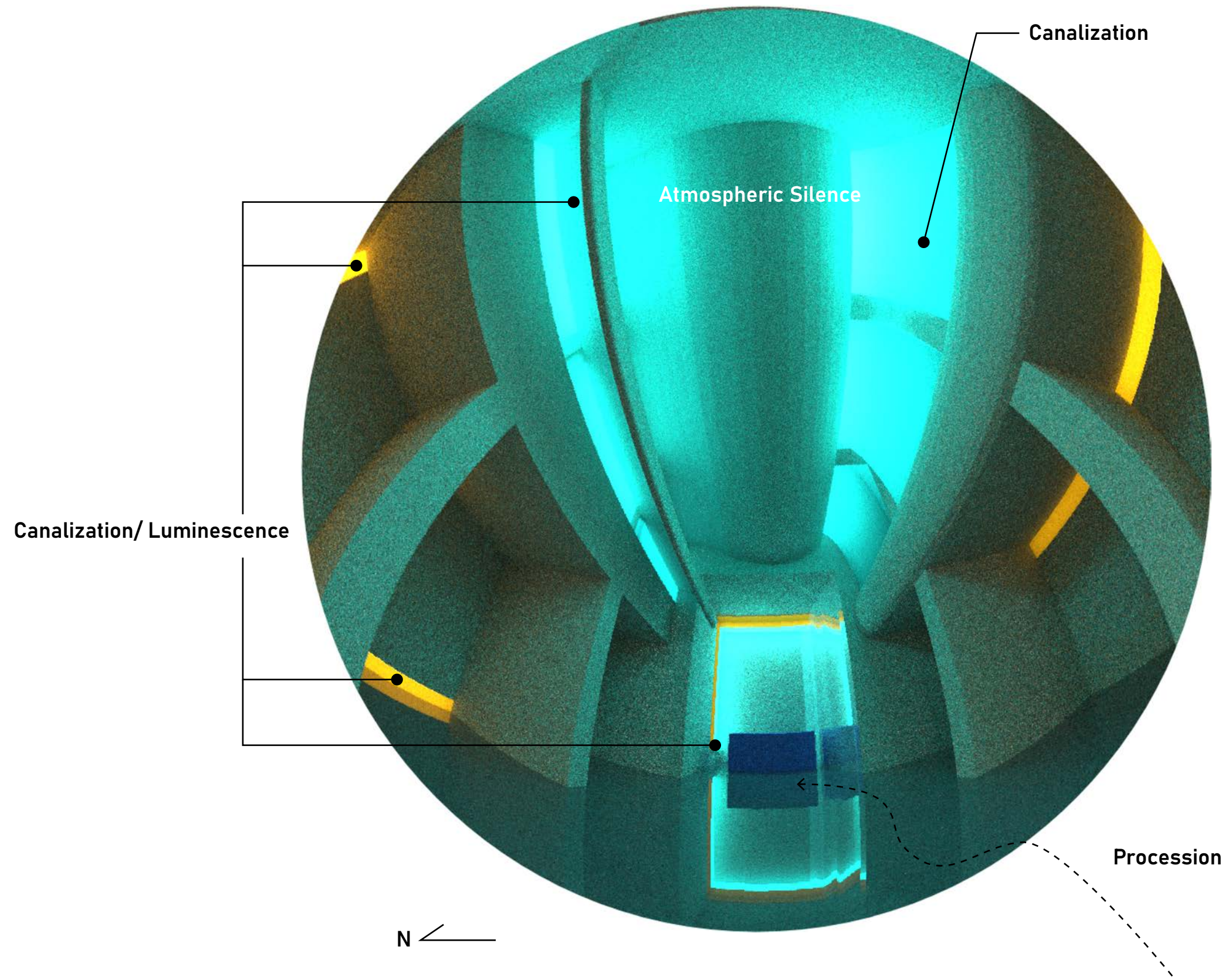

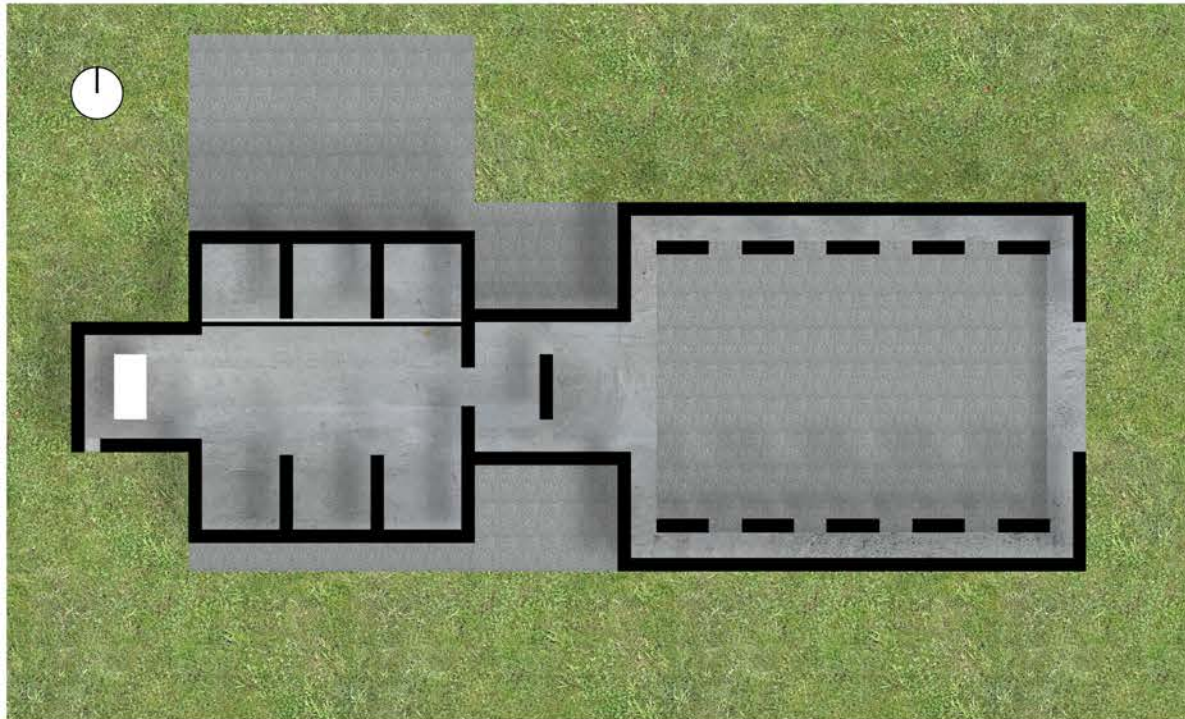

(Midwall Height of Saddlebag Chapels Plan)

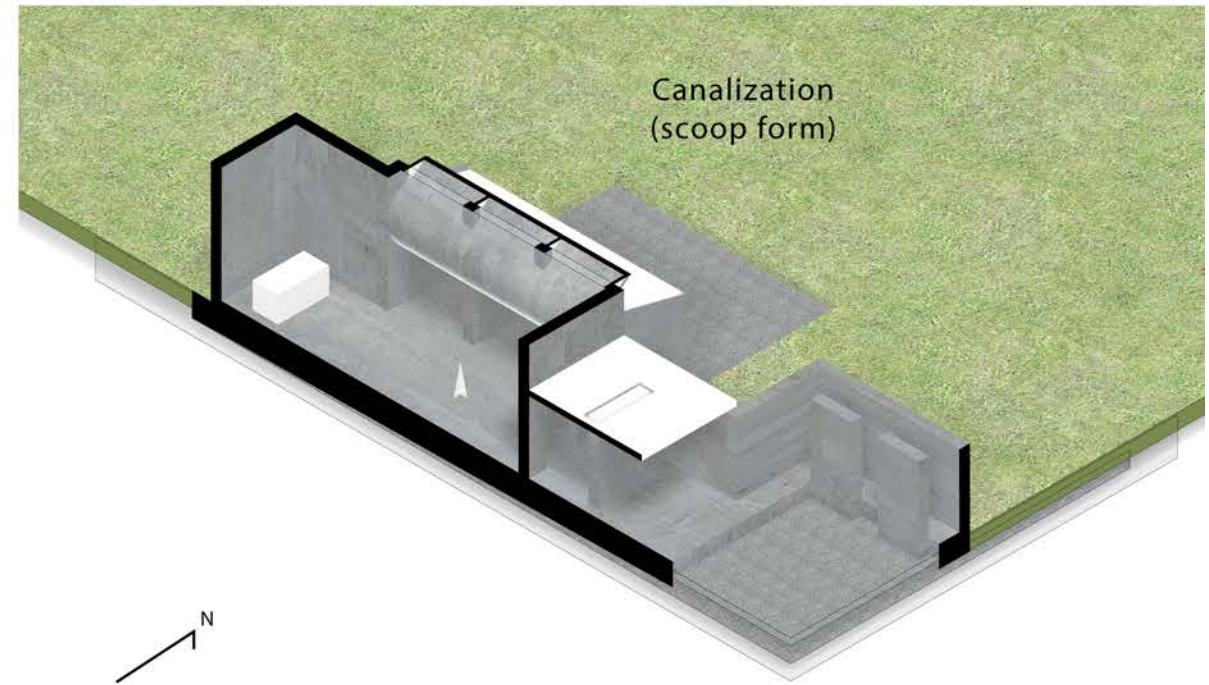

(Narthex Threshold Isometric Perspective)

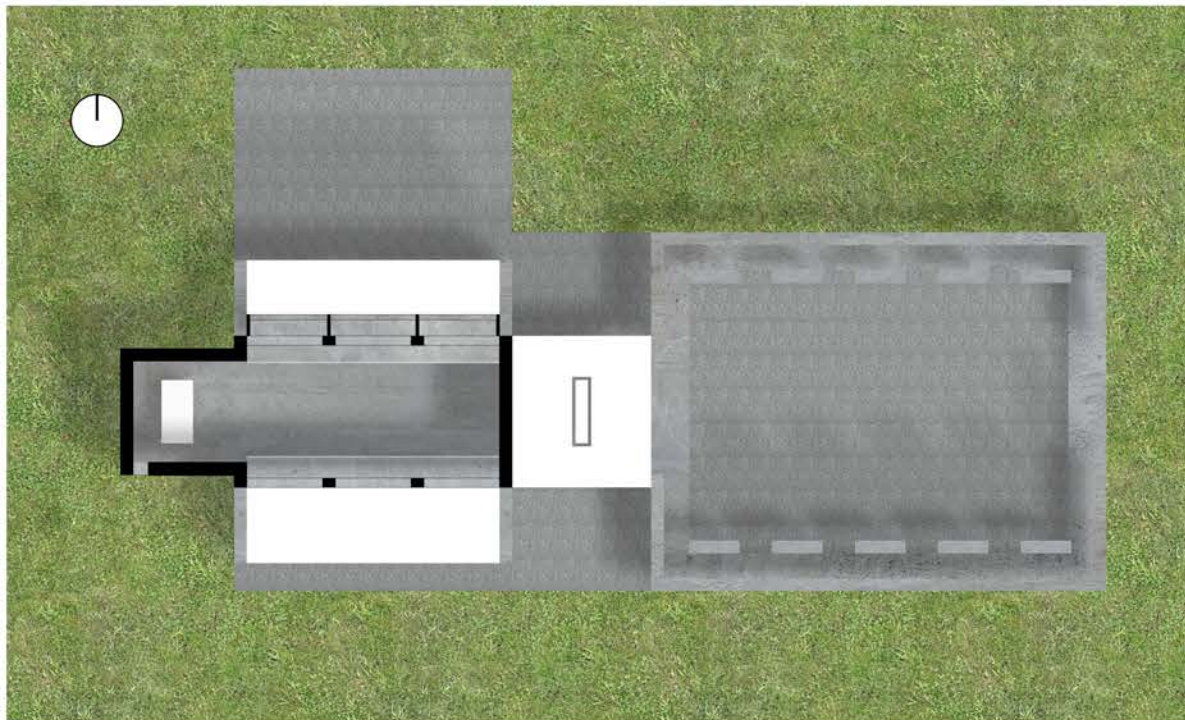

(Midwall Height of Upper Nave Plan)

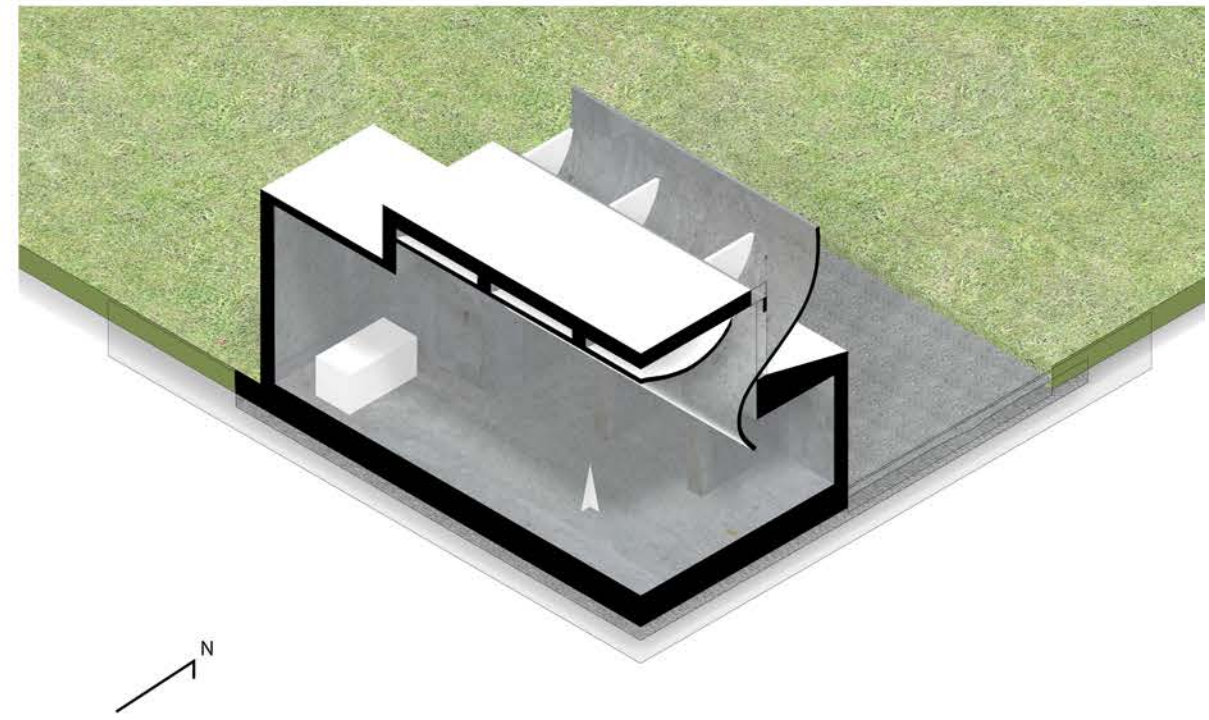

(Chapel Interior Isometric Perspective)

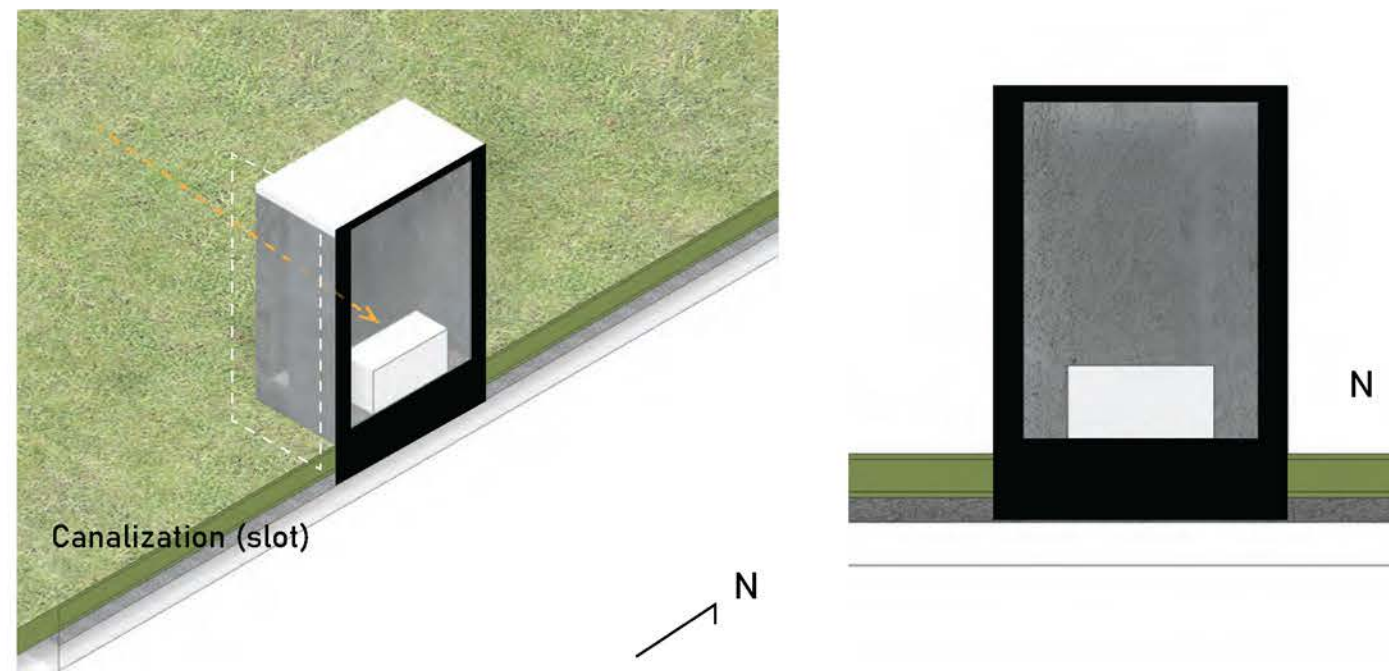

(Apsse Cross Section)

(Apsse Cross Section)

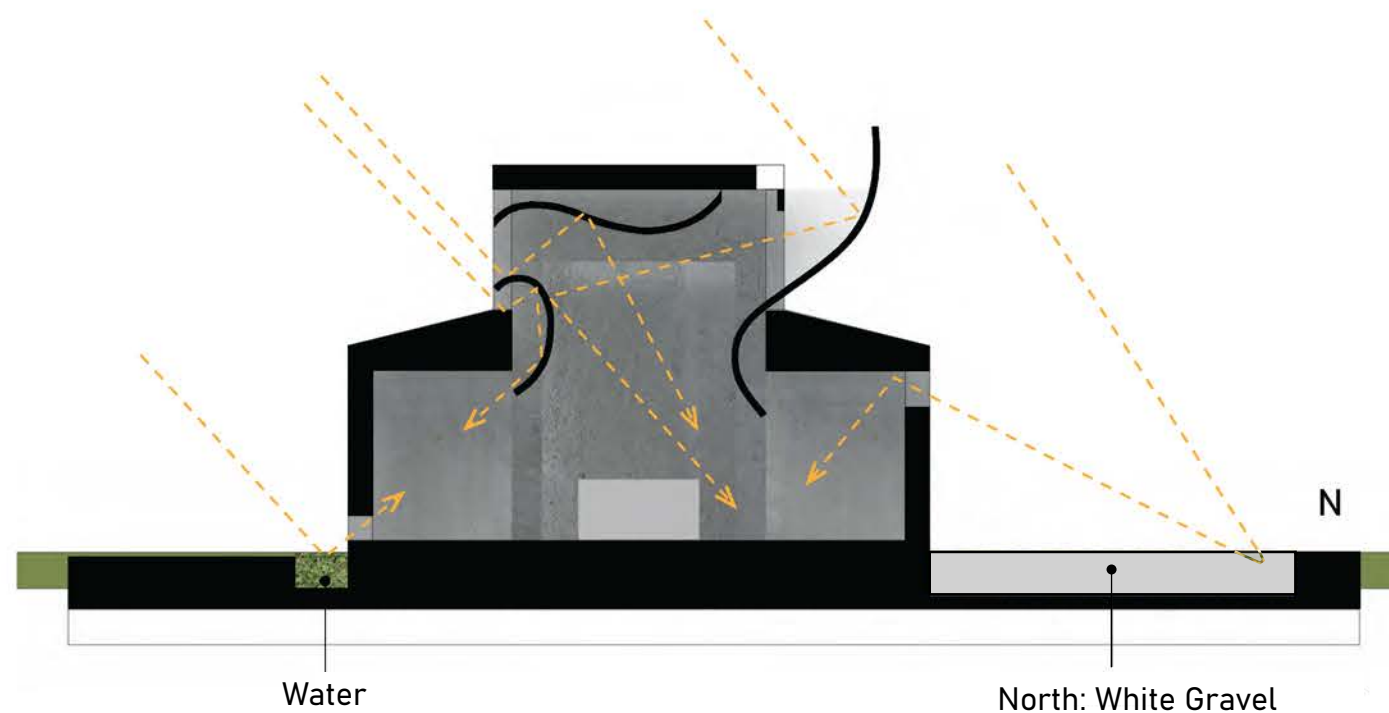

(Nave Cross Section)

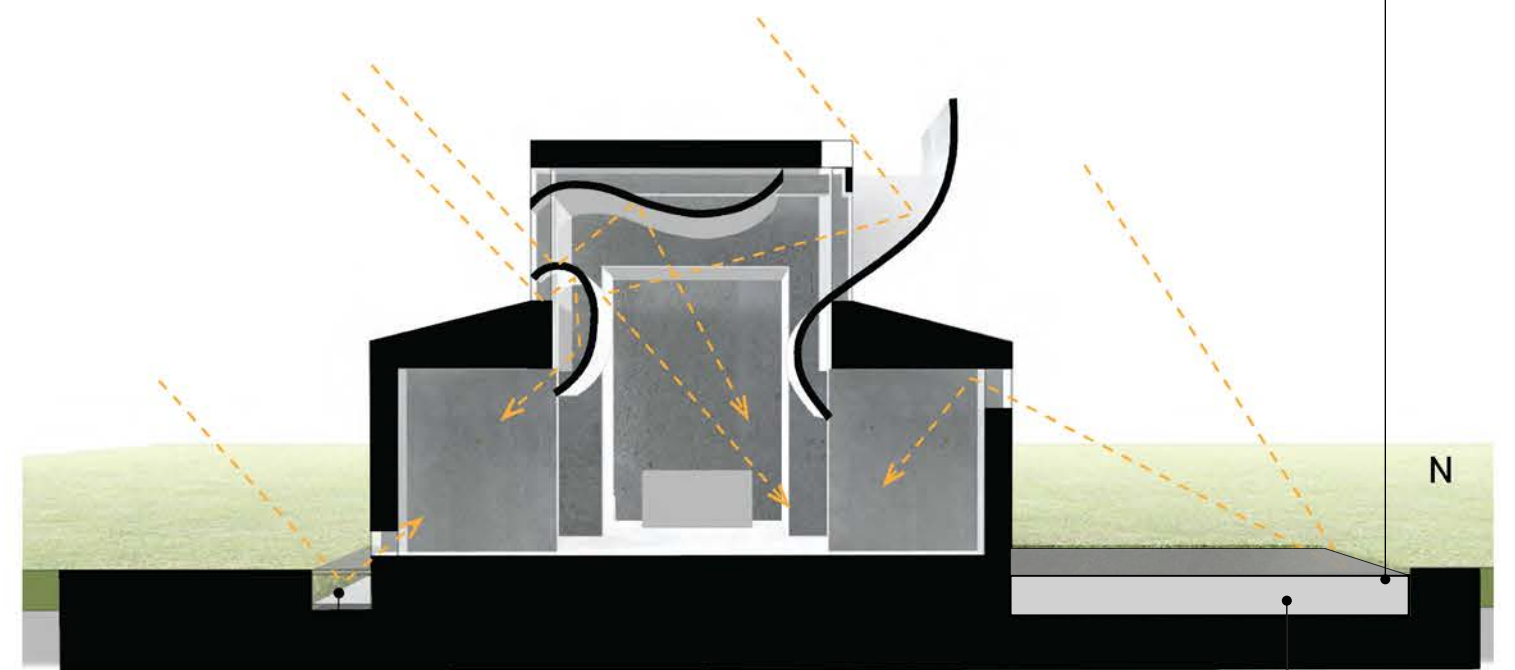

(Chapel Interior Section Perspective)

Water acts as a medium to reflect light into the nave (South)

North: White Gravel, its rough surface can retro-reflect light into the nave

white_gravel	
Type	Radiance trans
Reflectance	47.48%
Specular	0.00%
Diffuse	47.48%
R	0.465
G	0.483
B	0.430
Roughness	0.000
Measurement Type	
Credit	

Atmospheric Silence

The curvilinear geometry (upper nave) contrasts with the rigid earthbound orthogonals of the forecourt as well as the lower nave and chapels.

Canalization/ Luminescence

The slot inserted at both south surface and apse ceiling amplifies the sacredness of the altar.

Canalization

The slots that located at the top (north)/ bottom (south) of the wall form the silhouette of the light.

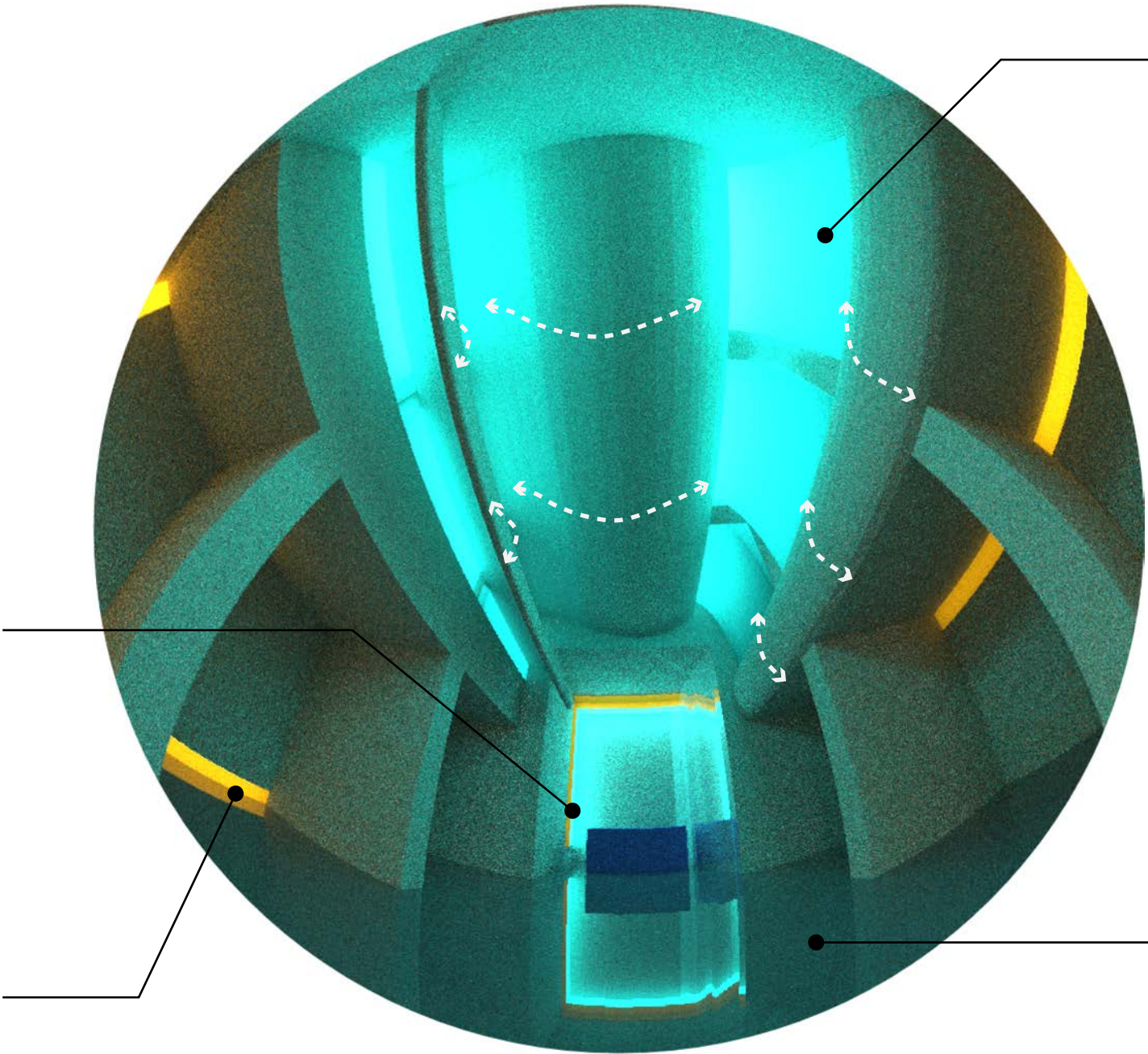

Canalization

In order to guide the diffused light from the north, I designed a scope form to capture sunlight and redirect it back to the interior space.

Procession:

As people approach from threshold to the altar, the lum values of the apertures change from high to low (intriguing experience).

Designated two dominant colors to distinguish the hierarchy within the space. Colors redefine the “ritual” that visitors access from narthex to the holy apse.

(Hemispherical Image, Date/ Time: 09/23, 12:00)

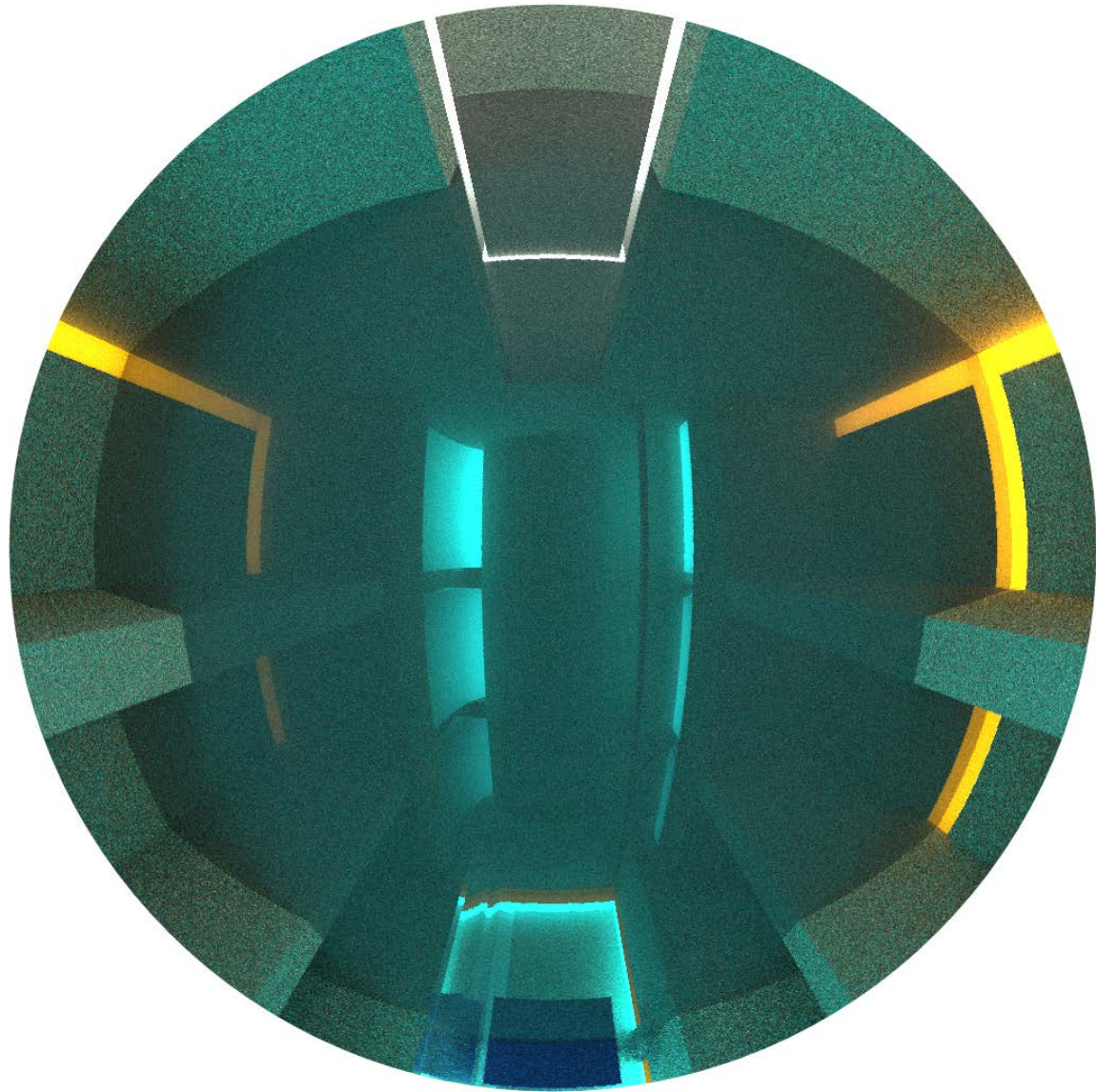

(Reflective Light from Ceiling, POV image, Date/ Time: 09/23, 12:00)

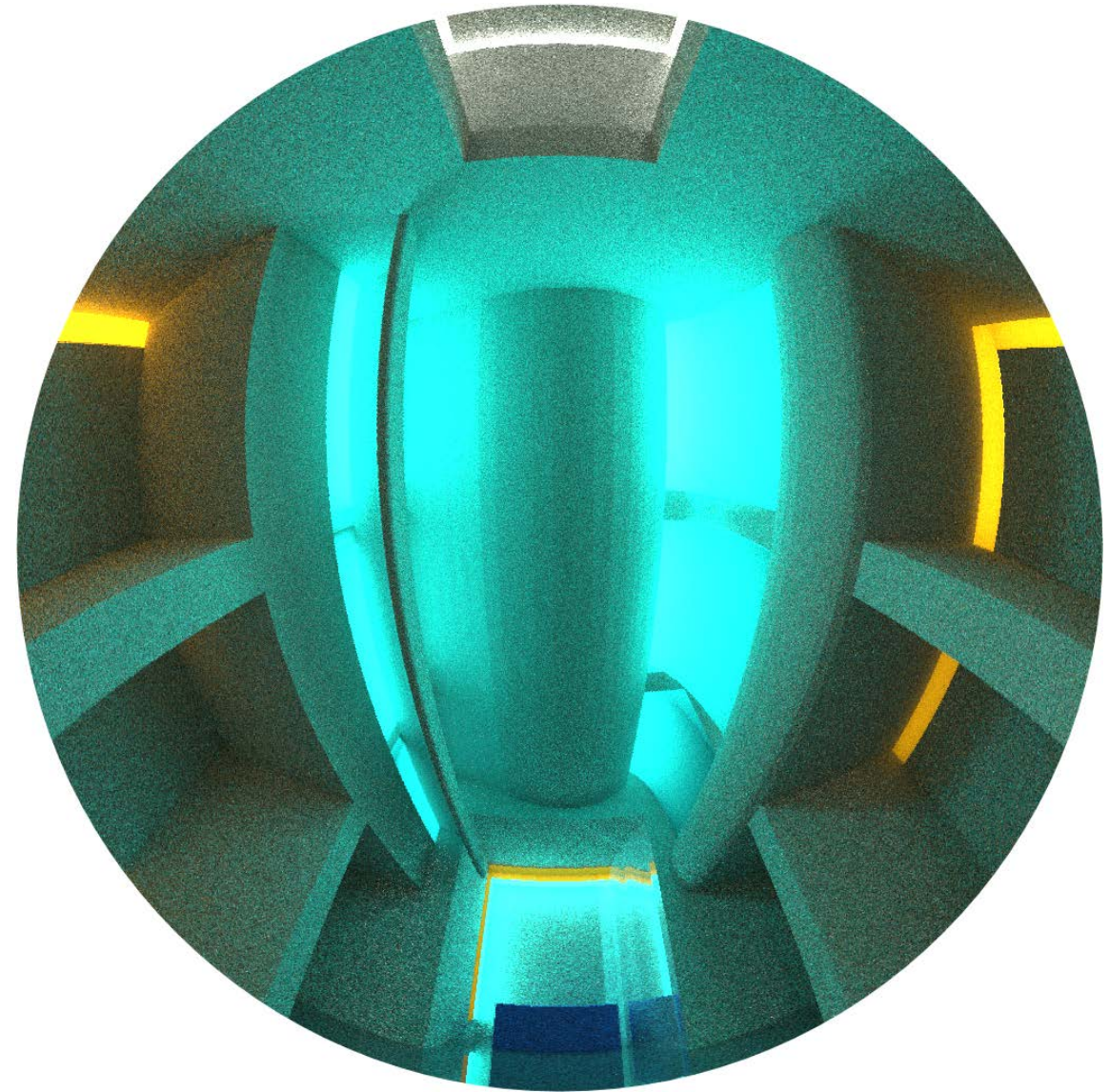

(Softened Light from Ceiling, POV image, Date/ Time: 09/23, 12:00)

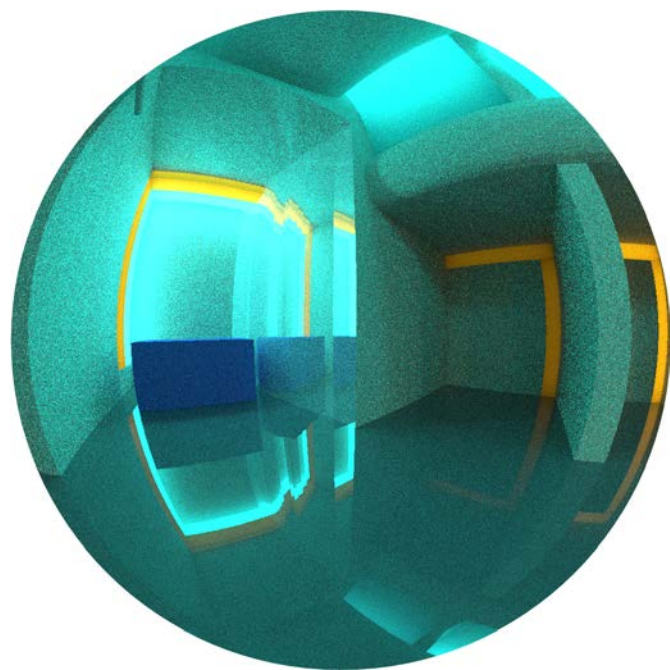

(Detail image: Material Selection)

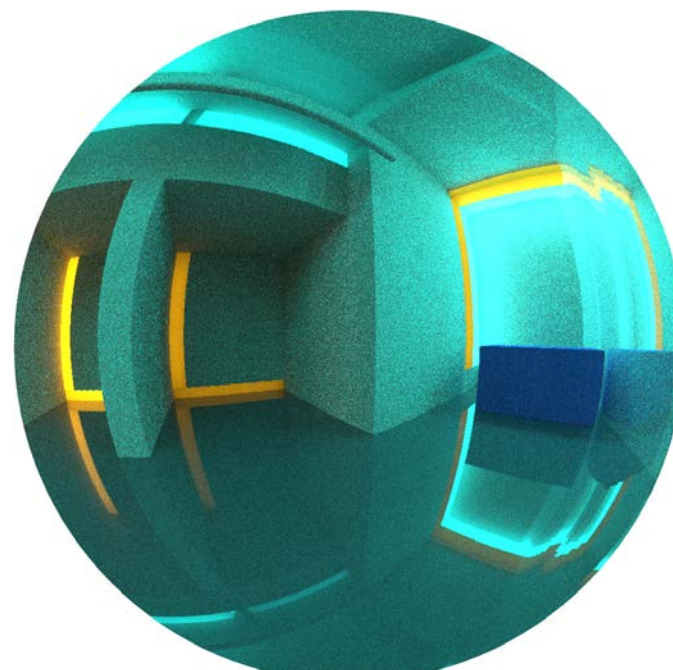

(Detail image: Material Selection)

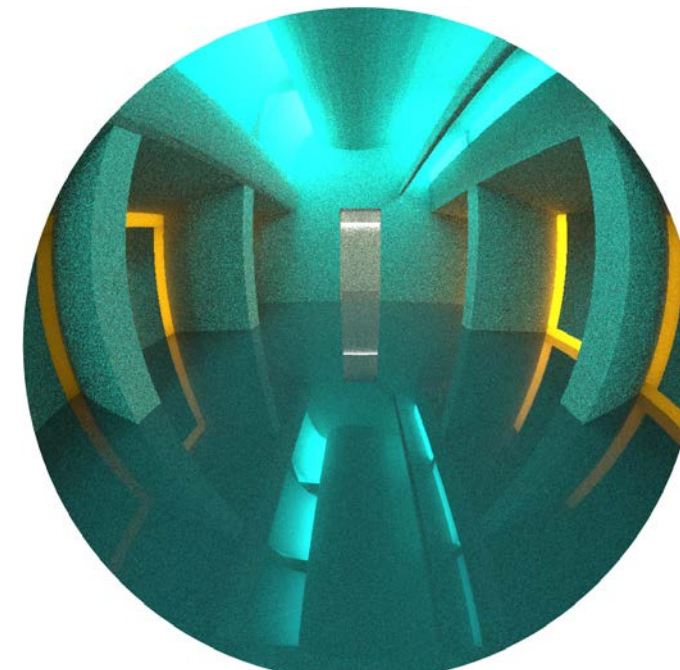

(Detail image: Color Selection)

Assigned **glass** material to the north surface of the apse to amplify the space and diffused light

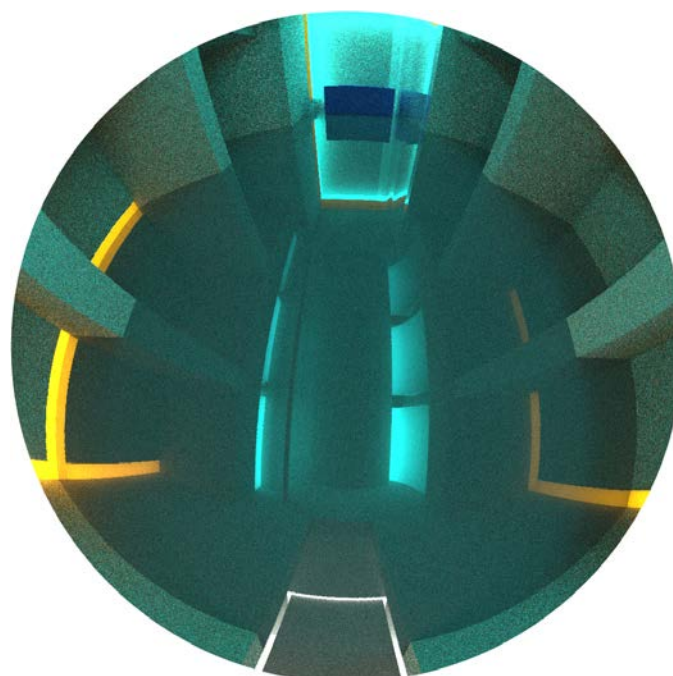

(Detail image: Geometric light path)

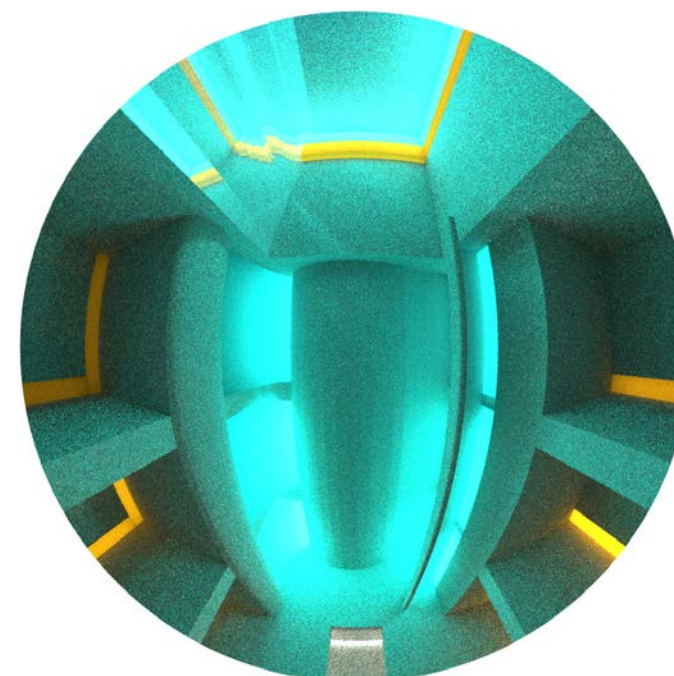

(Detail image: Geometric light path)