

INTERNAL AREAS INCLUDING
WALLS & COLUMNS BUT NOT
STAIRS

UNIT C (ground floor)
floor area 84sq.m., 903sq.ft.

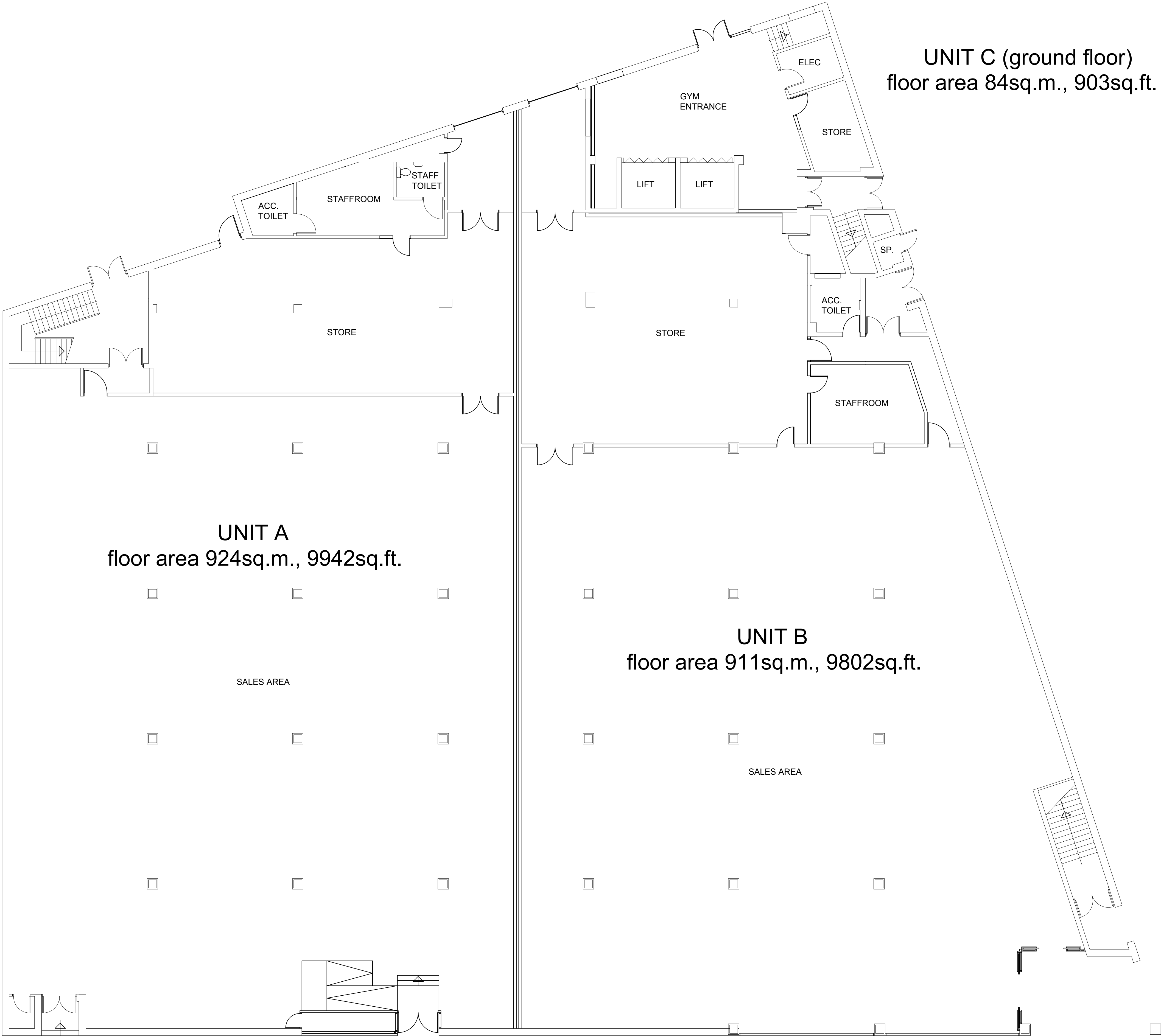

UNIT A
floor area 924sq.m., 9942sq.ft.

UNIT B
floor area 911sq.m., 9802sq.ft.

ground floor
as proposed

Proposals at
2 Fowlds Road
Kilmarnock

scale 1:100 (A1)
dwg no. 27039/3