



CURIOPlayer Z8

Music Player Installation Guide



Welcome to PlayNetwork! This guide has been produced in order to assist you in replacing your existing media player with the new CURIOPlayer Z8.

The process of switching-out the music player should take approximately 20 minutes. It is recommended that you perform the conversion before the store opens since the music will be off during the process.

Please read through this entire guide prior to beginning the player conversion

WHAT'S INCLUDED

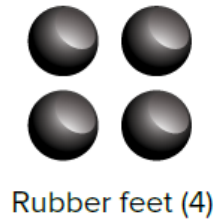

Rubber feet (4)

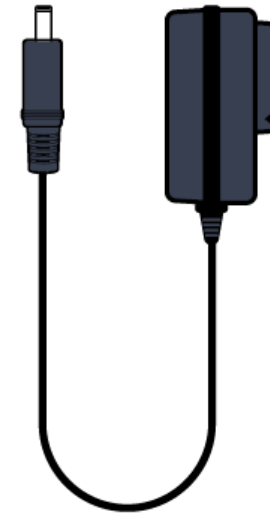

Universal switching power supply with 4 plugs

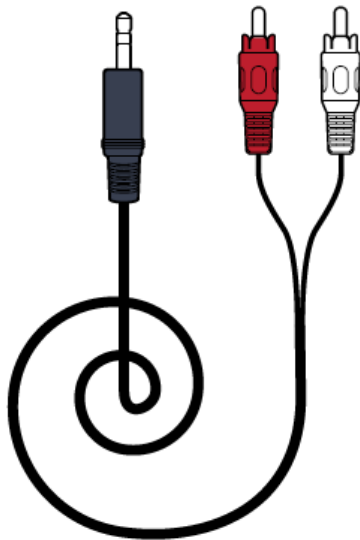

3.5-mm male to dual RCA-M, 6 foot

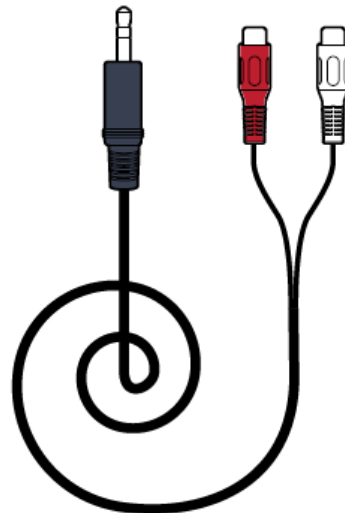

3.5-mm male to dual RCA-F, 6 foot

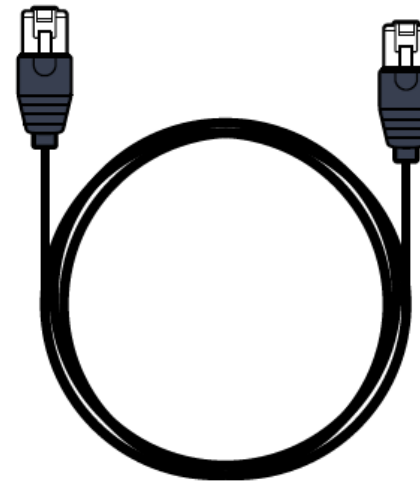

Cat5 Cable, 14 foot

Installation (1/4)

System Electronics

Your store will already have an **amplifier** installed as part of your current music system. This amplifier will continue to be used as part of your store's new music system.

In most stores, the player and amplifier will be located in the managers office on a shelf or in a network cabinet.

STEP
1

Locate your current player and amplifier. Turn volume knob down to zero.

Utilize the slack in cables on the back of the player to slide it out and rotate it around. Move the equipment very slowly, and carefully so that cables don't disconnect by mistake.

Please DO NOT remove any cables from the amplifier.

STEP
2

Disconnect the audio cable(s) from the back of your existing media player but **leave it connected to the back of the amplifier.**

Disconnect the network cable on the back of your existing music player but leave it connected to your network switch or ethernet wall jack.

Disconnect and remove the power cable from your existing media player.

IMPORTANT NOTE: The CURIOPlayer **X5 power supply is not compatible** with the CURIOPlayer Z8. Ensure you use the new power supply included with the CURIOPlayer Z8.



Installation (2/4)

STEP 3

Connect the supplied RCA Adapter cable to the **CURIOPlayer Z8** into the headphone jack on the back of the Z8 player. Next connect the existing audio cables from the amplifier to supplied RCA Adapter cable. Match the white RCA cable to the existing white RCA cable, repeat if there's an existing red RCA cable.

STEP 4

Next, place the network cable into the **CURIOPlayer Z8** network Cat5 port on the back of the player. The other end of the network cable should still be connected into the switch or ethernet wall jack.

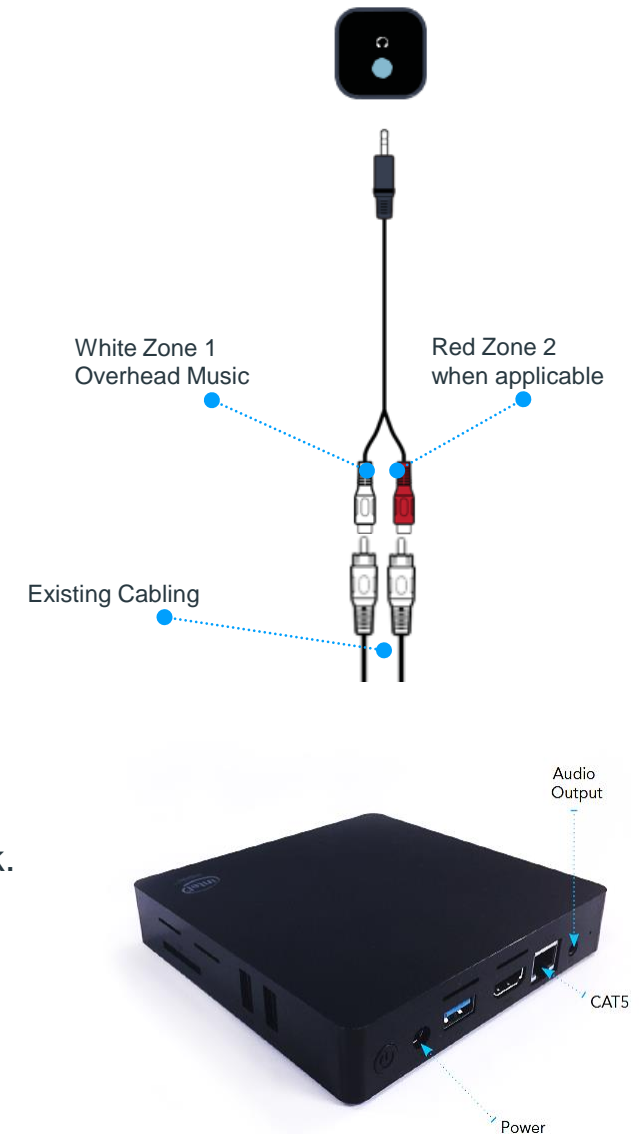

Installation (3/4)

STEP 5

Plug the power cable into the new **CURIOPlayer Z8**.

Plug the other end of the power cable into the existing surge protector or power outlet. A blue light will be illuminated on the front panel when the player is on.

The player will automatically power up and start playing music; this usually takes a couple of minutes.

If music doesn't begin playing within 2 minutes, power down the player using the power button for 10 secs. The player will power off and then press once again to turn the player back on.

NOTE: DO NOT remove power from the player without powering down the player first.

STEP 6

Attach the rubber feet shipped with the player. Rubber feet stabilize the player on a surface.

Place the Z8 where the previous media player was installed.

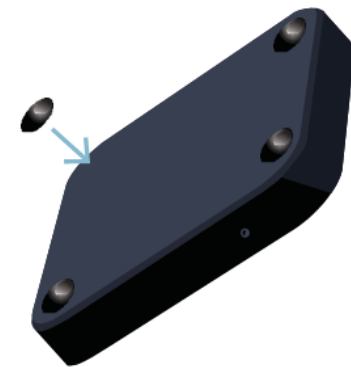

Installation (4/4)

STEP
7

Confirm network connectivity at <http://connectivity.apps.playnetwork.com>

MAC address is located on the bottom of the player. To check connectivity, enter the MAC address and then **click the magnifying glass button** to search.

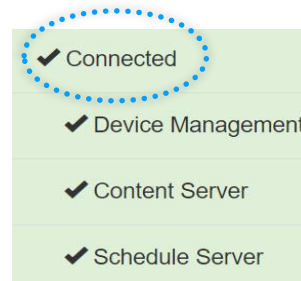

If player is *Not Connected*, please contact PlayNetwork customer service at +1 (888) 567-7529.

STEP
8

Contact the Installation Hotline at 1.866.477.0132 to leave a voicemail and confirm installation. Include your store name, store number, and the date of installation.

Congratulations and thank you! You have successfully completed your music installation!

Need further assistance with your install?

Contact PlayNetwork Customer Service:

1.888.567.7529 or customerservice@playnetwork.com

BRIGHTSIGN HD

AN UPDATED CLASSIC NOW WITH TRUE 4K. MAINSTREAM PERFORMANCE.

BrightSign HD models are ideal for mainstream 4Kp60, Full HD and HTML5 applications that require high reliability and ease of use. All models offer H.265 decoding, HTML5 rendering and Gigabit Ethernet. Robust interactive controls, live content features, BrightWall™ and Mosaic Mode make this set of players a perfect fit for a wide range of applications.



BrightSign HD224

Standard I/O Player

Enjoy flawless 4K and Full HD single video decoding, mainstream HTML5 performance and simultaneous playback from local, networked and streaming sources. Includes the standard I/O package of Gigabit Ethernet, GPIO, and analog/digital audio.

Price: \$350



BrightSign HD1024

Expanded I/O Player

All the features of the HD224 plus additional interactive options via USB 2.0 (type A), and serial ports to fully engage your audience.

Price: \$450

Features

- 
4K60p single decode
- 
Mainstream HTML5
- 
1080p60 single decode
- 
H.265
- 
HDR10 & HLG
- 
Mosaic Mode
- 
Entry-Level HTML5
- 
Digital Audio
- 
IP Streaming
- 
BrightBeacon™
- 
BrightWall™
- 
AutoWall™
- 
Zones
- 
Interactive
- 
Live Feeds
- 
Geo-Fencing
- 
Sign Preview
- 
Tagging
- 
BrightSign App
- 
Remote Snapshot
- 
Networking
- 
B-Deploy

SPECIFICATIONS

MODEL	HD224	HD1024
VIDEO ENGINE DECODER		
True 4K@60p video decoding	X	X
Single 4K or 1080p60 video decoding	X	X
MEDIA FORMATS		
Video Codecs for 4K content: H.265/H.264	X	X
Video Containers for 4K H.265/H.264 content: .ts, .mov, .mp4	X	X
Video Codecs for Full HD: H.265, H.264(MPEG-4, Part 10), MPEG-2, MPEG-1	X	X
Video Containers for Full HD: .ts, .mpg, .vob, .mov, .mp4, .m2ts	X	X
Images: BMP, JPEG, PNG	X	X
Audio: MP2, MP3, AAC, and WAV (AC3 is passed through)	X	X
HTML5	X (Mainstream)	
DISPLAY RESOLUTIONS		
4K resolutions: 4096x2160, 3840x2160, 3840x600	X	X
Upscaling to: 3840x2160x24/25/29.97/30p	X	X
1920x1200, 1920x1080x24/25/29.97/30/50/59.94/60p, 1920x1080x50/59.94/60i, 1600x1200x60p, 1440x1050x60/75p, 1440x900x60/75p, 1360x768x60p, 1280x1024x60/75p, 1280x960x60p, 1280x800x60p/75p, 1280x768x60p, 1280x720x50/59.94/60p, 1024x768x60p, 800x600x60/75p, 720x576x50p/50i, 720x480x59.94/60p/60i, 640x480x60p	X	X
HARDWARE INTERFACES		
External micro SD Slot (SDHC and SDXC); SDHC storage up to 32GB SDXC storage up to 2TB	X	X
USB High Speed Host Port (also supports content updates)		X (Type A)
12-pin Phoenix GPIO port with 8 bi-directional GPIOs	X	X
3.5mm RS-232 Serial Port		X
3.5mm IR In/Out	X	X
3.5mm Audio Out (analog -or- SPDIF digital, non-simultaneous)	X	X
HDMI 2.0a Out	X	X
Ethernet	X (Gigabit)	
M.2 (E) Keyed Wi-Fi/Bluetooth Connector	X	X
Wi-Fi External Antenna Connector (optional)	X	X
Status LEDs	Power, Error, Busy, Update	
Reset and Service Buttons	X	X
Real Time Clock	X	X
FEATURES		
H.265 Decoding: smaller file sizes and lower bitrates than H.264	X	X
HTML5: hardware-accelerated engine that plays modular HTML assets flawlessly alongside high-bandwidth video	X (Mainstream)	
BrightBeacon™: 2-way Bluetooth/Beacon communication between mobile devices & signage (requires: wireless/Bluetooth module)	X	X

MODEL	HD224	HD1024
BrightWall™: synchronized playback across multiple displays	X	X
AutoWall™: embraces the power of HTML5 to create unique multimedia video walls	X	X
Zones: playback multiple content types on a single screen	X	X
Mosaic Mode: simultaneously play a multitude of smaller resolution videos that add up to the maximum video resolution of the player	X	X
IP Streaming: play streaming media	X	X
Interactivity: connect virtually any type of interactive device to a multitude of interactive ports	X (GPIO, UDP)	X (GPIO, USB, serial, UDP)
Live Feeds: Live Data, Live Text, MRSS, Twitter, Flickr, etc.	X	X
Tagging: BrightSign Network users can assign media and player tags for highly targeted content distribution	X	X
BrightSign App: update signs with an iOS device	X	X
Geo-Fencing: trigger playback based on location (requires USB dongle)		X
Sign Preview: preview presentation playback in BrightAuthor	X	X
Remote Snapshot: remotely view a snapshot image of the display's playback	X	X
Networking: update, manage and schedule your signage	X	X
B-deploy: A setup feature to deploy many players at once	X	X
Extended Thermal: sustained ambient temperatures between -20°C and 50°C with transients up to 70°C at 90% max relative humidity, non-condensing	X	X
SOFTWARE		
Free BrightAuthor Software	X	X
BrightSign Networking Options	X	X
ACCESSORIES		
USB Button Pads		X
Wireless/Bluetooth Module	X	X
MicroSD Class 10 Cards (various capacities)	X	X
MISCELLANEOUS		
Dimensions (W x H x D)	159.9 x 22 x 144.2mm or 6.3 x 0.87 x 5.7 in	
Weight	12 oz	
Power	12V / 1.5A (18 Watts)	
Multi-Country Power & Regulatory Approvals	X	X
Built-in Wall Mounting Brackets	X	X
1 year warranty, parts and labor	X	X